



Special Rates when you book by July 31, 2019

RIVER CRUISE FOR WINE LOVERS

Amphora Winery

Aboard The AmaSonata • 7 Nights • November 13 to 20, 2020

Budapest • Vienna • Krems • Weissenkirchen • Ybbs • Grein • Linz • Passau • Vilshofen

Note: Stateroom layouts shown below are not to scale.



Suite, Violin Deck
French Balcony & Outside Balcony, 350 sq. ft.

Brochure Fare \$6,598 pp
Your rate \$6,348 pp

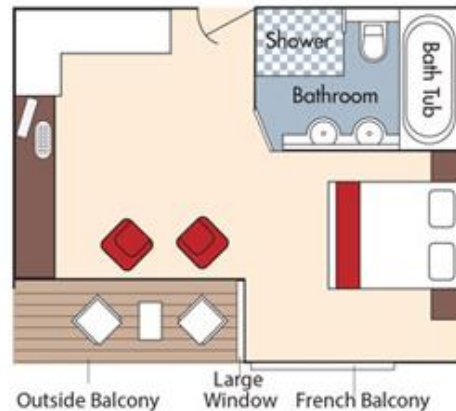

CAT. AA, Violin Deck
French Balcony & Outside Balcony, 235 sq. ft.

Brochure Fare \$5,298 pp
Your rate \$5,048 pp

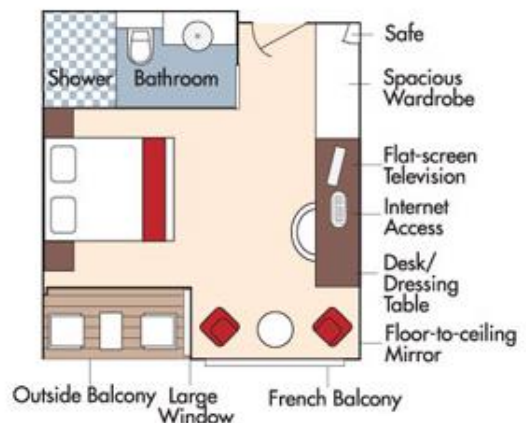

Fares listed are cruise-only, per person based on double occupancy and do not include port charges of \$189 per person.



CAT. AB, Cello Deck
French Balcony & Outside Balcony, 235 sq. ft.

Brochure Fare \$5,098 pp
Your rate \$4,848 pp

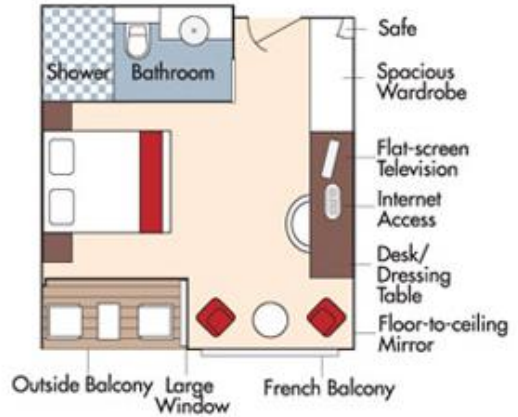

CAT. BA, Violin Deck
French Balcony & Outside Balcony, 210 sq. ft.

Brochure Fare \$4,898 pp
Your rate \$4,648 pp

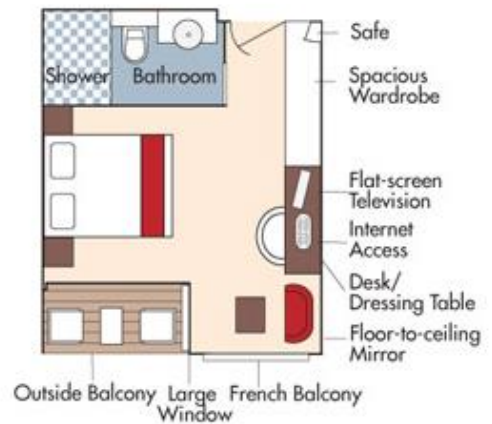



CAT. BB, Cello Deck
French Balcony & Outside Balcony, 210 sq. ft.

Brochure Fare \$4,698 pp
Your rate \$4,448 pp

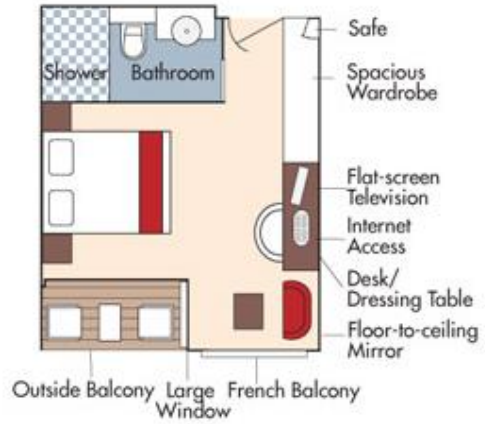

CAT. C, Violin & Cello Deck
French Balcony, 170 sq. ft.

Category C
Brochure Fare \$4,198 pp
Your rate \$3,948 pp

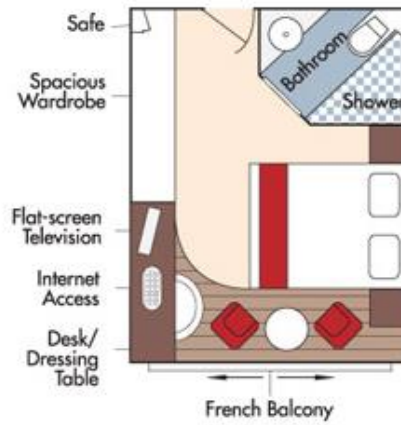



CAT. D, Piano Deck
Fixed Windows, 160 sq. ft.

Brochure Fare **\$3,498 pp**
Your rate **\$3,248 pp**

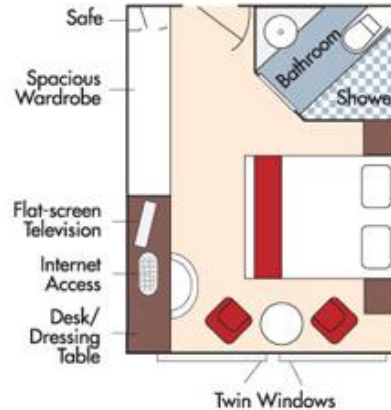

CAT. E, Piano Deck
Fixed Windows, 160 sq. ft.

Brochure Fare **\$3,199 pp**
Your rate **\$2,949 pp**

AmaSonata Deck Plan

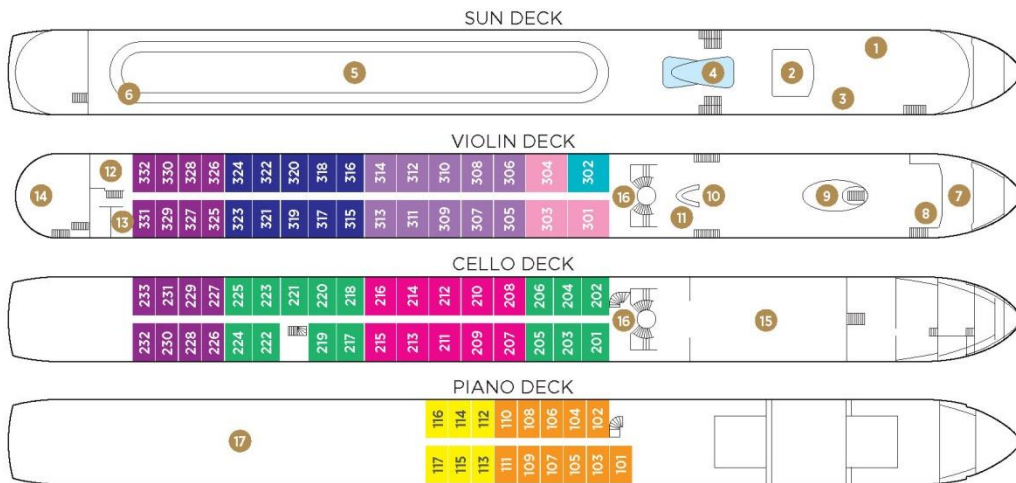

- 1 Lower Sun Deck
- 2 Navigation Bridge
- 3 Bicycles
- 4 Heated Pool
- 5 Sun Deck
- 6 Walking Track
- 7 Al Fresco Dining Terrace
- 8 Observation Lounge
- 9 Main Lounge & Bar
- 10 Gift Shop
- 11 Reception
- 12 Fitness Room
- 13 Massage & Hair Salon
- 14 The Chef's Table Restaurant
- 15 Main Restaurant
- 16 Elevator
- 17 Crew Cabins

Elevator reaches Main Restaurant, Lobby/Main Lounge and staterooms on Violin and Cello Deck.

| | | | |
|-----------------|--|----------------|---|
| Suite | Violin Deck / French & Outside Balcony - 300 sq. ft. | Cat. BB | Cello Deck / French & Outside Balcony - 210 sq. ft. |
| Cat. AA+ | Violin Deck / French & Outside Balcony - 290 sq. ft. | Cat. C | Violin & Cello Deck / French Balcony - 170 sq. ft. |
| Cat. AA | Violin Deck / French & Outside Balcony - 235 sq. ft. | Cat. D | Piano Deck / Fixed Windows - 160 sq. ft. |
| Cat. AB | Cello Deck / French & Outside Balcony - 235 sq. ft. | Cat. E | Piano Deck / Fixed Windows - 160 sq. ft. |
| Cat. BA | Violin Deck / French & Outside Balcony - 210 sq. ft. | | |

Cat. AA+ slightly modified (i.e. no bathrub); refer to website for floorplan

Fares listed are cruise-only, per person based on double occupancy and do not include port charges of \$189 per person.