



Special Rates when you book by July 31, 2019

# RIVER CRUISE FOR WINE LOVERS

## Russian River Valley Winegrowers

Aboard the AmaStella • 7 Nights • March 30 to April 6, 2020

Basel • Breisach • Strasbourg • Ludwigshafen • Rudesheim • Lahnstein • Cologne • Amsterdam

Note: Stateroom layouts shown below are not to scale.



Suite, Violin Deck  
French Balcony & Outside Balcony, 350 sq. ft.

Brochure Fare ~~\$6,298~~ pp  
Your rate \$6,048 pp

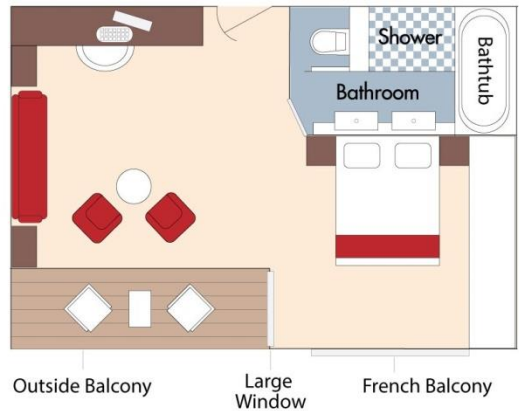

CAT. AA, Violin Deck  
French Balcony & Outside Balcony, 235 sq. ft.

Brochure Fare ~~\$4,998~~ pp  
Your rate \$4,748 pp

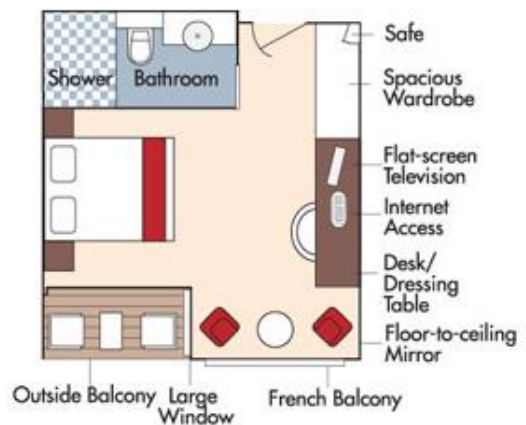

Fares listed are cruise-only, per person based on double occupancy and do not include port charges of \$189 per person.



**CAT. AB, Cello Deck**  
**French Balcony & Outside Balcony, 235 sq. ft.**

**Brochure Fare \$4,798 pp**  
**Your rate \$4,548 pp**

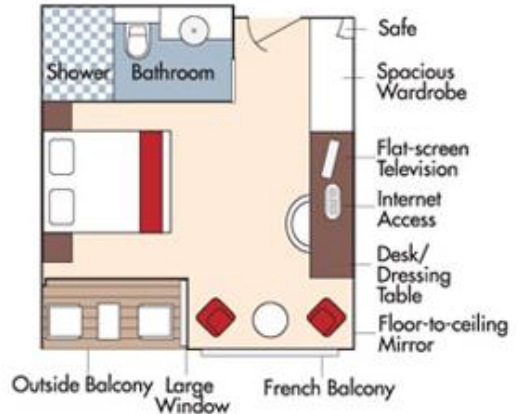

**CAT. BA, Violin Deck**  
**French Balcony & Outside Balcony, 210 sq. ft.**

**Brochure Fare \$4,598 pp**  
**Your rate \$4,348 pp**

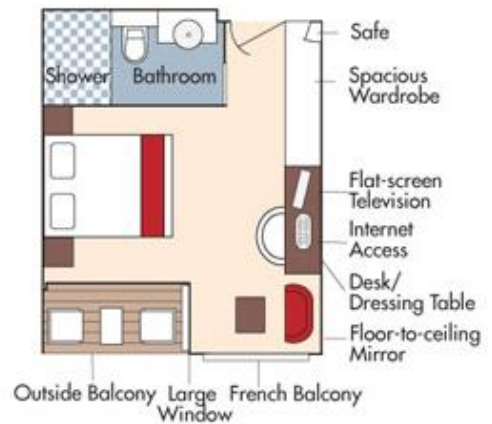



**CAT. BB, Cello Deck**  
**French Balcony & Outside Balcony, 210 sq. ft.**

**Brochure Fare \$4,398 pp**  
**Your rate \$4,148 pp**

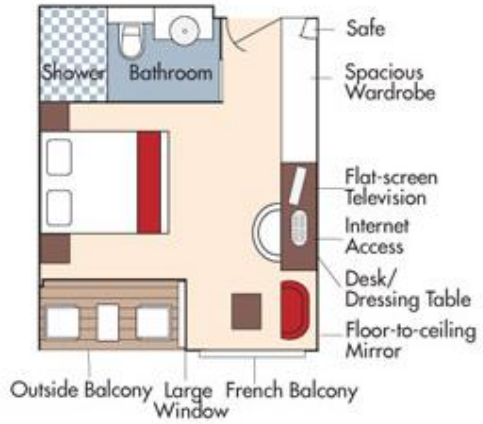

**CAT. C, Violin & Cello Deck**  
**French Balcony, 170 sq. ft.**

**Category CA**  
**Brochure Fare \$3,898 pp**  
**Your rate \$3,648 pp**

**Category CB**  
**Brochure Fare \$3,598 pp**  
**Your rate \$3,348 pp**

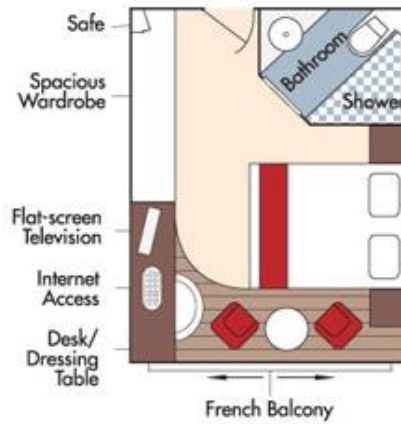





**CAT. D, Piano Deck**  
Fixed Windows, 160 sq. ft.

Brochure Fare **\$3,498 pp**  
Your rate **\$2,948 pp**

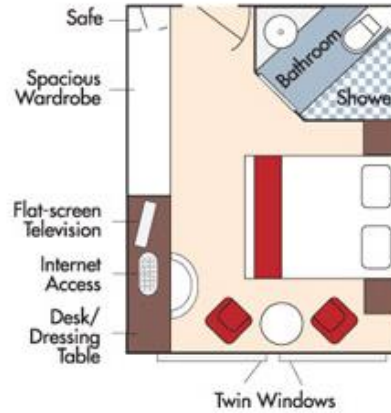

**CAT. E, Piano Deck**  
Fixed Windows, 160 sq. ft.

Brochure Fare **\$2,899 pp**  
Your rate **\$2,649 pp**

### AmaStella Deck Plan

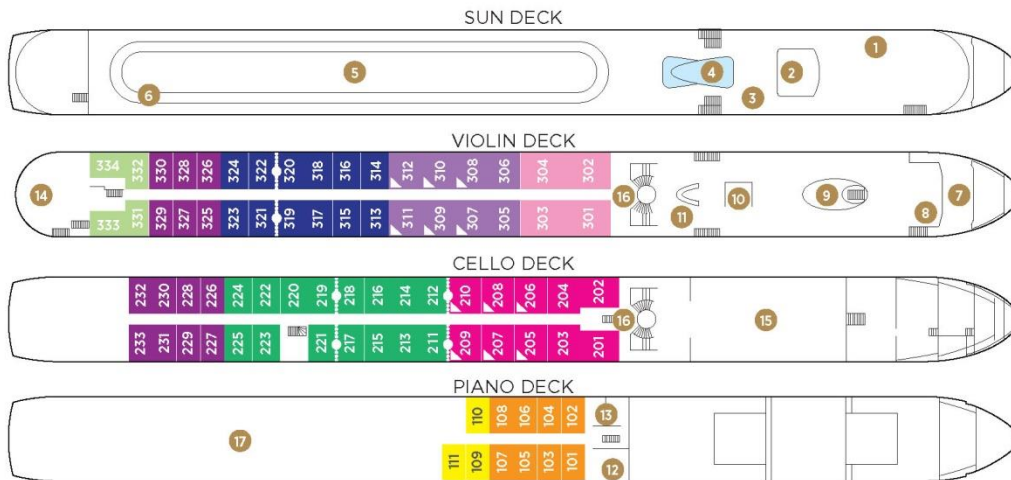

- 1 Lower Sun Deck
- 2 Navigation Bridge
- 3 Bicycles
- 4 Heated Pool
- 5 Sun Deck
- 6 Walking Track
- 7 *Al Fresco* Dining Terrace
- 8 Observation Lounge
- 9 Main Lounge & Bar
- 10 Gift Shop
- 11 Reception
- 12 Fitness Room
- 13 Massage & Hair Salon
- 14 The Chef's Table Restaurant
- 15 Main Restaurant
- 16 Elevator
- 17 Crew Cabins

*Elevator on AmaLea and AmaKristina reaches Main Restaurant, Lobby/Main Lounge and staterooms on Violin, Cello and Piano Deck.  
Elevator on AmaStella and AmaViola reaches Main Restaurant, Lobby/Main Lounge and staterooms on Violin and Cello Deck.*

Suite	Violin Deck / French & Outside Balcony - 350 sq. ft.	Cat. CA	Violin & Cello Deck / French Balcony - 170 sq. ft.
Cat. AA	Violin Deck / French & Outside Balcony - 235 sq. ft.	Cat. CB	Violin Deck / French Balcony - 155 sq. ft.
Cat. AB	Cello Deck / French & Outside Balcony - 235 sq. ft.	Cat. D	Piano Deck / Fixed Windows - 160 sq. ft.
Cat. BA	Violin Deck / French & Outside Balcony - 210 sq. ft.	Cat. E	Piano Deck / Fixed Windows - 160 sq. ft.
Cat. BB	Cello Deck / French & Outside Balcony - 210 sq. ft.		

••••• Staterooms can become adjoining by request.   ▲ Up to triple occupancy.

*Fares listed are cruise-only, per person based on double occupancy and do not include port charges of \$189 per person.*