



Special Rates when you book by July 31, 2019

RIVER CRUISE FOR WINE LOVERS

Laurel Ridge Winery

Aboard the AmaSerena • 7 Nights • November 13 - 20, 2020
Vilshofen • Passau • Linz • Wachau Valley • Weissenkirchen • Krems • Vienna • Budapest

Note: Stateroom layouts shown below are not to scale.

Suite, Violin Deck
French Balcony & Outside Balcony, 300 sq. ft.

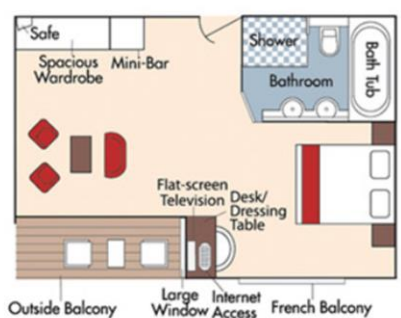
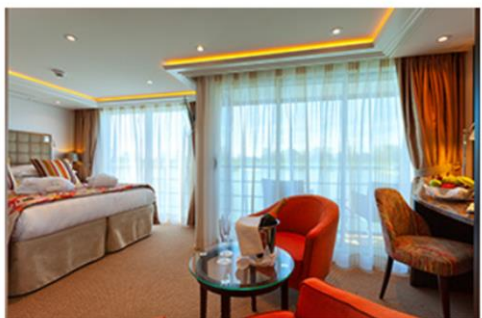

Brochure Fare: ~~\$6,598~~ pp
Your Rate: \$5,598 pp

CAT. AA, Violin Deck
French Balcony & Outside Balcony, 235 sq. ft.

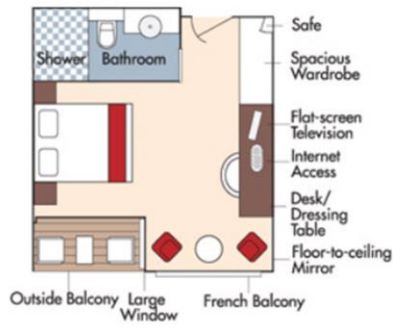

Brochure Fare: ~~\$5,298~~ pp
Your Rate: \$4,298 pp

Fares listed are cruise-only, per person based on double occupancy and do not include port charges of \$189 per person.

CAT. AB, Cello Deck
French Balcony & Outside Balcony, 235 sq. ft.

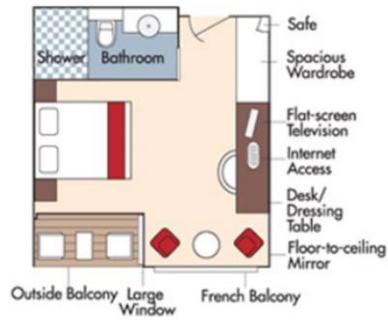

Brochure Fare: ~~\$5,098~~ pp
Your Rate: \$4,098 pp

CAT. BA, Violin Deck
French Balcony & Outside Balcony, 210 sq. ft.

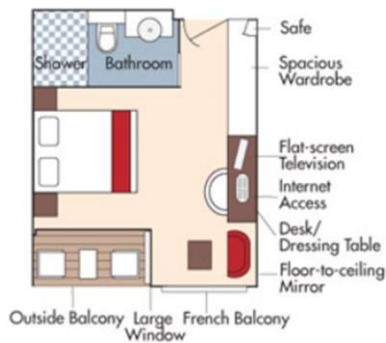

Brochure Fare: ~~\$4,898~~ pp
Your Rate: \$3,898 pp

CAT. BB, Cello Deck
French Balcony & Outside Balcony, 210 sq. ft.

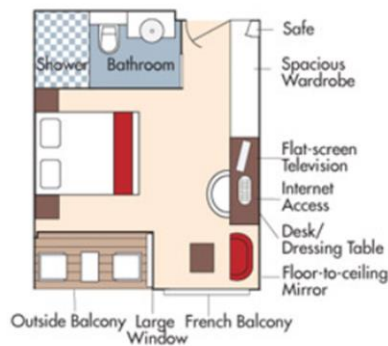

Brochure Fare: ~~\$4,698~~ pp
Your Rate: \$3,698 pp

CAT. C, Violin & Cello Deck
 French Balcony, 170 sq. ft.

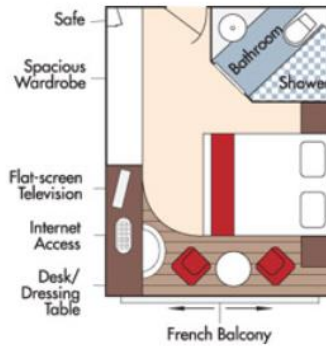

Brochure Fare: ~~\$4,198~~ pp
 Your Rate: **\$3,198 pp**

CAT. D, Piano Deck
 Fixed Windows, 160 sq. ft.



CAT. E, Piano Deck
 Fixed Windows, 160 sq. ft.

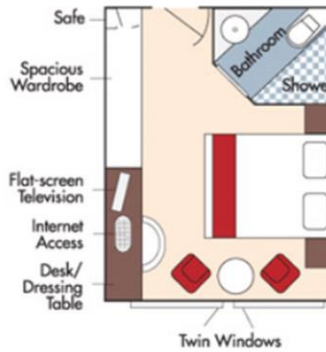

Category D
 Brochure Fare: ~~\$3,498~~ pp
 Your Rate: **\$2,498 pp**

Category E
 Brochure Fare: ~~\$3,199~~ pp
 Your Rate: **\$2,199 pp**

AmaSerena Deck Plan

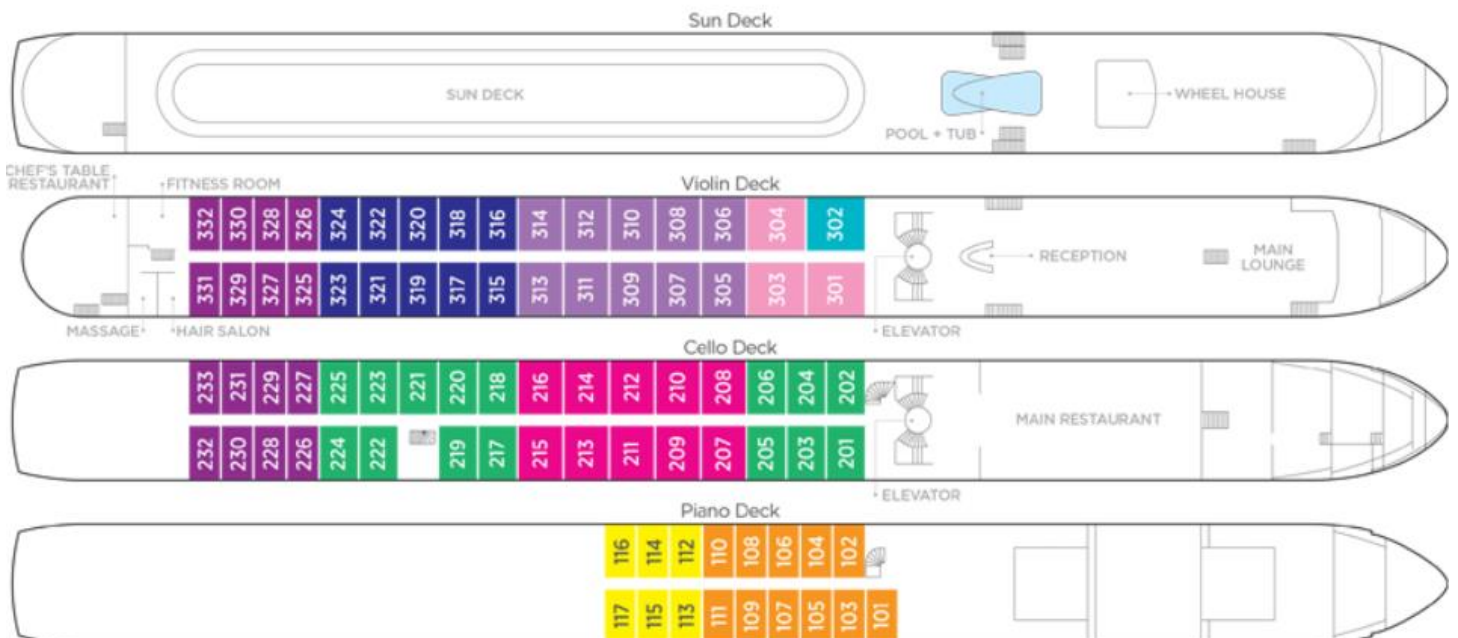

Fares listed are cruise-only, per person based on double occupancy and do not include port charges of \$189 per person.