



Special Rates when you book by Sep 30, 2019

# RIVER CRUISE FOR WINE LOVERS

## Amphora Winery

Aboard The AmaSonata • 7 Nights • November 13 to 20, 2020

Budapest • Vienna • Krems • Weissenkirchen • Ybbs • Grein • Linz • Passau • Vilshofen

Note: Stateroom layouts shown below are not to scale.



Suite, Violin Deck  
French Balcony & Outside Balcony, 350 sq. ft.

Brochure Fare \$6,598 pp  
Your rate \$6,348 pp

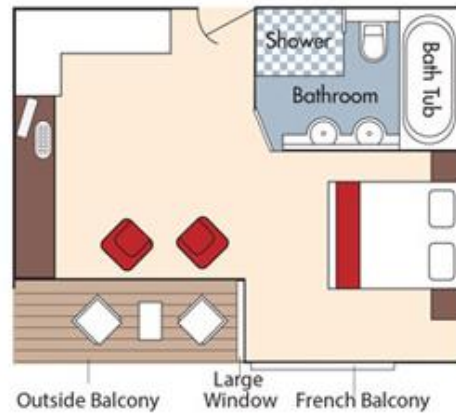

CAT. AA, Violin Deck  
French Balcony & Outside Balcony, 235 sq. ft.

Brochure Fare \$5,298 pp  
Your rate \$5,048 pp

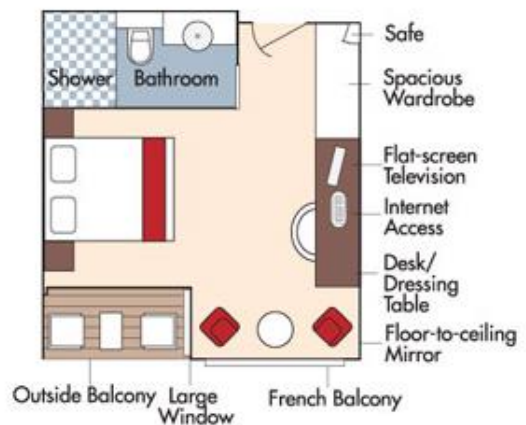

Fares listed are cruise-only, per person based on double occupancy and do not include port charges of \$189 per person.



**CAT. AB, Cello Deck**  
**French Balcony & Outside Balcony, 235 sq. ft.**

**Brochure Fare \$5,098 pp**  
**Your rate \$4,848 pp**

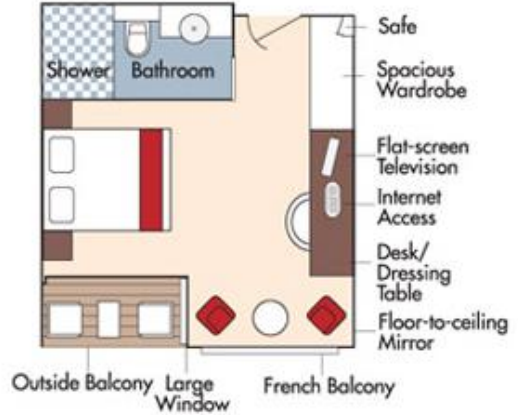

**CAT. BA, Violin Deck**  
**French Balcony & Outside Balcony, 210 sq. ft.**

**Brochure Fare \$4,898 pp**  
**Your rate \$4,648 pp**

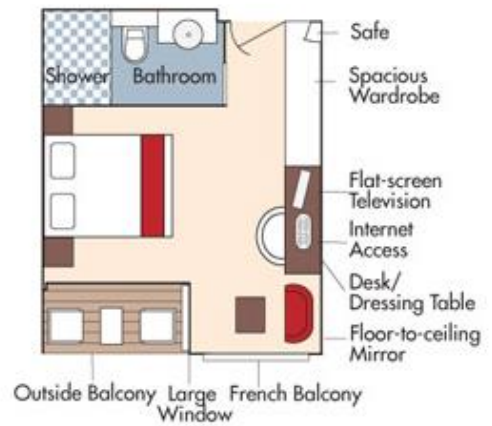



**CAT. BB, Cello Deck**  
**French Balcony & Outside Balcony, 210 sq. ft.**

**Brochure Fare \$4,698 pp**  
**Your rate \$4,448 pp**

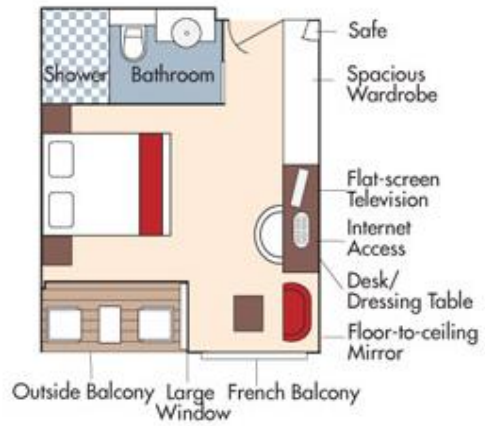

**CAT. C, Violin & Cello Deck**  
**French Balcony, 170 sq. ft.**

**Category C**  
**Brochure Fare \$4,198 pp**  
**Your rate \$3,948 pp**

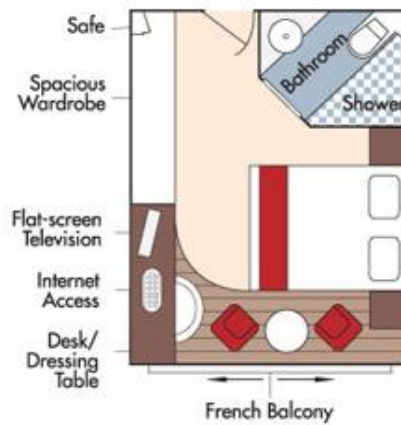





**CAT. D, Piano Deck**  
Fixed Windows, 160 sq. ft.

Brochure Fare **\$3,498 pp**  
Your rate **\$3,248 pp**

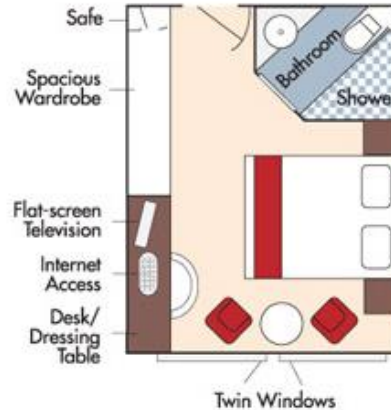

**CAT. E, Piano Deck**  
Fixed Windows, 160 sq. ft.

Brochure Fare **\$3,199 pp**  
Your rate **\$2,949 pp**

## AmaSonata Deck Plan

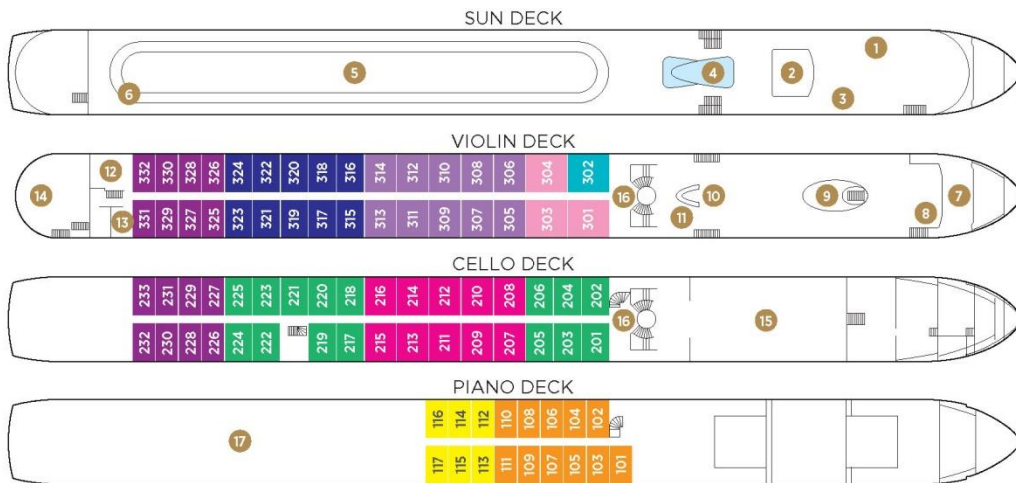

- 1 Lower Sun Deck
- 2 Navigation Bridge
- 3 Bicycles
- 4 Heated Pool
- 5 Sun Deck
- 6 Walking Track
- 7 Al Fresco Dining Terrace
- 8 Observation Lounge
- 9 Main Lounge & Bar
- 10 Gift Shop
- 11 Reception
- 12 Fitness Room
- 13 Massage & Hair Salon
- 14 The Chef's Table Restaurant
- 15 Main Restaurant
- 16 Elevator
- 17 Crew Cabins

*Elevator reaches Main Restaurant, Lobby/Main Lounge and staterooms on Violin and Cello Deck.*

<b>Suite</b>	Violin Deck / French & Outside Balcony - 300 sq. ft.	<b>Cat. BB</b>	Cello Deck / French & Outside Balcony - 210 sq. ft.
<b>Cat. AA+</b>	Violin Deck / French & Outside Balcony - 290 sq. ft.	<b>Cat. C</b>	Violin & Cello Deck / French Balcony - 170 sq. ft.
<b>Cat. AA</b>	Violin Deck / French & Outside Balcony - 235 sq. ft.	<b>Cat. D</b>	Piano Deck / Fixed Windows - 160 sq. ft.
<b>Cat. AB</b>	Cello Deck / French & Outside Balcony - 235 sq. ft.	<b>Cat. E</b>	Piano Deck / Fixed Windows - 160 sq. ft.
<b>Cat. BA</b>	Violin Deck / French & Outside Balcony - 210 sq. ft.		

*Cat. AA+ slightly modified (i.e. no bathrub); refer to website for floorplan*

*Fares listed are cruise-only, per person based on double occupancy and do not include port charges of \$189 per person.*