



Special Rates when you book by Sep 30, 2019

# RIVER CRUISE FOR WINE LOVERS

## Kessler-Haak Wine Cruise

Aboard the AmaDante • 7 Nights • July 30 to August 6, 2020

Basel • Strasbourg • Ludwigshafen • Rudesheim • Miltenberg • Wertheim • Kitzingen • Volkach • Bamberg • Nuremberg



Suite, Violin Deck  
French Balcony, 255 sq. ft.

Note: Stateroom layouts shown below are not to scale.



Brochure Fare: ~~\$6,198~~ pp  
Your Rate: \$5,948 pp



CAT. A+, Violin Deck  
French Balcony, 225 sq. ft.

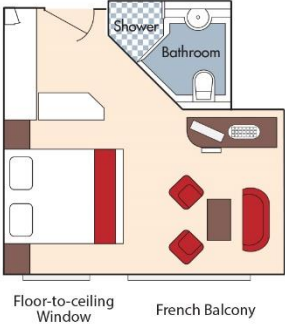

Brochure Fare: ~~\$5,998~~ pp  
Your Rate: \$5,748 pp



CAT. A, Violin Deck  
French Balcony, 170 sq. ft.

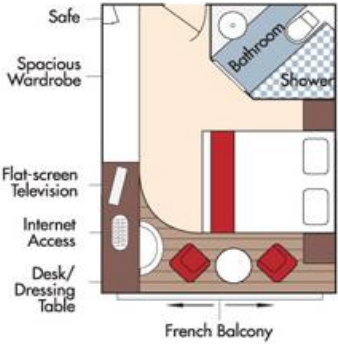

Brochure Fare: ~~\$4,998~~ pp  
Your Rate: \$4,748 pp

Fares listed are cruise-only, per person based on double occupancy and do not include port charges of \$189 USD per person.

CAT. B, Violin & Cello Deck  
French Balcony, 170 sq. ft.

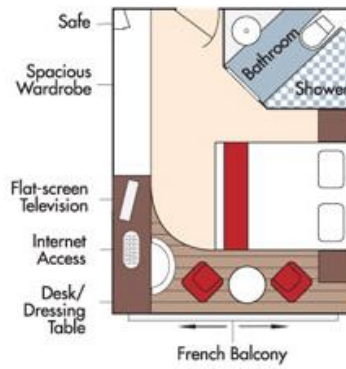

Brochure Fare: ~~\$4,898~~ pp  
Your Rate: \$4,648 pp

CAT. C, Violin & Cello Deck  
French Balcony, 170 sq. ft.

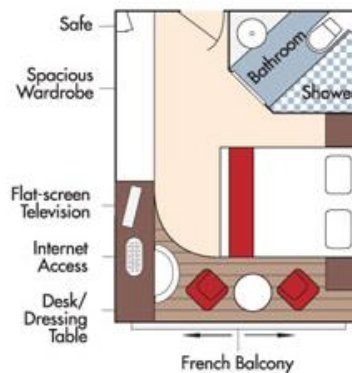

Brochure Fare: ~~\$4,698~~ pp  
Your Rate: \$4,448 pp

CAT. E, Piano Deck  
Fixed Windows, 170 sq. ft.



CAT. D, Piano Deck  
Fixed Windows, 170 sq. ft.

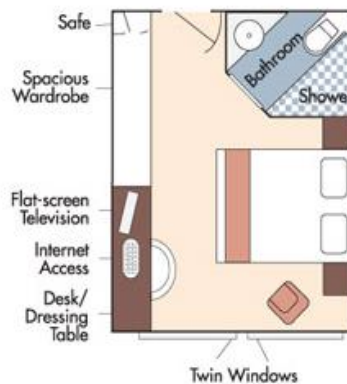

Category D  
Brochure Fare: ~~\$3,998~~ pp  
Your Rate: \$3,748 pp

Category E  
Brochure Fare: ~~\$3,699~~ pp  
Your Rate: \$3,449 pp

## AmaDante DECK PLAN

1	Observation Deck
2	Navigation Bridge
3	Bicycles
4	Whirlpool
5	Sun Deck
6	Walking Track
7	Bow Seating Area
8	Main Lounge & Bar
9	Gift Shop
10	Reception
11	Massage & Hair Salon
12	The Chef's Table Restaurant
13	Fitness Room
14	Main Restaurant
15	Elevator
16	Crew Cabins

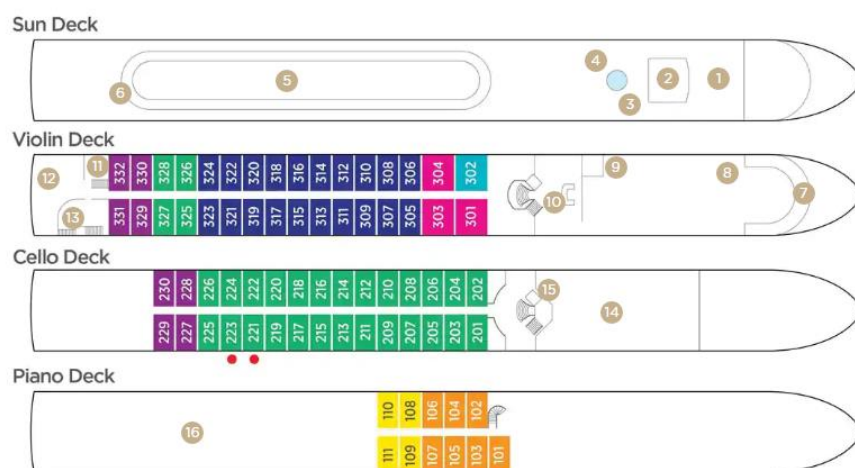

Note: Elevator reaches Main Restaurant, Lobby/Main Lounge and staterooms on Violin and Cello Deck (does not reach Piano Deck or Sun Deck).

Stateroom Categories



Fares listed are cruise-only, per person based on double occupancy and do not include port charges of \$189 USD per person.