



Special Rates when you book by Nov 30, 2019

# RIVER CRUISE FOR WINE LOVERS

## Abacela Vineyards & Winery

Aboard the AmaCerto • 7 Nights • March 22 to 29, 2020

Budapest • Mohács • Vukovar • Ilok • Novi Sad • Belgrade

• Iron Gates • Vidin • Rousse • Veliko Tarnovo • Giurgiu

Note: Stateroom layouts shown below are not to scale.



Suite, Violin Deck  
French Balcony & Outside Balcony, 350 sq. ft.

Brochure Fare \$6,198 pp

Your rate \$5,948 pp

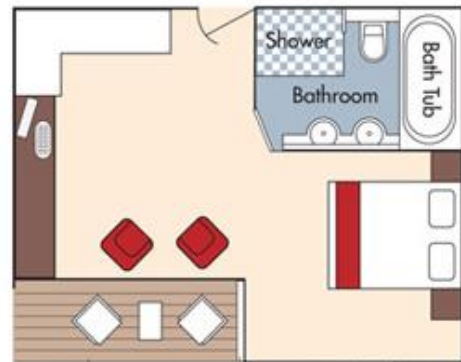

Outside Balcony Large Window French Balcony



CAT. AA, Violin Deck  
French Balcony & Outside Balcony, 235 sq. ft.

Brochure Fare \$4,898 pp

Your rate \$4,648 pp



Outside Balcony Large Window French Balcony

Fares listed are cruise-only, per person based on double occupancy and do not include port charges of \$189 per person.



**CAT. AB, Cello Deck**  
**French Balcony & Outside Balcony, 235 sq. ft.**

**Brochure Fare \$4,698 pp**  
**Your rate \$4,448 pp**

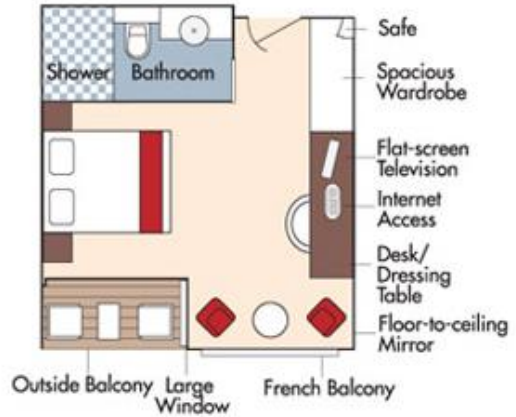

**CAT. BA, Violin Deck**  
**French Balcony & Outside Balcony, 210 sq. ft.**

**Brochure Fare \$4,498 pp**  
**Your rate \$4,248 pp**

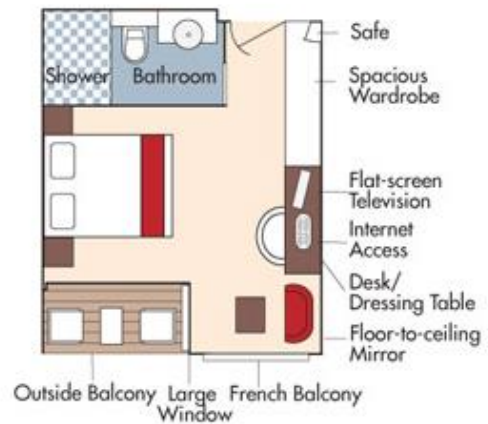



**CAT. BB, Cello Deck**  
**French Balcony & Outside Balcony, 210 sq. ft.**

**Brochure Fare \$4,298 pp**  
**Your rate \$4,048 pp**

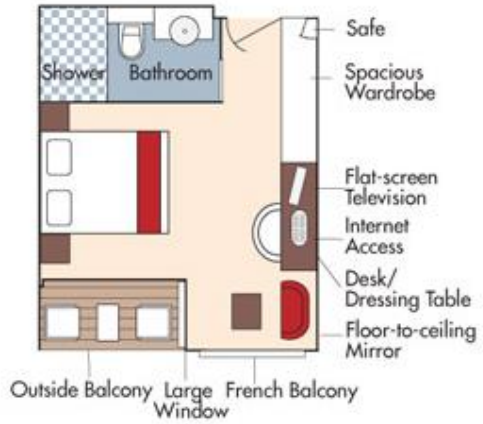

**CAT. C, Violin & Cello Deck**  
**French Balcony, 170 sq. ft.**

**Category C**  
**Brochure Fare \$3,798 pp**  
**Your rate \$3,548 pp**

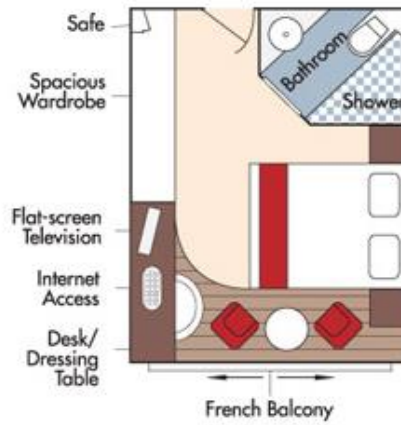



**CAT. D, Piano Deck**  
Fixed Windows, 160 sq. ft.

Brochure Fare **\$3,098 pp**  
Your rate **\$2,848 pp**

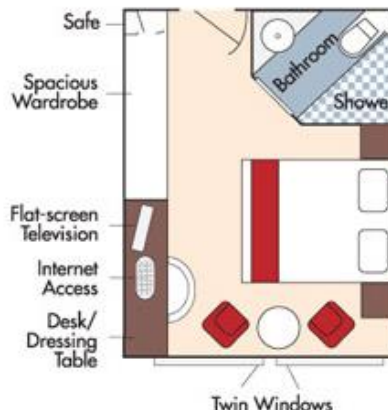

**CAT. E, Piano Deck**  
Fixed Windows, 160 sq. ft.

Brochure Fare **\$2,799 pp**  
Your rate **\$2,549 pp**

### AmaCerto Deck Plan

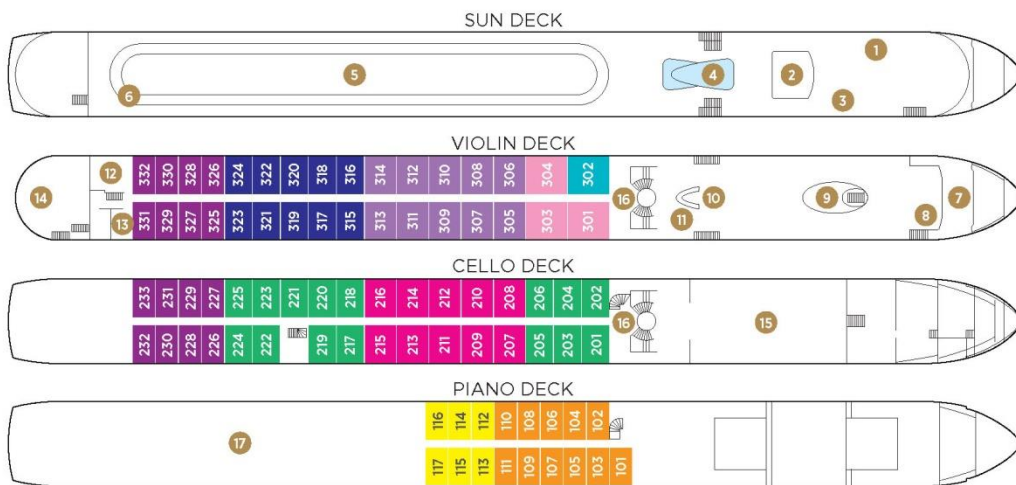

- 1 Lower Sun Deck
- 2 Navigation Bridge
- 3 Bicycles
- 4 Heated Pool
- 5 Sun Deck
- 6 Walking Track
- 7 Al Fresco Dining Terrace
- 8 Observation Lounge
- 9 Main Lounge & Bar
- 10 Gift Shop
- 11 Reception
- 12 Fitness Room
- 13 Massage & Hair Salon
- 14 The Chef's Table Restaurant
- 15 Main Restaurant
- 16 Elevator
- 17 Crew Cabins

*Elevator reaches Main Restaurant, Lobby/Main Lounge and staterooms on Violin and Cello Deck.*

|          |                                                      |         |                                                     |
|----------|------------------------------------------------------|---------|-----------------------------------------------------|
| Suite    | Violin Deck / French & Outside Balcony - 300 sq. ft. | Cat. BB | Cello Deck / French & Outside Balcony - 210 sq. ft. |
| Cat. AA+ | Violin Deck / French & Outside Balcony - 290 sq. ft. | Cat. C  | Violin & Cello Deck / French Balcony - 170 sq. ft.  |
| Cat. AA  | Violin Deck / French & Outside Balcony - 235 sq. ft. | Cat. D  | Piano Deck / Fixed Windows - 160 sq. ft.            |
| Cat. AB  | Cello Deck / French & Outside Balcony - 235 sq. ft.  | Cat. E  | Piano Deck / Fixed Windows - 160 sq. ft.            |
| Cat. BA  | Violin Deck / French & Outside Balcony - 210 sq. ft. |         |                                                     |

*Cat. AA+ slightly modified (i.e. no bathrub); refer to website for floorplan*

*Fares listed are cruise-only, per person based on double occupancy and do not include port charges of \$189 per person.*