

RHINE CASTLES & SWISS ALPS WITH THE AMERICAN WINE SOCIETY

Aboard the AmaMora • 7 Nights • April 8 to 15, 2021

Basel • Strasbourg • Ludwigshafen • Rudesheim • Rhine Gorge • Cologne • Amsterdam

Note: Stateroom layouts shown below are not to scale.



Suite, Violin Deck
French Balcony & Outside Balcony, 350 sq. ft.

Brochure Fare ~~\$6,798~~ pp

Your rate **\$6,548** pp

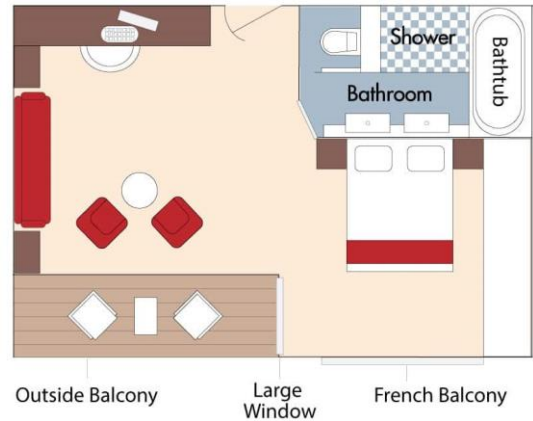

CAT. AA, Violin Deck
French Balcony & Outside Balcony, 235 sq. ft.

Brochure Fare ~~\$5,398~~ pp

Your rate **\$5,148** pp

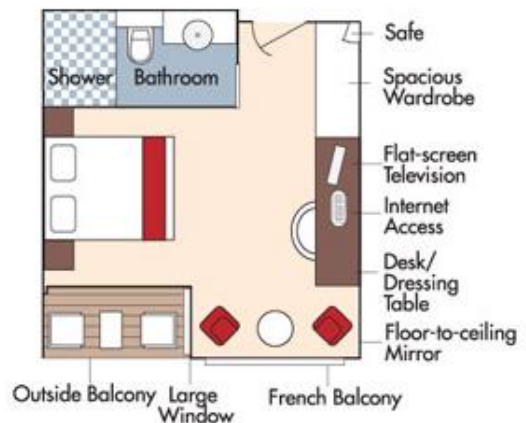

Fares listed are cruise-only, per person based on double occupancy and do not include port charges of \$196 per person.



CAT. AB, Cello Deck
French Balcony & Outside Balcony, 235 sq. ft.

Brochure Fare \$5,198 pp
Your rate \$4,948 pp

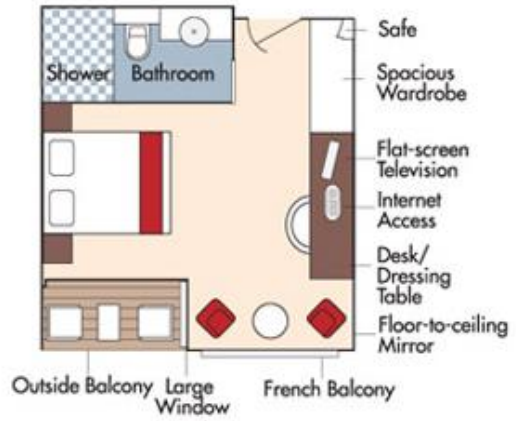

CAT. BA, Violin Deck
French Balcony & Outside Balcony, 210 sq. ft.

Brochure Fare \$4,998 pp
Your rate \$4,748 pp

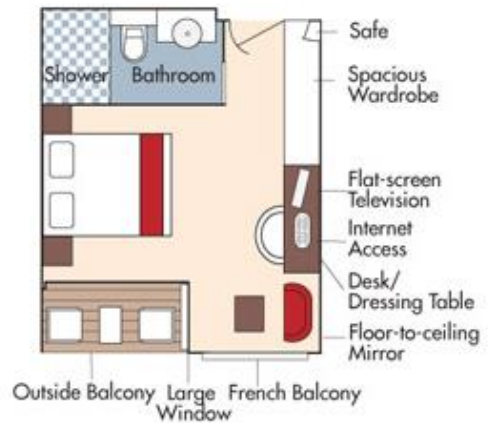



CAT. BB, Cello Deck
 French Balcony & Outside Balcony, 210 sq. ft.

Brochure Fare \$4,798 pp
 Your rate \$4,548 pp

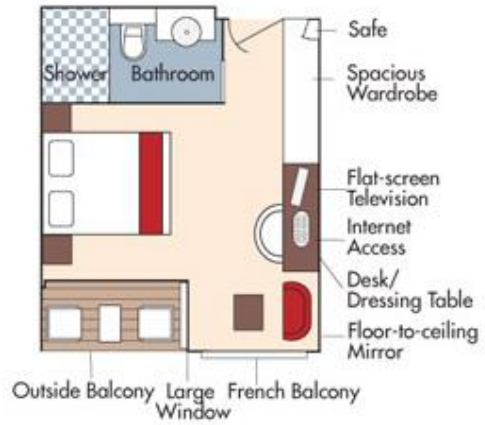

CAT. C, Violin & Cello Deck
 French Balcony

Category CA 170 sq. ft.
 Brochure Fare \$4,198 pp
 Your rate \$3,948 pp

Category CB 155 sq. ft.
 Brochure Fare \$3,898 pp
 Your rate \$3,648 pp

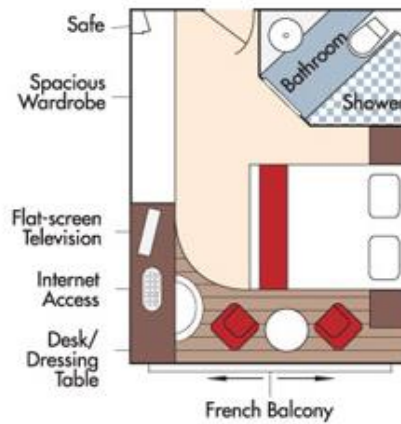



CAT. D, Piano Deck
Fixed Windows, 160 sq. ft.

Brochure Fare **\$3,498 pp**
Your rate **\$3,248 pp**

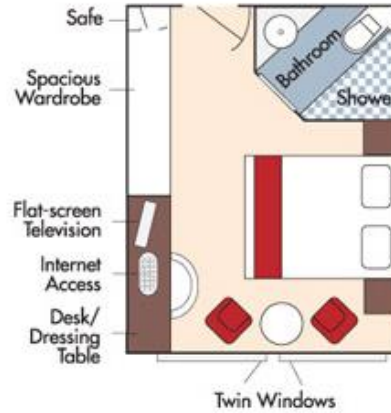

CAT. E, Piano Deck
Fixed Windows, 160 sq. ft.

Brochure Fare **\$3,199 pp**
Your rate **\$2,949 pp**

AmaMora Deck Plan

- 1 Lower Sun Deck
- 2 Navigation Bridge
- 3 Bicycles
- 4 Heated Pool
- 5 Sun Deck
- 6 Walking Track
- 7 Al Fresco Terrace
- 8 Observation Lounge
- 9 Main Lounge & Bar
- 10 Gift Shop
- 11 Reception
- 12 The Chef's Table Restaurant
- 13 Main Restaurant
- 14 Elevator
- 15 Massage & Hair Salon
- 16 Fitness Room
- 17 Crew Cabins

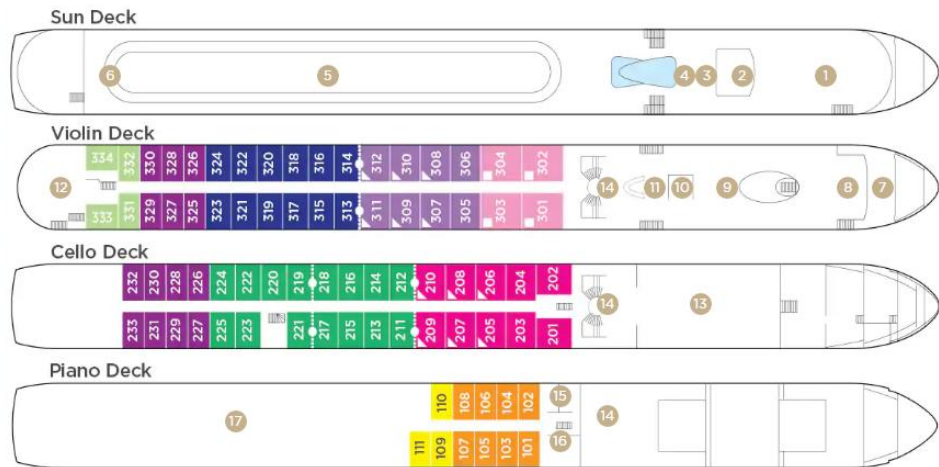

Note: Elevator reaches the Violin, Cello and Piano Deck (does not reach the Sun Deck).

Staterooms can become adjoining by request.

Up to triple occupancy

Stateroom Categories



Fares listed are cruise-only, per person based on double occupancy and do not include port charges of \$196 per person.