



Special Rates when you book by Jan 31, 2020

RIVER CRUISE FOR WINE LOVERS

Petaluma Gap Winegrowers Alliance

Aboard the AmaViola • 7 Nights • April 6 to 13, 2020

Budapest • Vienna • Krems • Weissenkirchen • Ybbs • Grein • Linz • Passau • Vilshofen

Note: Stateroom layouts shown below are not to scale.



Suite, Violin Deck
French Balcony & Outside Balcony, 350 sq. ft.

Brochure Fare ~~\$6,398~~ pp
Your rate \$6,148 pp

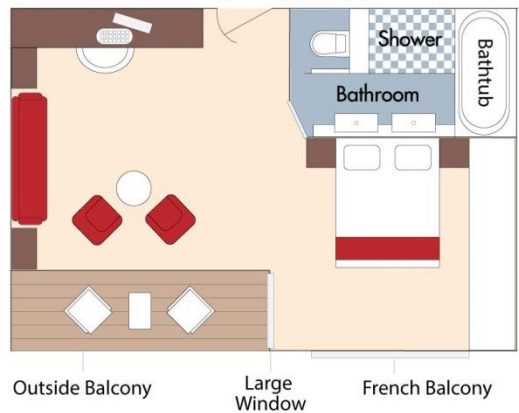

CAT. AA, Violin Deck
French Balcony & Outside Balcony, 235 sq. ft.

Brochure Fare ~~\$5,098~~ pp
Your rate \$4,848 pp

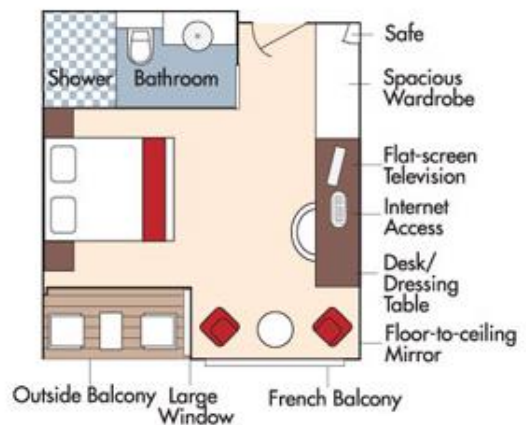

Fares listed are cruise-only, per person based on double occupancy and do not include port charges of \$189 per person.



CAT. AB, Cello Deck
French Balcony & Outside Balcony, 235 sq. ft.

Brochure Fare \$4,898 pp
Your rate \$4,648 pp

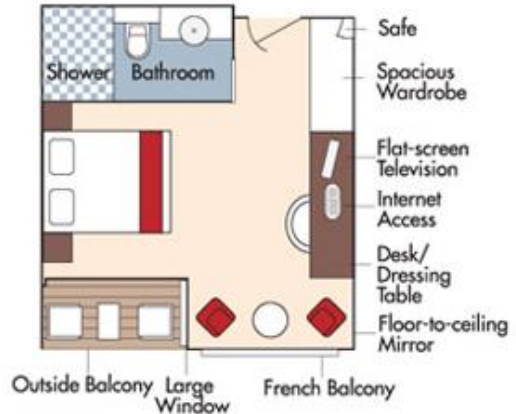

CAT. BA, Violin Deck
French Balcony & Outside Balcony, 210 sq. ft.

Brochure Fare \$4,698 pp
Your rate \$4,448 pp

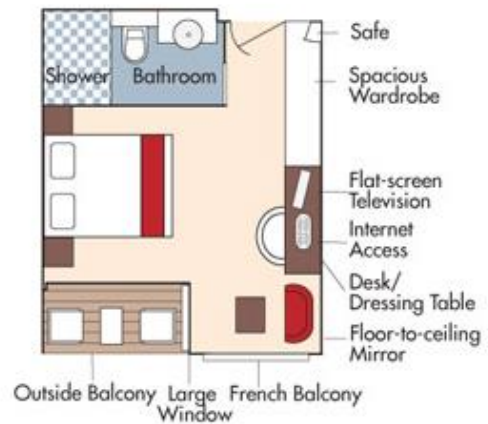



CAT. BB, Cello Deck
French Balcony & Outside Balcony, 210 sq. ft.

Brochure Fare \$4,498 pp
Your rate \$4,248 pp

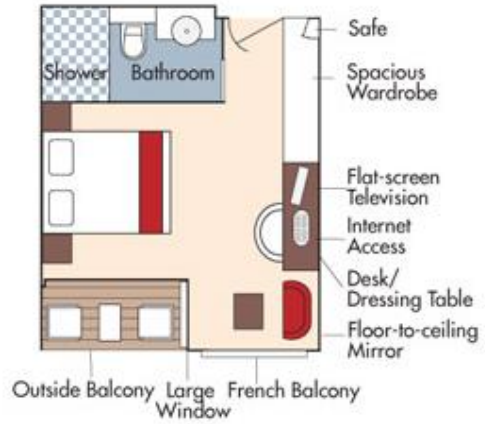

CAT. C, Violin & Cello Deck
French Balcony, 170 sq. ft.

Category CA
Brochure Fare \$3,998 pp
Your rate \$3,748 pp

Category CB
Brochure Fare \$3,698 pp
Your rate \$3,448 pp

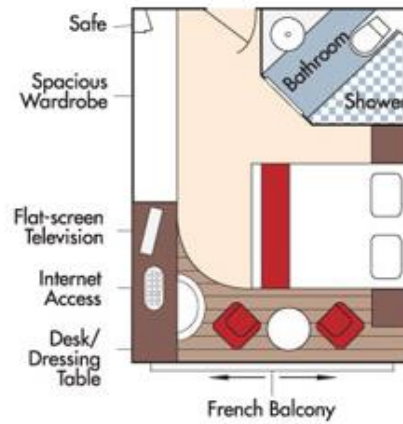



CAT. D, Piano Deck
Fixed Windows, 160 sq. ft.

Brochure Fare **\$3,298 pp**
Your rate **\$3,048 pp**

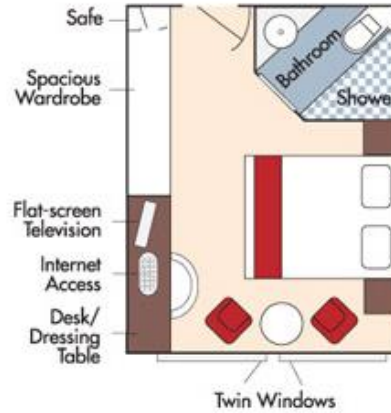

CAT. E, Piano Deck
Fixed Windows, 160 sq. ft.

Brochure Fare **\$2,999 pp**
Your rate **\$2,749 pp**

AmaViola Deck Plan

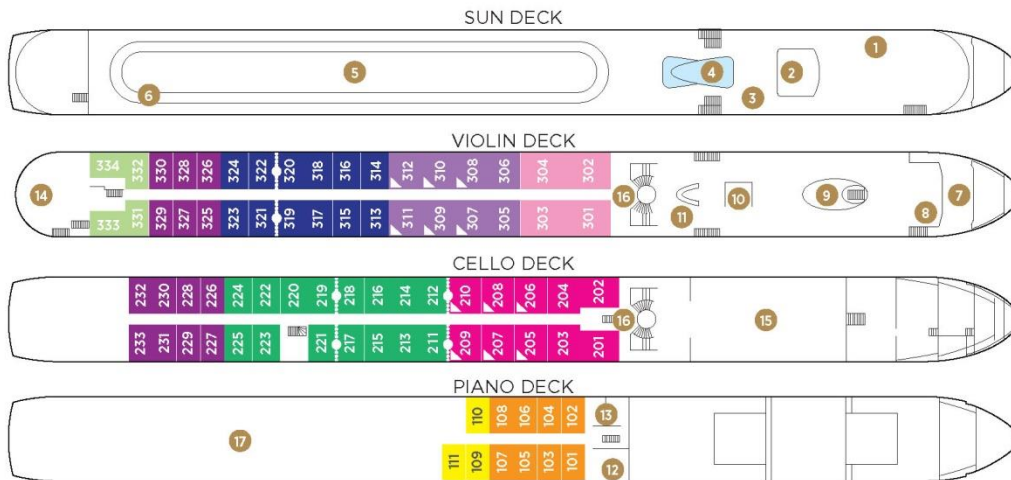

- 1 Lower Sun Deck
- 2 Navigation Bridge
- 3 Bicycles
- 4 Heated Pool
- 5 Sun Deck
- 6 Walking Track
- 7 *Al Fresco* Dining Terrace
- 8 Observation Lounge
- 9 Main Lounge & Bar
- 10 Gift Shop
- 11 Reception
- 12 Fitness Room
- 13 Massage & Hair Salon
- 14 The Chef's Table Restaurant
- 15 Main Restaurant
- 16 Elevator
- 17 Crew Cabins

*Elevator on AmaLea and AmaKristina reaches Main Restaurant, Lobby/Main Lounge and staterooms on Violin, Cello and Piano Deck.
Elevator on AmaStella and AmaViola reaches Main Restaurant, Lobby/Main Lounge and staterooms on Violin and Cello Deck.*

Suite	Violin Deck / French & Outside Balcony - 350 sq. ft.	Cat. CA	Violin & Cello Deck / French Balcony - 170 sq. ft.
Cat. AA	Violin Deck / French & Outside Balcony - 235 sq. ft.	Cat. CB	Violin Deck / French Balcony - 155 sq. ft.
Cat. AB	Cello Deck / French & Outside Balcony - 235 sq. ft.	Cat. D	Piano Deck / Fixed Windows - 160 sq. ft.
Cat. BA	Violin Deck / French & Outside Balcony - 210 sq. ft.	Cat. E	Piano Deck / Fixed Windows - 160 sq. ft.
Cat. BB	Cello Deck / French & Outside Balcony - 210 sq. ft.		

••••• Staterooms can become adjoining by request. ▲ Up to triple occupancy.

Fares listed are cruise-only, per person based on double occupancy and do not include port charges of \$189 per person.