



Special Rates when you book by Jan 31, 2020

# RIVER CRUISE FOR WINE LOVERS

## Savor Bordeaux with Wine Expert Paul Wagner

Aboard the AmaDolce • 7 Nights • April 9 to 16, 2020

Bordeaux • Libourne • Saint-Émilion • Blaye • Bourg • Pauillac • Cadillac



Suite, Violin Deck  
French Balcony, 255 sq. ft.

Note: Stateroom layouts shown below are not to scale.



USD  
Brochure Fare: ~~\$6,098~~ pp  
Your Rate: \$5,848 pp

CAD  
Brochure Fare: ~~\$7,440~~ pp  
Your Rate: \$7,140 pp



CAT. A+, Violin Deck  
French Balcony, 225 sq. ft.

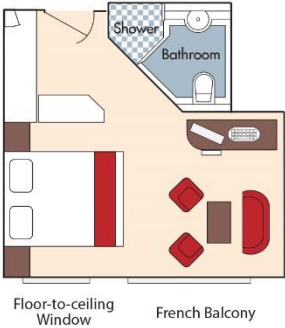

USD  
Brochure Fare: ~~\$5,898~~ pp  
Your Rate: \$5,648 pp

CAD  
Brochure Fare: ~~\$7,196~~ pp  
Your Rate: \$6,896 pp



CAT. A, Violin Deck  
French Balcony, 170 sq. ft.

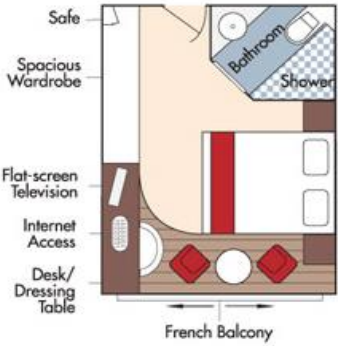

USD  
Brochure Fare: ~~\$4,898~~ pp  
Your Rate: \$4,648 pp

CAD  
Brochure Fare: ~~\$5,976~~ pp  
Your Rate: \$5,676 pp

Fares listed are cruise-only, per person based on double occupancy and do not include port charges of \$189 USD (\$231 CAD) per person.

**CAT. B, Violin & Cello Deck**  
French Balcony, 170 sq. ft.

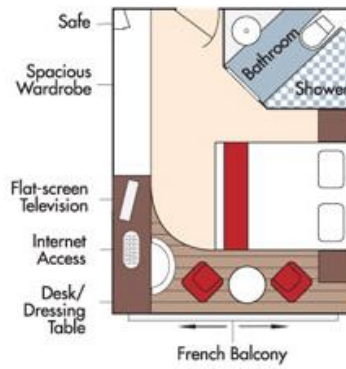

**USD**  
Brochure Fare: ~~\$4,798~~ pp  
Your Rate: **\$4,548 pp**

**CAD**  
Brochure Fare: ~~\$5,854~~ pp  
Your Rate: **\$5,554 pp**

**CAT. C, Violin & Cello Deck**  
French Balcony, 170 sq. ft.

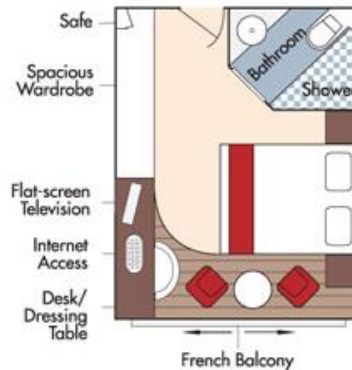

**USD**  
Brochure Fare: ~~\$4,598~~ pp  
Your Rate: **\$4,348 pp**

**CAD**  
Brochure Fare: ~~\$5,610~~ pp  
Your Rate: **\$5,310 pp**

**CAT. E, Piano Deck**  
Fixed Windows, 170 sq. ft.



**CAT. D, Piano Deck**  
Fixed Windows, 170 sq. ft.

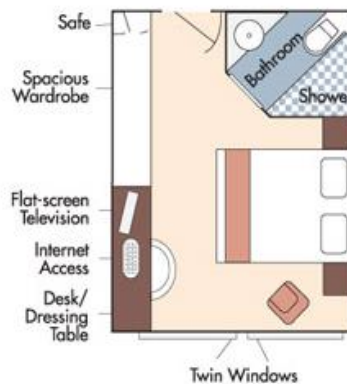

**Category D - USD**  
Brochure Fare: ~~\$3,898~~ pp  
Your Rate: **\$3,648 pp**

**Category D - CAD**  
Brochure Fare: ~~\$4,756~~ pp  
Your Rate: **\$4,456 pp**

**Category E - USD**  
Brochure Fare: ~~\$3,599~~ pp  
Your Rate: **\$3,349 pp**

**Category E - CAD**  
Brochure Fare: ~~\$4,391~~ pp  
Your Rate: **\$4,091 pp**

## AmaDolce Deck Plan

