

Join Us for a Rhine River Wine Cruise with Benovia Winery and Aperture Cellars

AmaMora • 7 Nights • Amsterdam to Basel • May 13-20, 2021

Amsterdam • Cologne • Rudesheim • Ludwigshafen • Strasbourg • Breisach • Basel

Note: Stateroom layouts shown below are not to scale.

**Book By 4/30/20 and receive
FREE Pre-Paid Gratuities**

Suite *Violin Deck*
French Balcony & Outside Balcony, 350 sq. ft.

Your rate \$7,691pp

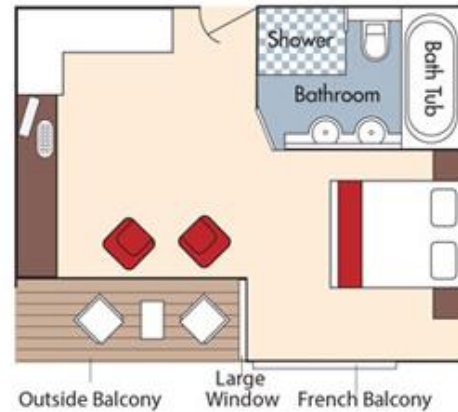

Category AA *Violin Deck*
French Balcony & Outside Balcony, 235 sq. ft.

Your rate \$6,291pp

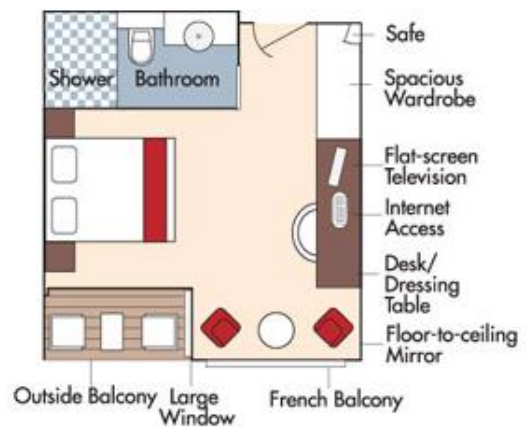

Fares listed are cruise-only, per person based on double occupancy and do not include port charges of \$196 per person.



Category AB *Cello Deck*

French Balcony & Outside Balcony, 235 sq. ft. **Your rate \$6,091pp**

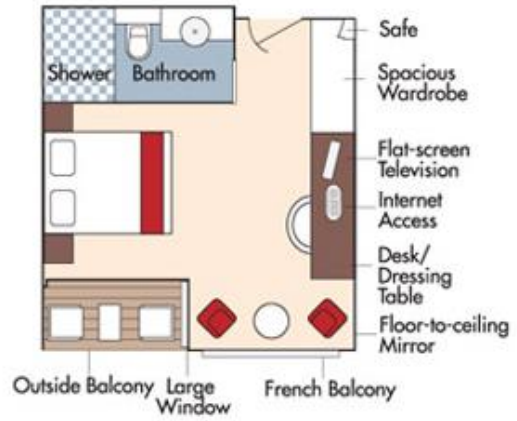

Category BA *Violin Deck*

French Balcony & Outside Balcony, 210 sq. ft. **Your rate \$5,891pp**

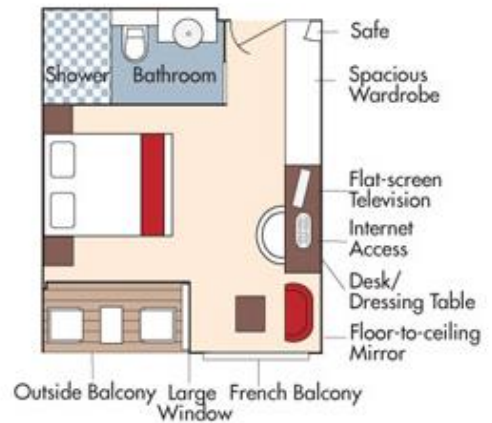

Category BB *Cello Deck*

French Balcony & Outside Balcony, 210 sq. ft. **Your rate \$5,691pp**

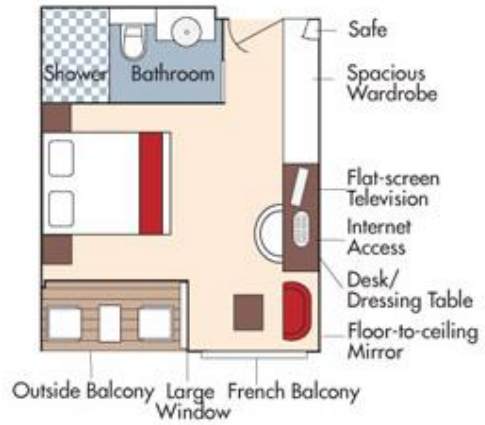

Category CA *Violin & Cello Deck*

French Balcony, 170 sq. ft.

Category CA

Your rate \$5,091pp

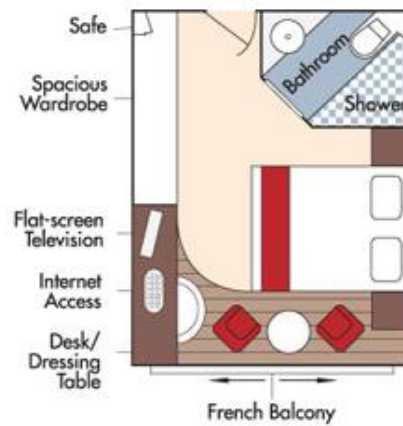

Category CB *Violin Deck*

French Balcony, 155 sq. ft.

Category CB

Your rate \$4,791pp

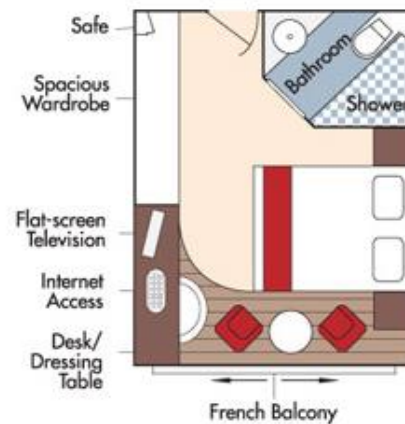

Fares listed are cruise-only, per person based on double occupancy and do not include port charges of \$196 per person.

Category D *Piano Deck*
Fixed Windows, 160 sq. ft.



Your rate \$4,391pp

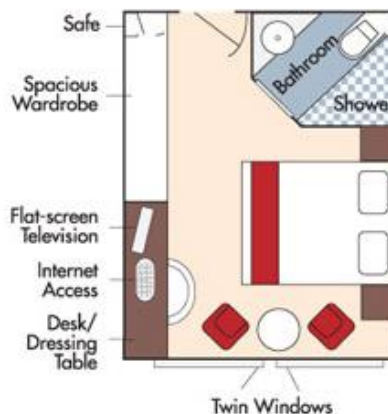

Category E *Piano Deck*
Fixed Windows, 160 sq. ft.

Your rate \$4,092pp

AmaMora
DECK PLAN

- 1 Lower Sun Deck
- 2 Navigation Bridge
- 3 Bicycles
- 4 Heated Pool
- 5 Sun Deck
- 6 Walking Track
- 7 Al Fresco Terrace
- 8 Observation Lounge
- 9 Main Lounge & Bar
- 10 Gift Shop
- 11 Reception
- 12 The Chef's Table Restaurant
- 13 Main Restaurant
- 14 Elevator
- 15 Massage & Hair Salon
- 16 Fitness Room
- 17 Crew Cabins

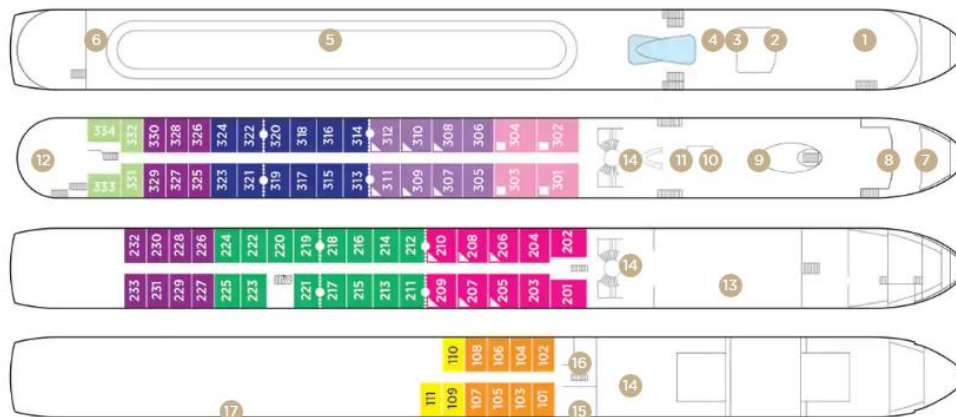

Note: Elevator reaches the Violin, Cello and Piano Deck (does not reach the Sun Deck).

..... Staterooms can become adjoining by request.

▲ Up to triple occupancy

Stateroom Categories

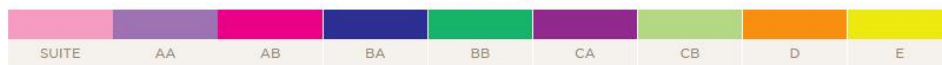

Fares listed are cruise-only, per person based on double occupancy and do not include port charges of \$196 per person.