

Wine Cruise on the Danube

to Benefit the Sonoma County Farmworker Community

Aboard the AmaMagna • 7 Nights • April 14 - 21, 2021

Vilshofen • Passau • Linz • Grein • Melk • Spitz • Vienna • Budapest

Note: Stateroom layouts shown below are not to scale.

Category OS *Upper Deck*

Outside Balcony, 710 sq. ft.

\$13,548 per person



- In-room temperature control
- Spacious bathrooms with multi-jet showerheads
- Large wardrobe, full-length mirror, hair dryer, safe and direct-dial telephone
- Flat-screen TV that also works as a computer
- Entertainment on Demand system providing complimentary TV, movies and music library
- Complimentary bottled water replenished daily
- Complimentary internet and Wi-Fi
- Desk and chair

Outside Balcony

Category GS *Upper Deck*

Outside Balcony, 474 sq. ft.

\$10,548 per person

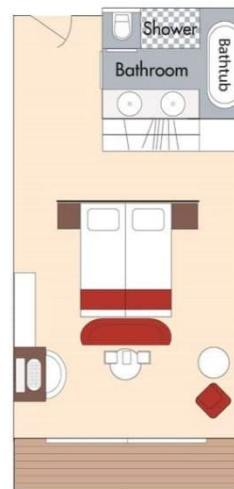

- In-room temperature control
- Spacious bathrooms with multi-jet showerheads
- Large wardrobe, full-length mirror, hair dryer, safe and direct-dial telephone
- Flat-screen TV that also works as a computer
- Entertainment on Demand system providing complimentary TV, movies and music library
- Complimentary bottled water replenished daily
- Complimentary internet and Wi-Fi
- Desk and chair

Outside Balcony

Category SA *Upper Deck*

Outside Balcony, 355 sq. ft.

\$6,748 per person

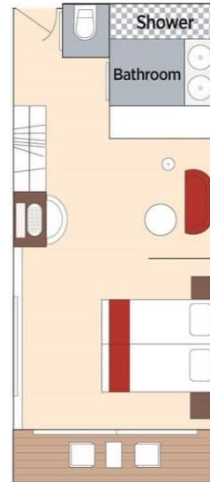

Outside Balcony

- In-room temperature control
- Spacious bathrooms with multi-jet showerheads
- Large wardrobe, full-length mirror, hair dryer, safe and direct-dial telephone
- Flat-screen TV that also works as a computer
- Entertainment on Demand system providing complimentary TV, movies and music library
- Complimentary bottled water replenished daily
- Complimentary internet and Wi-Fi
- Desk and chair

Category SB *Main Deck*

Outside Balcony, 355 sq. ft.

\$6,248 per person

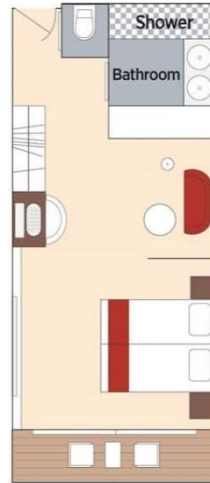

Outside Balcony

- In-room temperature control
- Spacious bathrooms with multi-jet showerheads
- Large wardrobe, full-length mirror, hair dryer, safe and direct-dial telephone
- Flat-screen TV that also works as a computer
- Entertainment on Demand system providing complimentary TV, movies and music library
- Complimentary bottled water replenished daily
- Complimentary internet and Wi-Fi
- Desk and chair

Category AA *Upper Deck*

Outside Balcony, 252 sq. ft.

\$5,748 per person

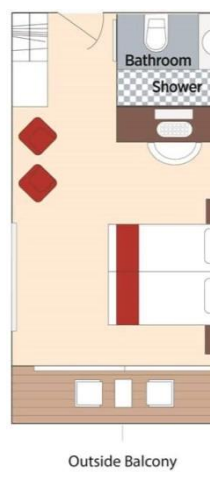

Outside Balcony

- In-room temperature control
- Spacious bathrooms with multi-jet showerheads
- Large wardrobe, full-length mirror, hair dryer, safe and direct-dial telephone
- Flat-screen TV that also works as a computer
- Entertainment on Demand system providing complimentary TV, movies and music library
- Complimentary bottled water replenished daily
- Complimentary internet and Wi-Fi
- Desk and chair

Category AB *Main Deck*

Outside Balcony, 252 sq. ft.

\$5,548 per person

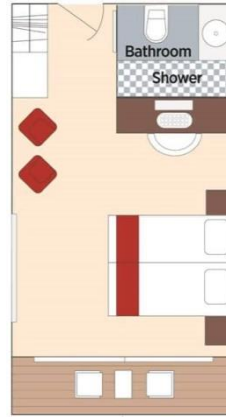

Outside Balcony

- In-room temperature control
- Spacious bathrooms with multi-jet showerheads
- Large wardrobe, full-length mirror, hair dryer, safe and direct-dial telephone
- Flat-screen TV that also works as a computer
- Entertainment on Demand system providing complimentary TV, movies and music library
- Complimentary bottled water replenished daily
- Complimentary internet and Wi-Fi
- Desk and chair

Category D *Lower Deck*

Fixed Window, 205 sq. ft.

\$4,048 per person

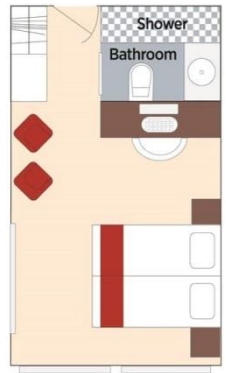

Fixed Windows

- In-room temperature control
- Spacious bathrooms with multi-jet showerheads
- Large wardrobe, full-length mirror, hair dryer, safe and direct-dial telephone
- Flat-screen TV that also works as a computer
- Entertainment on Demand system providing complimentary TV, movies and music library
- Complimentary bottled water replenished daily
- Complimentary internet and Wi-Fi
- Desk and chair

Category E *Lower Deck*

Fixed Window, 205 sq. ft.

\$3,549 per person

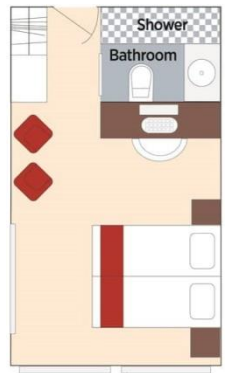

Fixed Windows

- In-room temperature control
- Spacious bathrooms with multi-jet showerheads
- Large wardrobe, full-length mirror, hair dryer, safe and direct-dial telephone
- Flat-screen TV that also works as a computer
- Entertainment on Demand system providing complimentary TV, movies and music library
- Complimentary bottled water replenished daily
- Complimentary internet and Wi-Fi
- Desk and chair

AmaMagna DECK PLAN

- 1 Pop-Up Sky Bar
- 2 Pool / Whirlpool
- 3 Walking Track
- 4 The *Al Fresco* Restaurant
- 5 Lower Lounge
- 6 Main Lounge
- 7 Elevator
- 8 Zen Wellness Studio
- 9 Massage Rooms
- 10 Main Restaurant
- 11 Reception
- 12 Water Sports Platform
- 13 Jimmy's Restaurant
- 14 The Chef's Table Restaurant



Note: Elevator reaches the Violin, Cello and Piano Deck; pop-up lift available for Sun Deck access.

.....●.....
Staterooms can become adjoining by request.

▲
Up to triple and quad occupancy

Stateroom Categories

