

# TEXAS ON THE RHÔNE

Aboard the AmaKristina • 7 Nights • November 11 to 18, 2021  
Avignon • Tarascon • Viviers • Tournon • Vienne • Lyon

*Note: Stateroom layouts shown below are not to scale.*



## Suite *Violin Deck*

French Balcony & Outside Balcony, 350 sq. ft.

Your rate \$6,998 pp

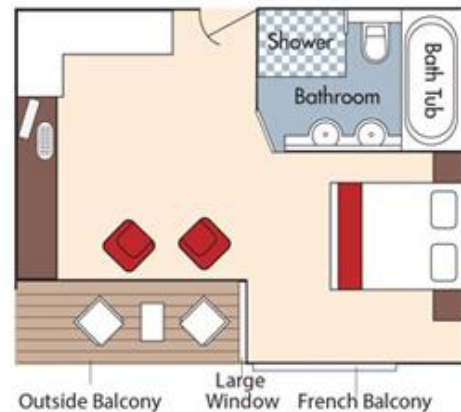

## Category AA *Violin Deck*

French Balcony & Outside Balcony, 235 sq. ft.

Your rate \$5,598 pp

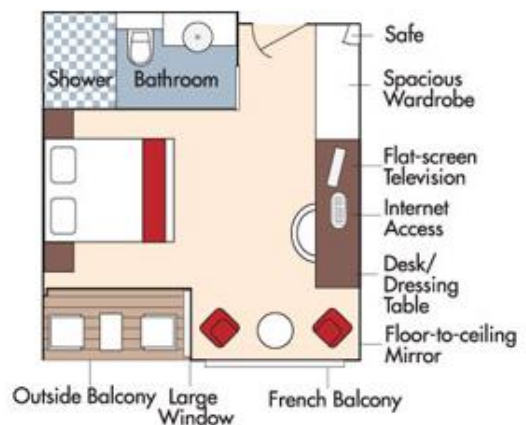

*Fares listed are cruise-only, per person based on double occupancy and do not include port charges of \$196 per person.*



## Category AB *Cello Deck*

French Balcony & Outside Balcony, 235 sq. ft.

Your rate \$5,398 pp

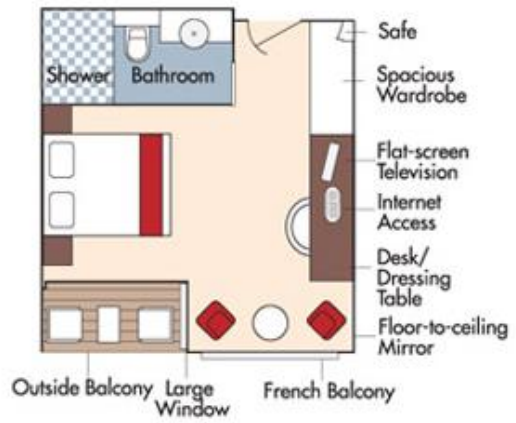

## Category BA *Violin Deck*

French Balcony & Outside Balcony, 210 sq. ft.

Your rate \$5,198 pp

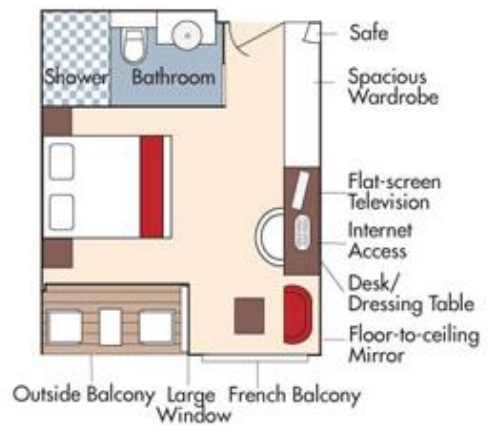



### Category BB *Cello Deck*

French Balcony & Outside Balcony, 210 sq. ft.

Your rate \$4,998 pp

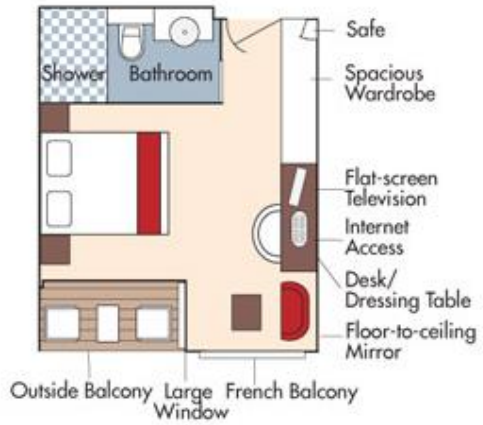

### Category CA *Violin & Cello Deck*

French Balcony, 170 sq. ft.

### Category CA

Your rate \$4,398 pp

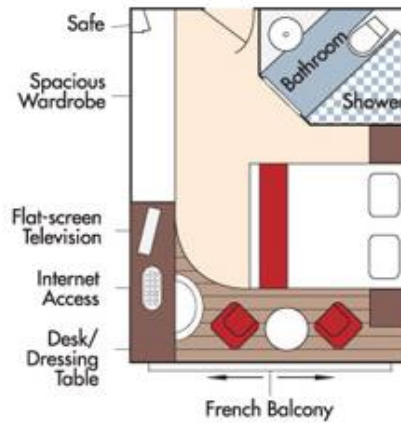

### Category CB *Violin Deck*

French Balcony, 155 sq. ft.

### Category CB

Your rate \$4,098 pp

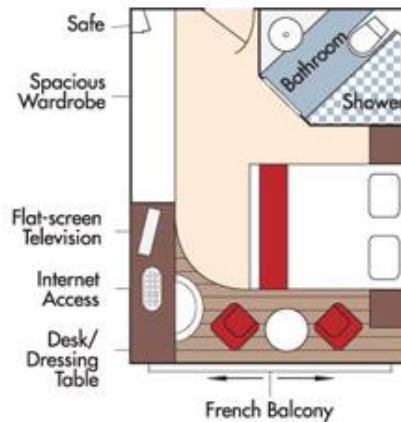

Fares listed are cruise-only, per person based on double occupancy and do not include port charges of \$196 per person.



### Category D *Piano Deck*

Fixed Windows, 160 sq. ft.

Your rate \$3,698 pp

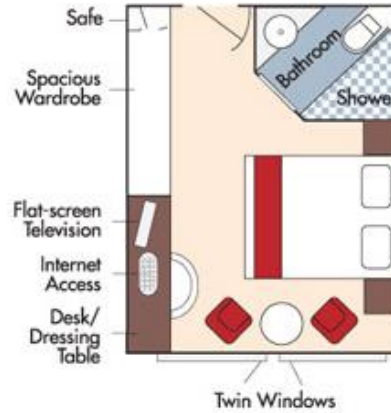

### Category E *Piano Deck*

Fixed Windows, 160 sq. ft.

Your rate \$3,399 pp

## AmaKristina DECK PLAN

- 1 Lower Sun Deck
- 2 Navigation Bridge
- 3 Bicycles
- 4 Heated Pool
- 5 Sun Deck
- 6 Walking Track
- 7 Al Fresco Terrace
- 8 Observation Lounge
- 9 Main Lounge & Bar
- 10 Gift Shop
- 11 Reception
- 12 The Chef's Table Restaurant
- 13 Main Restaurant
- 14 Elevator
- 15 Massage & Hair Salon
- 16 Fitness Room
- 17 Crew Cabins

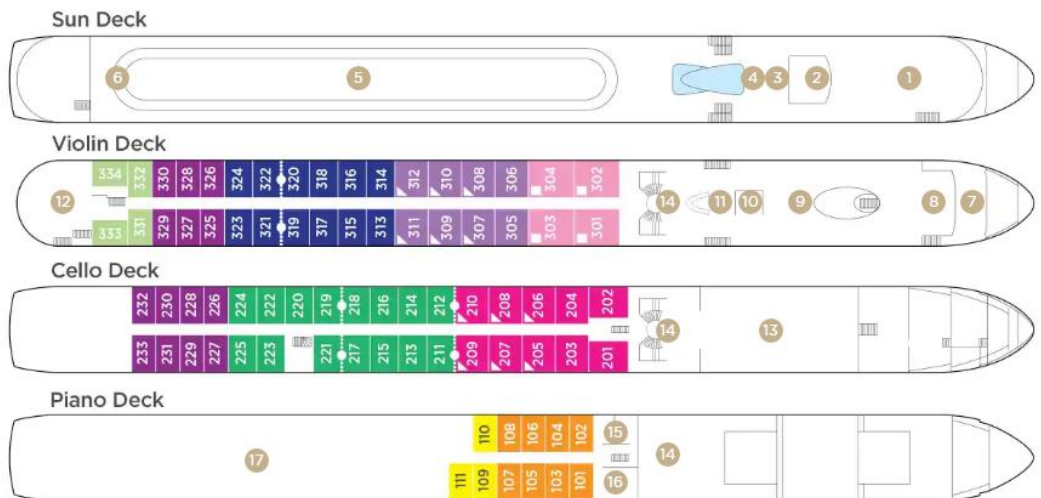

Note: Elevator reaches the Violin, Cello and Piano Deck (does not reach the Sun Deck).

Staterooms can become adjoining by request.

Up to triple occupancy

#### Stateroom Categories



Fares listed are cruise-only, per person based on double occupancy and do not include port charges of \$196 per person.