

WINE CRUISE THROUGH SOUTHERN FRANCE WITH L'ECOLE N° 41

Special Rates
When You Book By
September 30, 2020

Aboard the AmaKristina • 7 Nights • April 30 to May 6, 2021
Avignon • Tarascon • Viviers • Tournon • Vienne • Lyon

Note: Stateroom layouts shown below are not to scale.



Suite *Violin Deck*

French Balcony & Outside Balcony, 350 sq. ft.

Brochure Fare ~~\$7,848~~ pp

Your rate **\$7,598 pp**

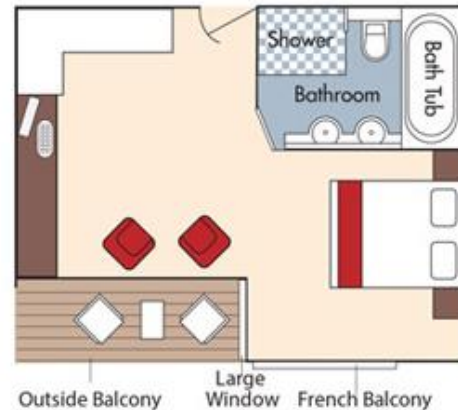

Category AA *Violin Deck*

French Balcony & Outside Balcony, 235 sq. ft.

Brochure Fare ~~\$6,448~~ pp

Your rate **\$6,198 pp**

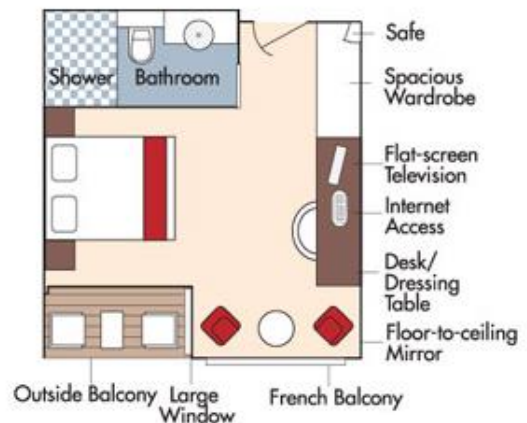

Fares listed are cruise-only, per person based on double occupancy and do not include port charges of \$196 per person.



Category AB *Cello Deck*

French Balcony & Outside Balcony, 235 sq. ft.

Brochure Fare ~~\$6,248~~ pp

Your rate **\$5,998** pp

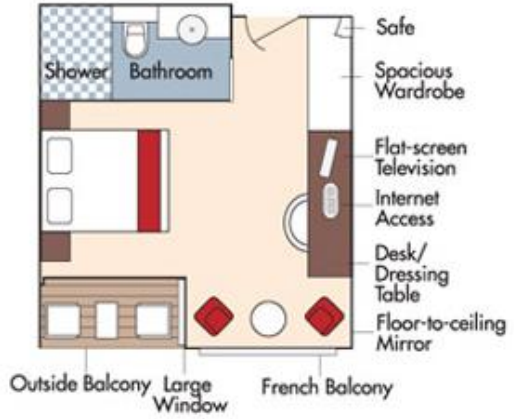

Category BA *Violin Deck*

French Balcony & Outside Balcony, 210 sq. ft.

Brochure Fare ~~\$6,048~~ pp

Your rate **\$5,798** pp

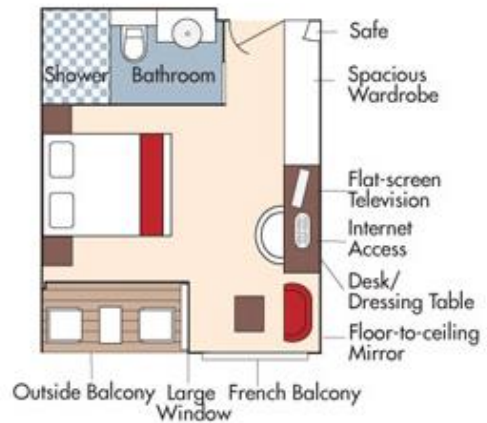



Category BB *Cello Deck*

French Balcony & Outside Balcony, 210 sq. ft.

Brochure Fare **\$5,848 pp**

Your rate **\$5,598 pp**

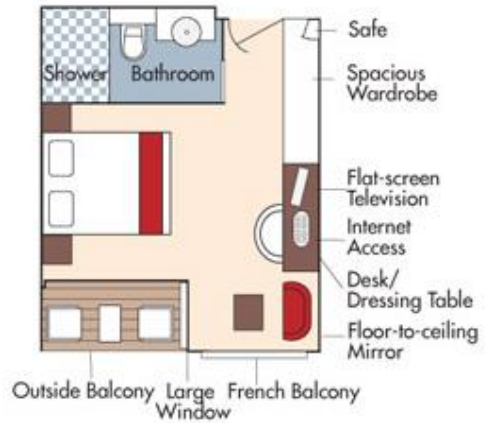

Category CA *Violin & Cello Deck*

French Balcony, 170 sq. ft.

Category CA

Brochure Fare **\$5,248 pp**

Your rate **\$4,998 pp**

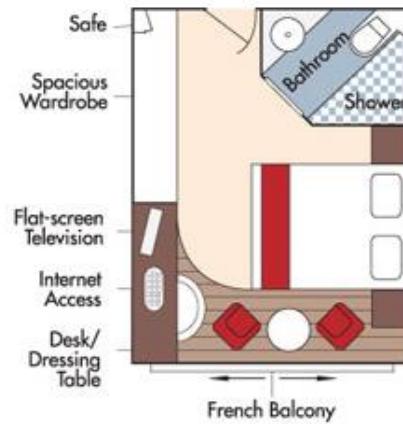

Category CB *Violin Deck*

French Balcony, 155 sq. ft.

Category CB

Brochure Fare **\$4,948 pp**

Your rate **\$4,698 pp**

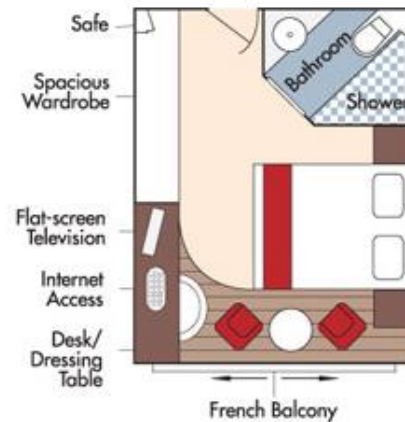

Fares listed are cruise-only, per person based on double occupancy and do not include port charges of \$196 per person.

Category D *Piano Deck*
Fixed Windows, 160 sq. ft.



Brochure Fare **\$4,548 pp**
Your rate **\$4,298 pp**

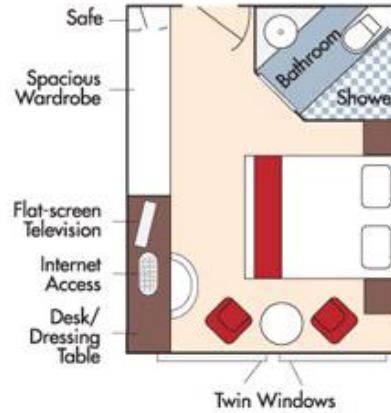

Category E *Piano Deck*
Fixed Windows, 160 sq. ft.

Brochure Fare **\$4,249 pp**
Your rate **\$3,999 pp**

AmaKristina DECK PLAN

1	Lower Sun Deck
2	Navigation Bridge
3	Bicycles
4	Heated Pool
5	Sun Deck
6	Walking Track
7	Al Fresco Terrace
8	Observation Lounge
9	Main Lounge & Bar
10	Gift Shop
11	Reception
12	The Chef's Table Restaurant
13	Main Restaurant
14	Elevator
15	Massage & Hair Salon
16	Fitness Room
17	Crew Cabins

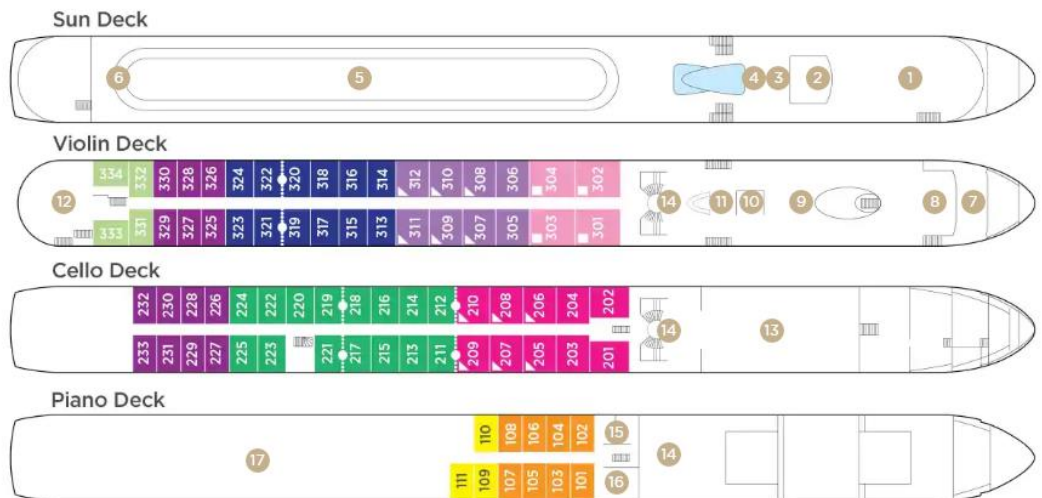

Note: Elevator reaches the Violin, Cello and Piano Deck (does not reach the Sun Deck).

Staterooms can become adjoining by request.

Up to triple occupancy

Stateroom Categories



Fares listed are cruise-only, per person based on double occupancy and do not include port charges of \$196 per person.