



**Special Rates when you
book by September 30, 2020**

RIVER CRUISE FOR WINE LOVERS

Petaluma Gap Winegrowers Alliance

Aboard the AmaVerde • 7 Nights • April 4 to 11, 2021

Budapest • Bratislava • Vienna • Weissenkirchen • Grein • Linz • Passau • Vilshofen

Note: Stateroom layouts shown below are not to scale.



Suite, Violin Deck
French Balcony & Outside Balcony, 350 sq. ft.

Brochure Fare ~~\$6,698~~ pp

Your rate \$6,448 pp

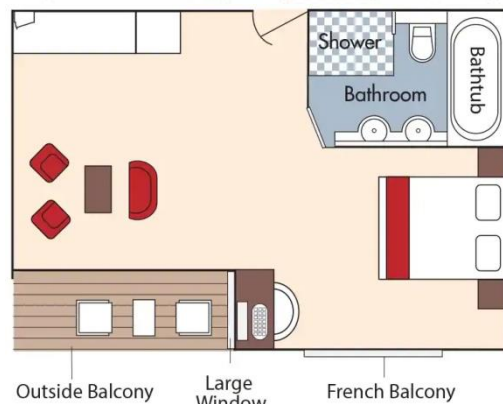

CAT. AA, Violin Deck
French Balcony & Outside Balcony, 235 sq. ft.

Brochure Fare ~~\$5,298~~ pp

Your rate \$5,048 pp

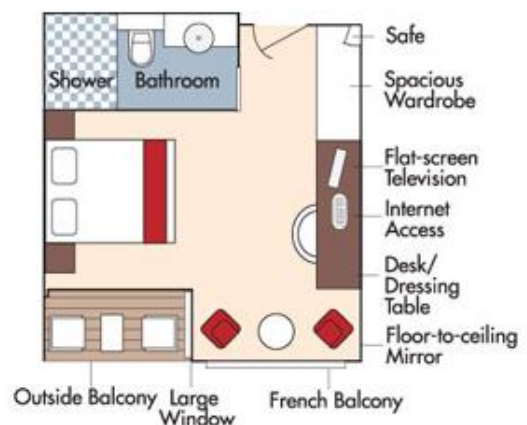

Fares listed are cruise-only, per person based on double occupancy and do not include port charges of \$196 per person.



CAT. AB, Cello Deck
French Balcony & Outside Balcony, 235 sq. ft.

Brochure Fare \$5,098 pp
Your rate \$4,848 pp

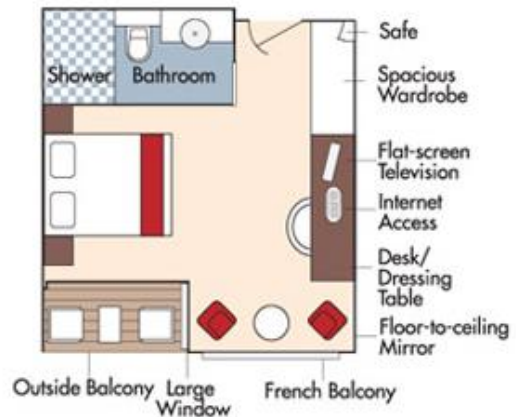

CAT. BA, Violin Deck
French Balcony & Outside Balcony, 210 sq. ft.

Brochure Fare \$4,898 pp
Your rate \$4,648 pp

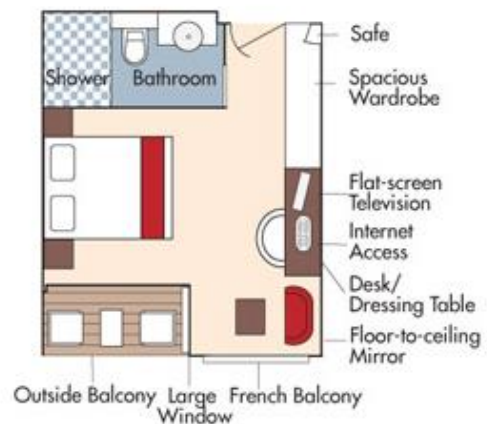



CAT. BB, Cello Deck
French Balcony & Outside Balcony, 210 sq. ft.



Brochure Fare \$4,698 pp
Your rate \$4,448 pp

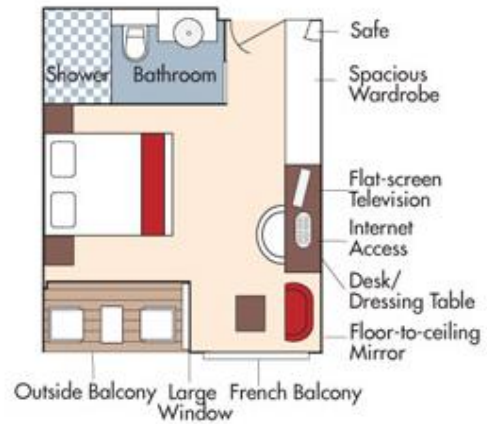

CAT. C, Violin & Cello Deck
French Balcony, 170 sq. ft.



Brochure Fare \$4,098 pp
Your rate \$3,848 pp

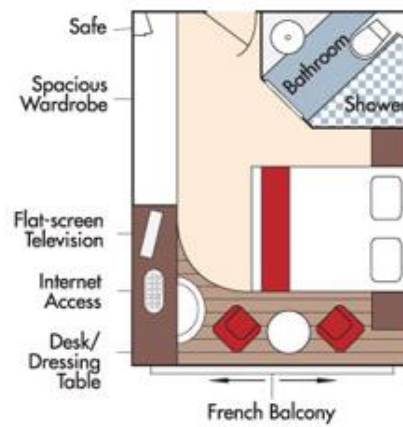



CAT. D, Piano Deck
Fixed Windows, 170 sq. ft.



Brochure Fare \$3,398 pp
Your rate \$3,148 pp

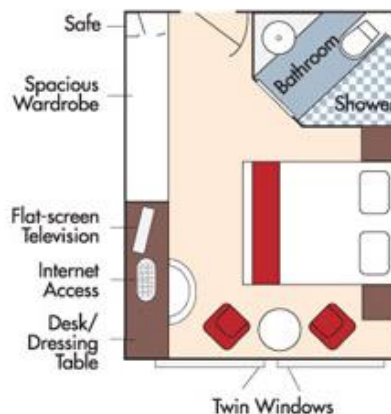

CAT. E, Piano Deck
Fixed Windows, 170 sq. ft.

Brochure Fare \$3,099 pp
Your rate \$2,849 pp

AmaVerde DECK PLAN

[ENLARGE DECK PLAN](#)

1	Lower Sun Deck
2	Navigation Bridge
3	Bicycles
4	Heated Pool
5	Sun Deck
6	Walking Track
7	Putting Green
8	Bow Seating Area
9	Observation Lounge
10	Main Lounge & Bar
11	Gift Shop
12	Reception
13	Massage & Hair Salon
14	Fitness Room
15	The Chef's Table Restaurant
16	Main Restaurant
17	Elevator
18	Crew Cabins



Stateroom Categories

SUITE	AA	AB	BA	BB	C	D	E
-------	----	----	----	----	---	---	---

Fares listed are cruise-only, per person based on double occupancy and do not include port charges of \$196 per person.