



Special Rates when you book by November 30, 2020

# RIVER CRUISE FOR WINE LOVERS

## Amphora Winery

Aboard AmaBella • 7 Nights • March 28 to April 4, 2022

Budapest • Vienna • Weissenkirchen • Dürnstein • Melk • Grein • Linz • Passau • Vilshofen

Note: Stateroom layouts shown below are not to scale.



Suite, Violin Deck  
French Balcony & Outside Balcony, 350 sq. ft.

Brochure Fare ~~\$6,698~~ pp  
Your rate \$5,948 pp

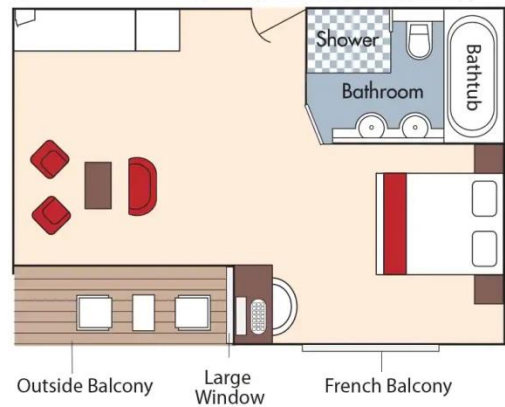

CAT. AA, Violin Deck  
French Balcony & Outside Balcony, 235 sq. ft.

Brochure Fare ~~\$5,398~~ pp  
Your rate \$4,648 pp



Fares listed are cruise-only, per person based on double occupancy and do not include port charges of \$210 per person.



**CAT. AB, Cello Deck**  
**French Balcony & Outside Balcony, 235 sq. ft.**

**Brochure Fare \$5,198 pp**  
**Your rate \$4,448 pp**



**CAT. BA, Violin Deck**  
**French Balcony & Outside Balcony, 210 sq. ft.**

**Brochure Fare \$4,998 pp**  
**Your rate \$4,248 pp**

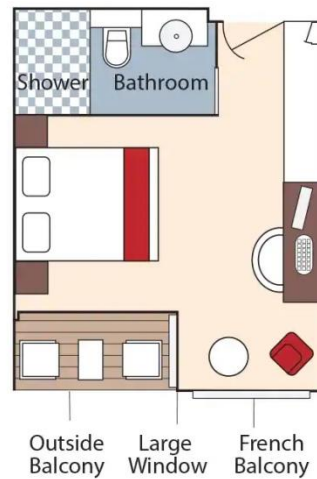



**CAT. BB, Cello Deck**  
**French Balcony & Outside Balcony, 210 sq. ft.**



**Brochure Fare \$4,798 pp**  
**Your rate \$4,048 pp**

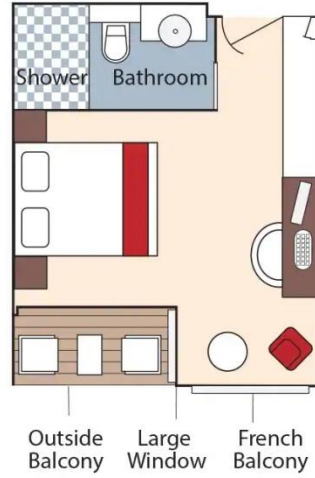

**CAT. C, Violin & Cello Deck**  
**French Balcony, 170 sq. ft.**



**Category CA**  
**Brochure Fare \$4,198 pp**  
**Your rate \$3,448 pp**

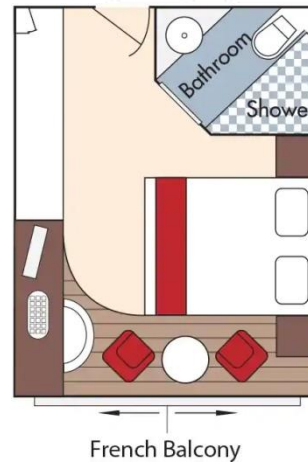

**Category CB**  
**Brochure Fare \$3,898 pp**  
**Your rate \$3,148 pp**





**CAT. D, Piano Deck**  
Fixed Windows, 170 sq. ft.

Brochure Fare ~~\$3,398~~ pp  
Your rate **\$2,648** pp

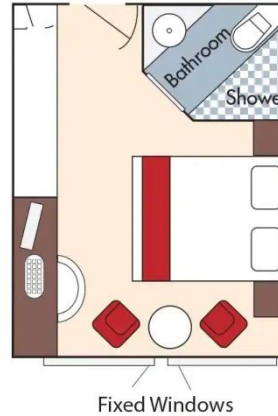

**CAT. E, Piano Deck**  
Fixed Windows, 170 sq. ft.

Brochure Fare ~~\$3,099~~ pp  
Your rate **\$2,349** pp

## AmaBella DECK PLAN

1	Lower Sun Deck
2	Navigation Bridge
3	Bicycles
4	Heated Pool
5	Sun Deck
6	Walking Track
7	Putting Green
8	Bow Seating Area
9	Observation Lounge
10	Main Lounge & Bar
11	Gift Shop
12	Reception
13	Massage & Hair Salon
14	Fitness Room
15	The Chef's Table Restaurant
16	Main Restaurant
17	Elevator
18	Crew Cabins



Stateroom Categories

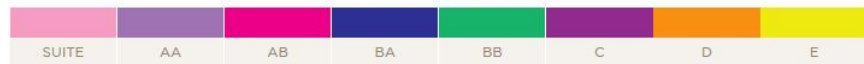

Fares listed are cruise-only, per person based on double occupancy and do not include port charges of \$210 per person.