

# WINE CRUISE THROUGH SOUTHERN FRANCE WITH L'ECOLE N° 41

Aboard AmaKristina • 7 Nights • July 21 to 28, 2022  
Lyon • Collonges • Vienne • Tournon • Tarascon • Avignon

*Note: Stateroom layouts shown below are not to scale.*



## Suite *Violin Deck*

French Balcony & Outside Balcony, 350 sq. ft. **Your rate \$7,798 pp**

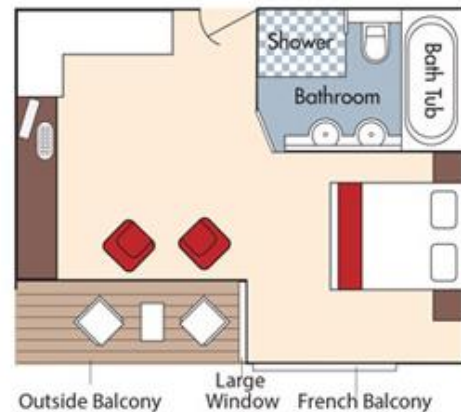

## Category AA *Violin Deck*

French Balcony & Outside Balcony, 235 sq. ft. **Your rate \$6,498 pp**

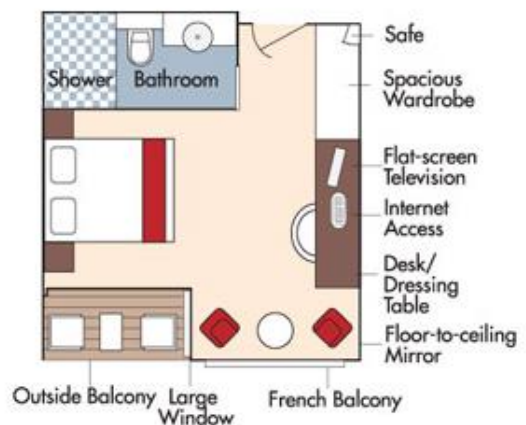

*Fares listed are cruise-only, per person based on double occupancy and include the exclusive wine package. Port charges of \$210 per person are additional.*



## Category AB *Cello Deck*

French Balcony & Outside Balcony, 235 sq. ft. **Your rate \$6,298 pp**

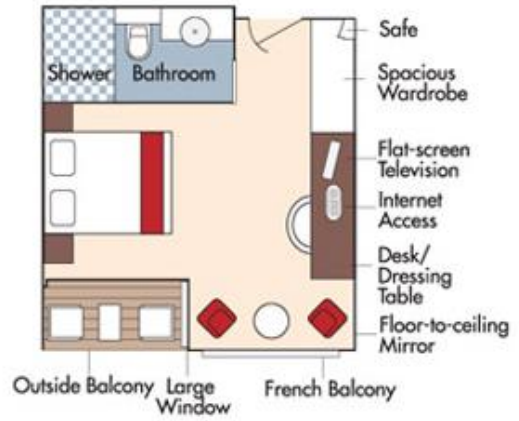

## Category BA *Violin Deck*

French Balcony & Outside Balcony, 210 sq. ft. **Your rate \$6,098 pp**

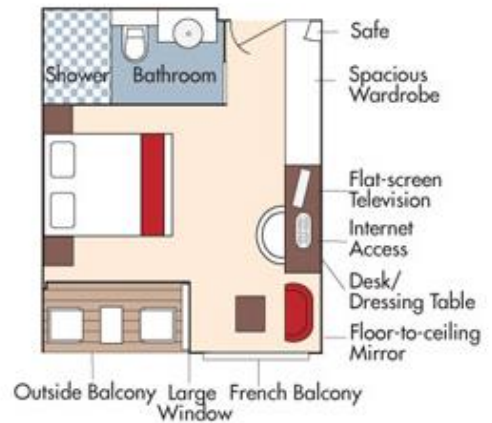





### Category BB *Cello Deck*

French Balcony & Outside Balcony, 210 sq. ft.

**Your rate \$5,898 pp**

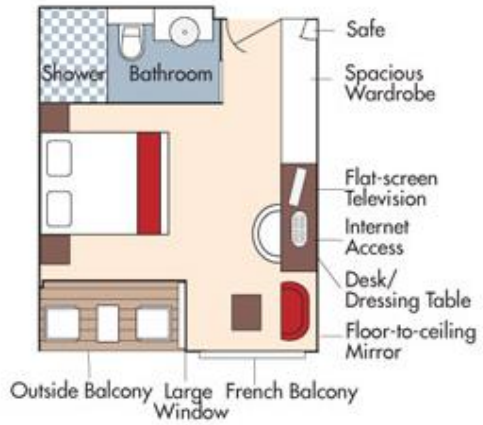

### Category CA *Violin & Cello Deck*

French Balcony, 170 sq. ft.

### Category CA

**Your rate \$5,298 pp**

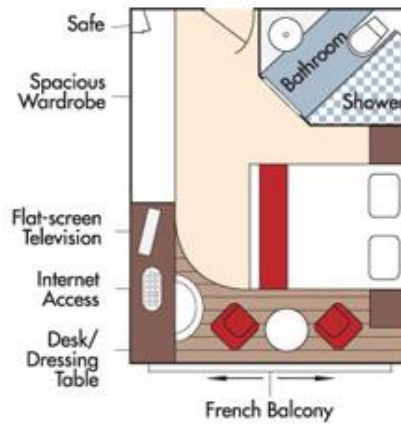

### Category CB *Violin Deck*

French Balcony, 155 sq. ft.

### Category CB

**Your rate \$4,998 pp**

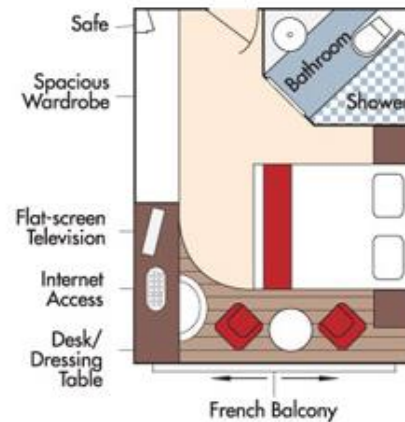

Fares listed are cruise-only, per person based on double occupancy and include the exclusive wine package. Port charges of \$210 per person are additional.



### Category D *Piano Deck*

Fixed Windows, 160 sq. ft.

Your rate \$4,498 pp

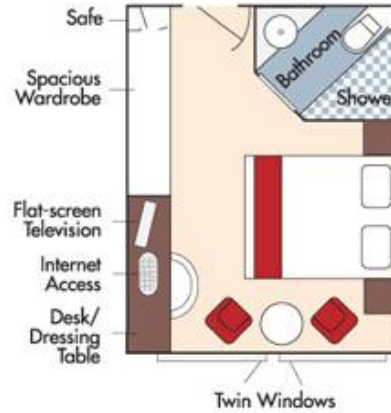

### Category E *Piano Deck*

Fixed Windows, 160 sq. ft.

Your rate \$4,199 pp

## AmaKristina DECK PLAN

- 1 Lower Sun Deck
- 2 Navigation Bridge
- 3 Bicycles
- 4 Heated Pool
- 5 Sun Deck
- 6 Walking Track
- 7 Al Fresco Terrace
- 8 Observation Lounge
- 9 Main Lounge & Bar
- 10 Gift Shop
- 11 Reception
- 12 The Chef's Table Restaurant
- 13 Main Restaurant
- 14 Elevator
- 15 Massage & Hair Salon
- 16 Fitness Room
- 17 Crew Cabins

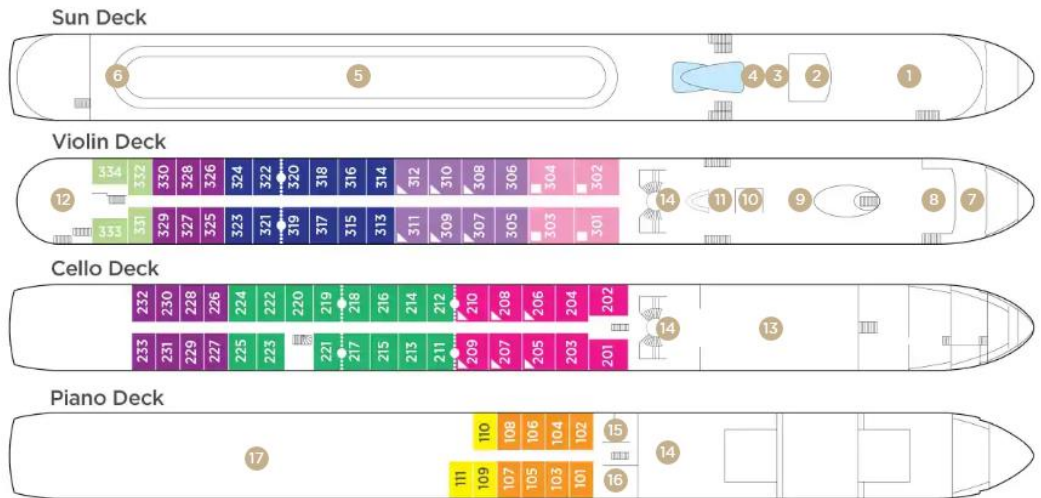

Note: Elevator reaches the Violin, Cello and Piano Deck (does not reach the Sun Deck).

Staterooms can become adjoining by request.

Up to triple occupancy

#### Stateroom Categories



Fares listed are cruise-only, per person based on double occupancy and include the exclusive wine package. Port charges of \$210 per person are additional.