



Special Rates when you book by Nov 30, 2020

# RIVER CRUISE FOR WINE LOVERS

## Peterson Winery

Aboard AmaSiena • 7 Nights • April 7 to 14, 2022

Basel • Breisach • Strasbourg • Ludwigshafen • Rudesheim • Lahnstein • Cologne • Amsterdam

Note: Stateroom layouts shown below are not to scale.



### Suite *Violin Deck*

French Balcony & Outside Balcony, 350 sq. ft.

Brochure Fare ~~\$6,798~~ pp

Your rate **\$6,048** pp

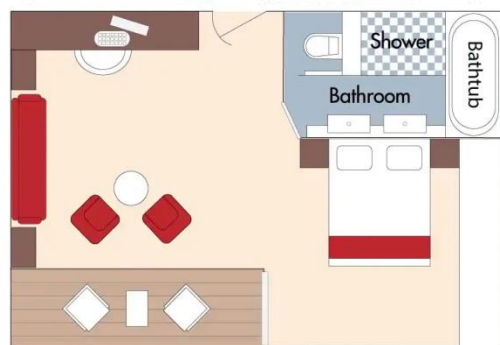

Outside Balcony Large Window French Balcony



### Category AA *Violin Deck*

French Balcony & Outside Balcony, 235 sq. ft.

Brochure Fare ~~\$5,498~~ pp

Your rate **\$4,748** pp



Outside Balcony Large Window French Balcony

Fares listed are cruise-only, per person based on double occupancy and do not include port charges of \$210 per person.



### Category AB *Cello Deck*

French Balcony & Outside Balcony, 235 sq. ft.

Brochure Fare ~~\$5,298~~ pp

Your rate \$4,548 pp

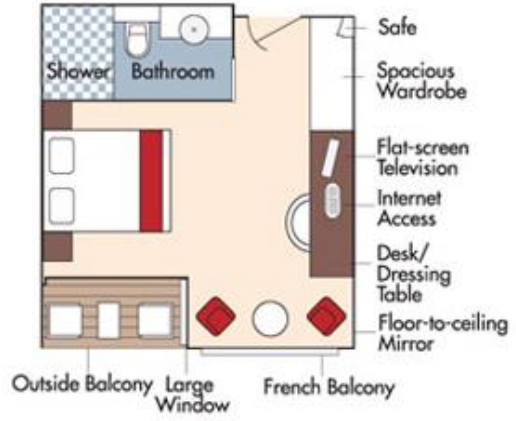

### Category BA *Violin Deck*

French Balcony & Outside Balcony, 210 sq. ft.

Brochure Fare ~~\$5,098~~ pp

Your rate \$4,348 pp

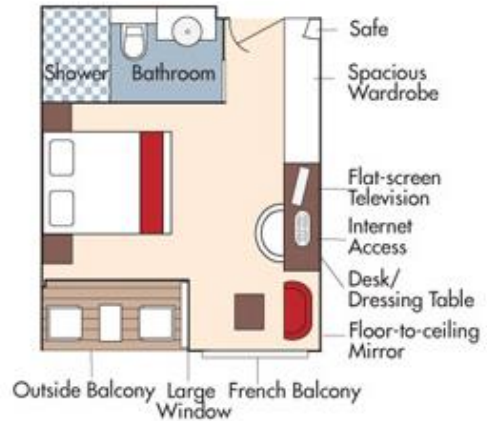





### Category BB *Cello Deck*

French Balcony & Outside Balcony, 210 sq. ft.

Brochure Fare ~~\$4,898~~ pp

Your rate **\$4,148** pp

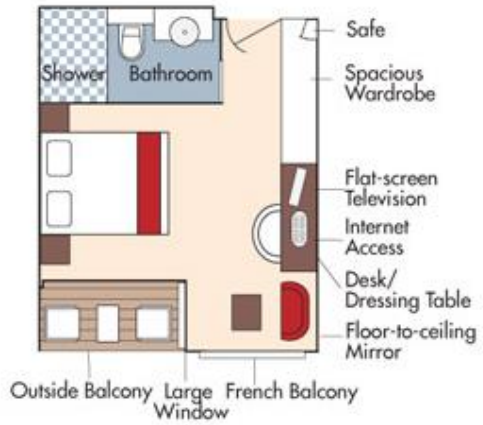

### Category CA *Violin & Cello Deck*

French Balcony, 170 sq. ft.

### Category CA

Brochure Fare ~~\$4,298~~ pp

Your rate **\$3,548** pp

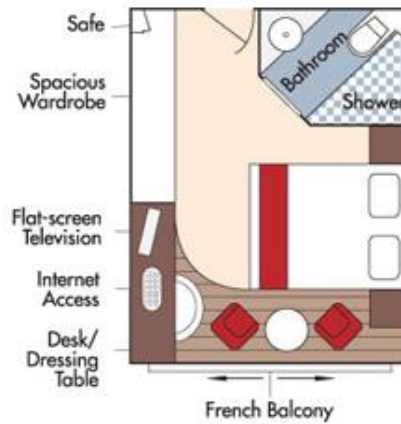

### Category CB *Violin Deck*

French Balcony, 155 sq. ft.

### Category CB

Brochure Fare ~~\$3,998~~ pp

Your rate **\$3,248** pp

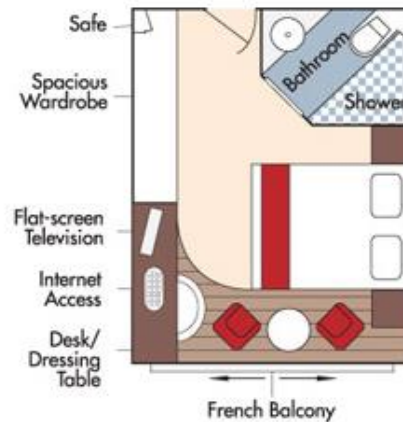

Fares listed are cruise-only, per person based on double occupancy and do not include port charges of \$210 per person.

**Category D** *Piano Deck*  
Fixed Windows, 160 sq. ft.



Brochure Fare **\$3,498 pp**  
Your rate **\$2,748 pp**

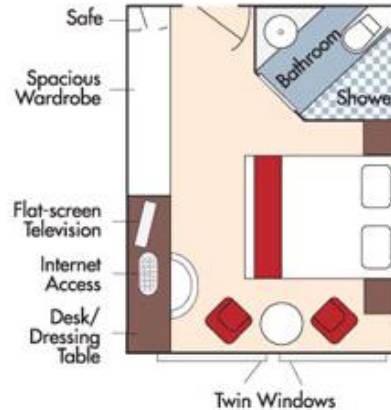

**Category E** *Piano Deck*  
Fixed Windows, 160 sq. ft.

Brochure Fare **\$3,199 pp**  
Your rate **\$2,449 pp**

*AmaSiena*  
**DECK PLAN**

- 1 Lower Sun Deck
- 2 Navigation Bridge
- 3 Bicycles
- 4 Heated Pool
- 5 Sun Deck
- 6 Walking Track
- 7 AI Fresco Terrace
- 8 Observation Lounge
- 9 Main Lounge & Bar
- 10 Gift Shop
- 11 Reception
- 12 The Chef's Table Restaurant
- 13 Main Restaurant
- 14 Elevator
- 15 Massage & Hair Salon
- 16 Fitness Room
- 17 Crew Cabins

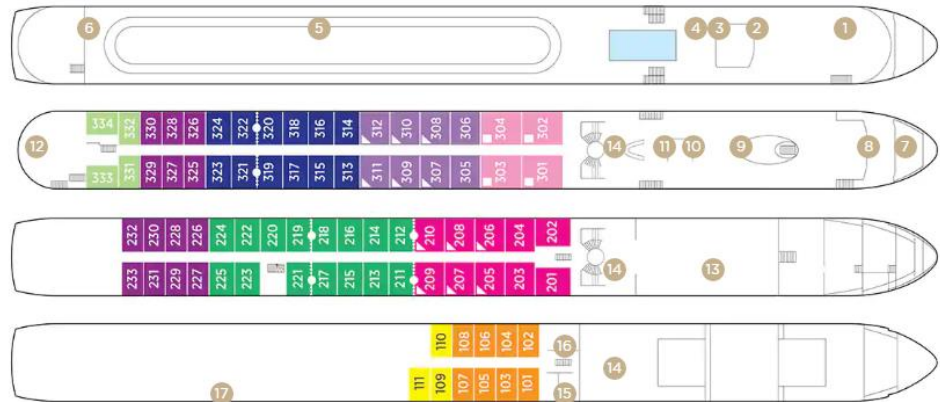

*Note: Elevator reaches the Violin, Cello and Piano Deck (does not reach the Sun Deck).*

..... Staterooms can become adjoining by request.

▲ Up to triple occupancy

Stateroom Categories



Fares listed are cruise-only, per person based on double occupancy and do not include port charges of \$210 per person.