



**Special Rates When Booked  
by November 30, 2020!**

# RIVER CRUISE FOR WINE LOVERS

## Ron Noble Wines

Aboard AmaSiena • 7 Nights • March 31 to April 7, 2022

Amsterdam • Cologne • Rudesheim • Ludwigshafen • Heidelberg • Strasbourg • Riquewihr • Breisach • Basel

*Note: Stateroom layouts shown below are not to scale.*



### Suite *Violin Deck*

French Balcony & Outside Balcony, 350 sq. ft.

Brochure Fare ~~\$6,698~~ pp

Your rate **\$6,198** pp

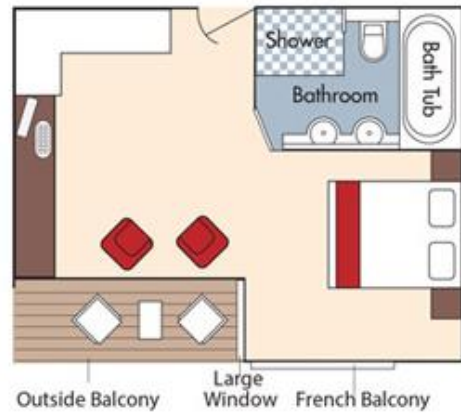

### Category AA *Violin Deck*

French Balcony & Outside Balcony, 235 sq. ft.

Brochure Fare ~~\$5,398~~ pp

Your rate **\$4,898** pp

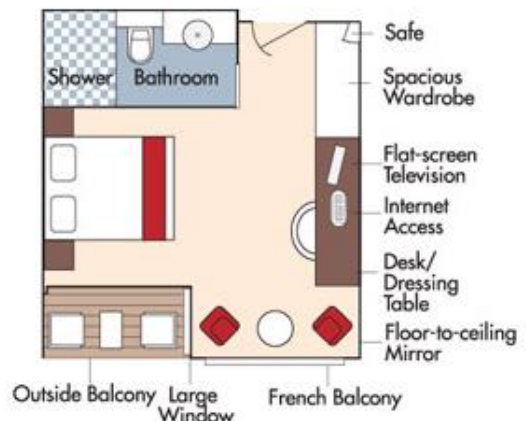

*Fares listed are cruise-only, per person based on double occupancy and do not include port charges of \$210 per person.*



### Category AB *Cello Deck*

French Balcony & Outside Balcony, 235 sq. ft.

Brochure Fare \$5,198 pp

Your rate \$4,698 pp

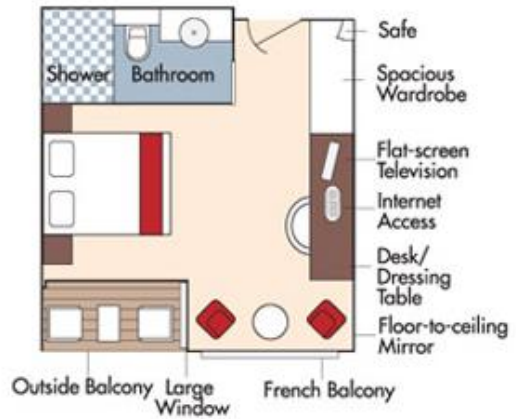

### Category BA *Violin Deck*

French Balcony & Outside Balcony, 210 sq. ft.

Brochure Fare \$4,998 pp

Your rate \$4,498 pp

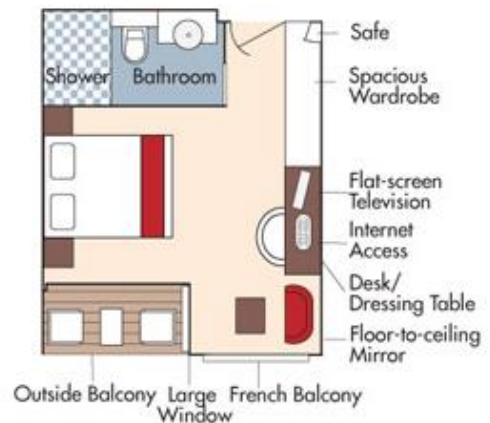



### Category BB *Cello Deck*

French Balcony & Outside Balcony, 210 sq. ft.

Brochure Fare \$4,798 pp

Your rate \$4,298 pp

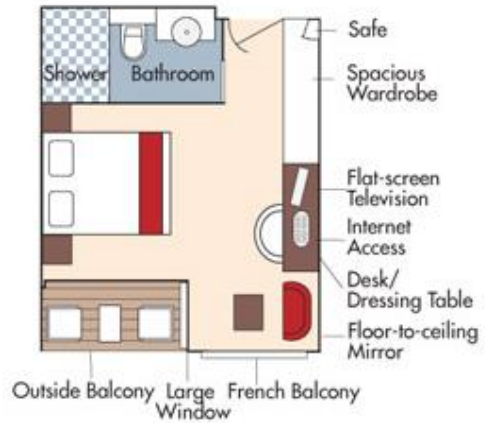

### Category CA *Violin & Cello Deck*

French Balcony, 170 sq. ft.

Category CA

Brochure Fare \$4,198 pp

Your rate \$3,698 pp

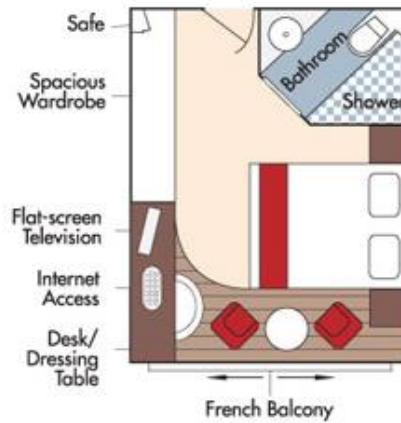

### Category CB *Violin Deck*

French Balcony, 155 sq. ft.

Category CB

Brochure Fare \$3,898 pp

Your rate \$3,398 pp

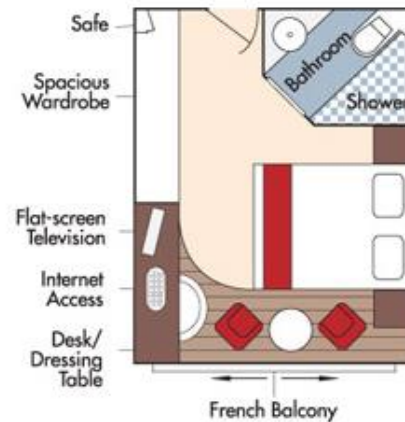

Fares listed are cruise-only, per person based on double occupancy and do not include port charges of \$210 per person.

**Category D** *Piano Deck*  
Fixed Windows, 160 sq. ft.



Brochure Fare **\$3,398 pp**  
Your rate **\$2,898 pp**

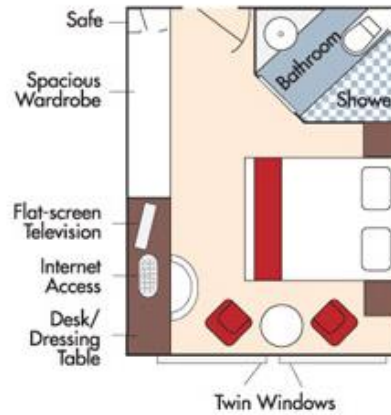

**Category E** *Piano Deck*  
Fixed Windows, 160 sq. ft.

Brochure Fare **\$3,099 pp**  
Your rate **\$2,599 pp**

*AmaSiena*  
**DECK PLAN**

- 1 Lower Sun Deck
- 2 Navigation Bridge
- 3 Bicycles
- 4 Heated Pool
- 5 Sun Deck
- 6 Walking Track
- 7 AI Fresco Terrace
- 8 Observation Lounge
- 9 Main Lounge & Bar
- 10 Gift Shop
- 11 Reception
- 12 The Chef's Table Restaurant
- 13 Main Restaurant
- 14 Elevator
- 15 Massage & Hair Salon
- 16 Fitness Room
- 17 Crew Cabins

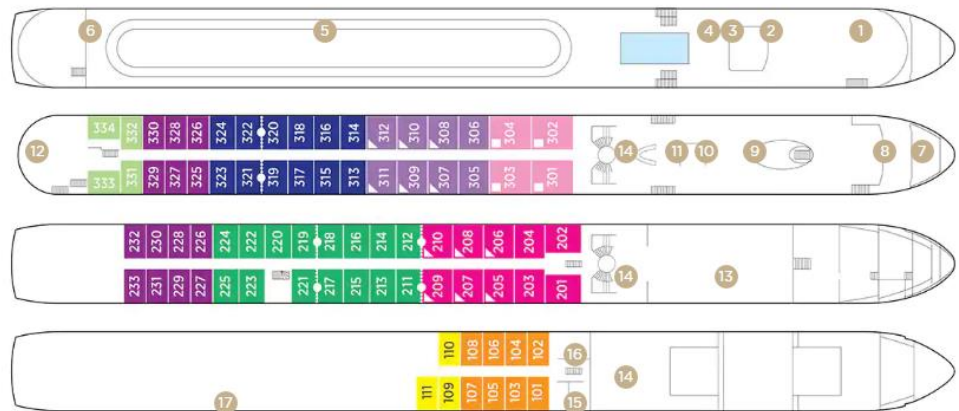

*Note: Elevator reaches the Violin, Cello and Piano Deck (does not reach the Sun Deck).*

.....  
Staterooms can become adjoining by request.

▲  
Up to triple occupancy

Stateroom Categories



Fares listed are cruise-only, per person based on double occupancy and do not include port charges of \$210 per person.