



Special Rates when you book by March 31, 2021

RIVER CRUISE FOR WINE LOVERS

Oak Knoll District Wine Cruise • April 7 – 14, 2022

Bordeaux • Libourne • Saint-Émilion • Blaye • Bourg • Pauillac • Cadillac

AmaDolce



Suite, Violin Deck
French Balcony, 255 sq. ft.

Note: Stateroom layouts shown below are not to scale.



Brochure Fare: ~~\$6,589~~ pp
Your Rate: \$6,339 pp



CAT. A+, Violin Deck
French Balcony, 225 sq. ft.

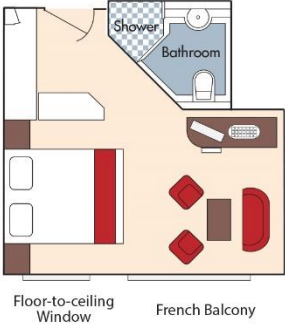

Brochure Fare: ~~\$6,298~~ pp
Your Rate: \$6,048 pp



CAT. A, Violin Deck
French Balcony, 170 sq. ft.

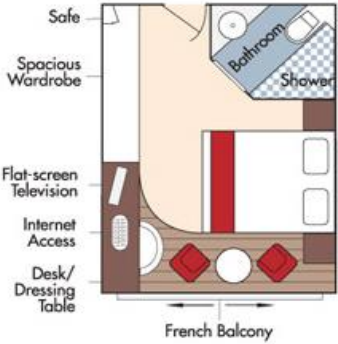

Brochure Fare: ~~\$5,298~~ pp
Your Rate: \$5,048 pp

Fares listed are cruise-only, per person based on double occupancy and do not include port charges of \$210 per person.

CAT. B, Violin & Cello Deck
French Balcony, 170 sq. ft.

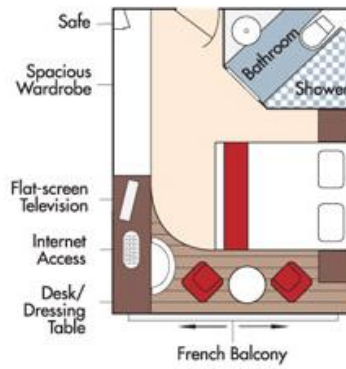

Brochure Fare: ~~\$5,198~~ pp
Your Rate: \$4,948 pp

CAT. C, Violin & Cello Deck
French Balcony, 170 sq. ft.

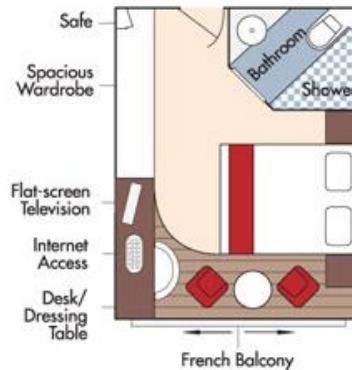

Brochure Fare: ~~\$4,898~~ pp
Your Rate: \$4,648 pp

CAT. E, Piano Deck
Fixed Windows, 170 sq. ft.



CAT. D, Piano Deck
Fixed Windows, 170 sq. ft.

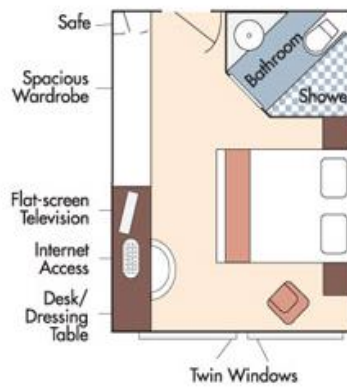

Category D
Brochure Fare: ~~\$4,098~~ pp
Your Rate: \$3,848 pp

Category E
Brochure Fare: ~~\$3,799~~ pp
Your Rate: \$3,549 pp

AmaDolce Deck Plan

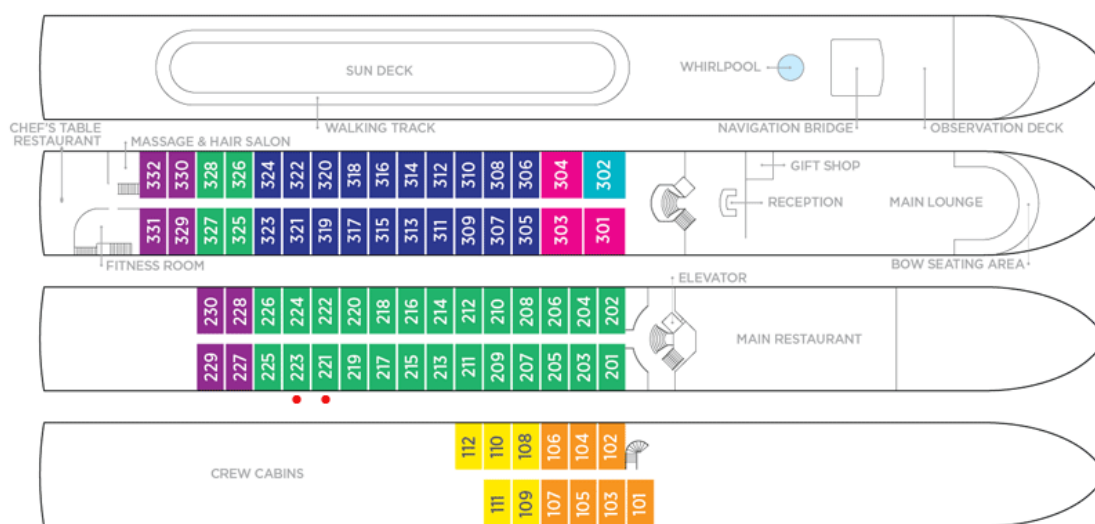

Fares listed are cruise-only, per person based on double occupancy and do not include port charges of \$210 per person.