



Special Rates when you book by March 31, 2021

RIVER CRUISE FOR WINE LOVERS

Petaluma Gap Winegrowers Alliance

Aboard AmaSonata • 7 Nights • March 25 to April 1, 2022

Vilshofen • Passau • Linz • Weissenkirchen • Vienna • Bratislava • Budapest

Note: Stateroom layouts shown below are not to scale.



Suite, Violin Deck
French Balcony & Outside Balcony, 350 sq. ft.

Brochure Fare \$6,598 pp
Your rate \$6,348 pp

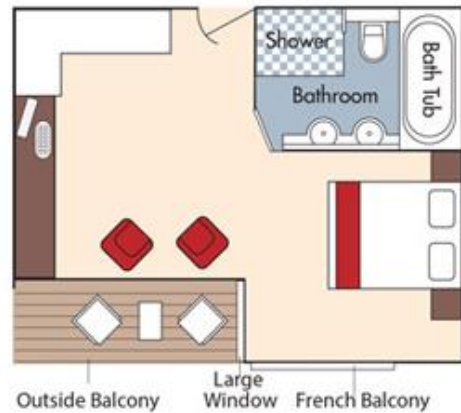

CAT. AA, Violin Deck
French Balcony & Outside Balcony, 235 sq. ft.

Brochure Fare \$5,298 pp
Your rate \$5,048 pp

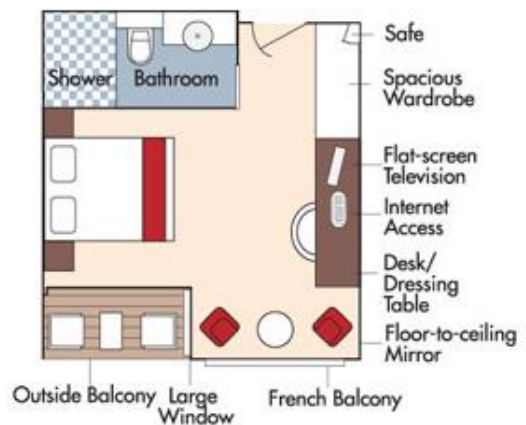

Fares listed are cruise-only, per person based on double occupancy and do not include port charges of \$210 per person.



CAT. AB, Cello Deck
French Balcony & Outside Balcony, 235 sq. ft.

Brochure Fare \$5,098 pp
Your rate \$4,848 pp

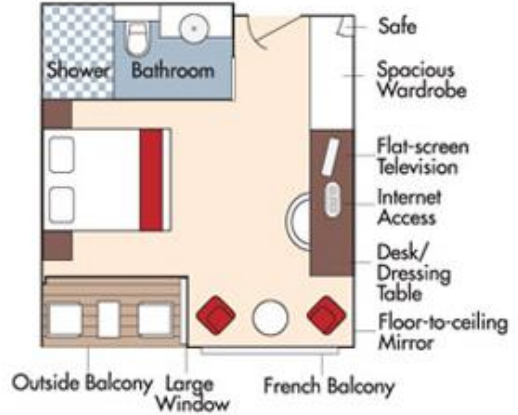

CAT. BA, Violin Deck
French Balcony & Outside Balcony, 210 sq. ft.

Brochure Fare \$4,898 pp
Your rate \$4,648 pp

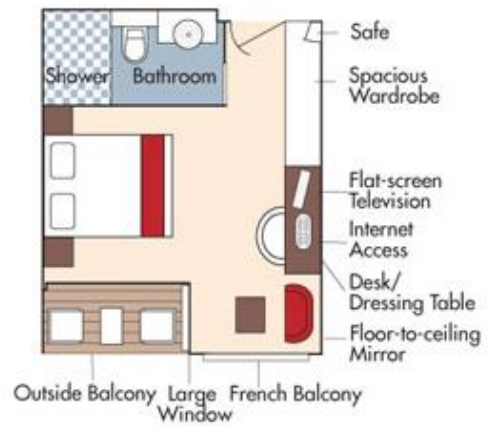



CAT. BB, Cello Deck
French Balcony & Outside Balcony, 210 sq. ft.

Brochure Fare \$4,698 pp
Your rate \$4,448 pp

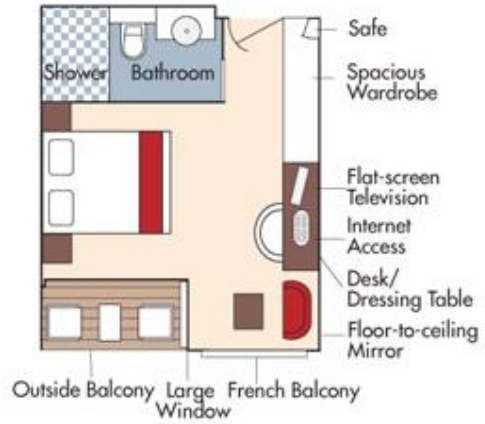

CAT. C, Violin & Cello Deck
French Balcony, 170 sq. ft.

Category C
Brochure Fare \$4,098 pp
Your rate \$3,848 pp

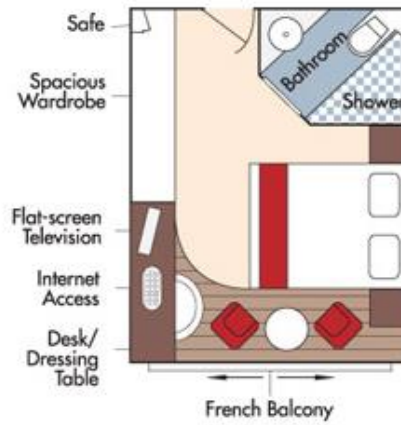



CAT. D, Piano Deck
Fixed Windows, 160 sq. ft.

Brochure Fare **\$3,298 pp**
Your rate **\$3,048 pp**

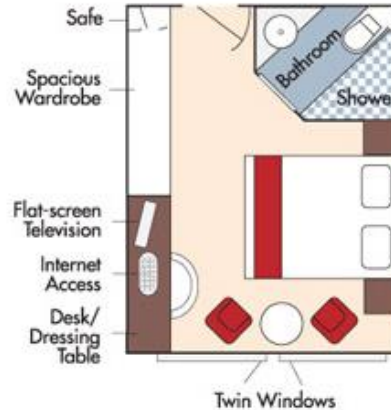

CAT. E, Piano Deck
Fixed Windows, 160 sq. ft.

Brochure Fare **\$2,999 pp**
Your rate **\$2,749 pp**

AmaSonata Deck Plan

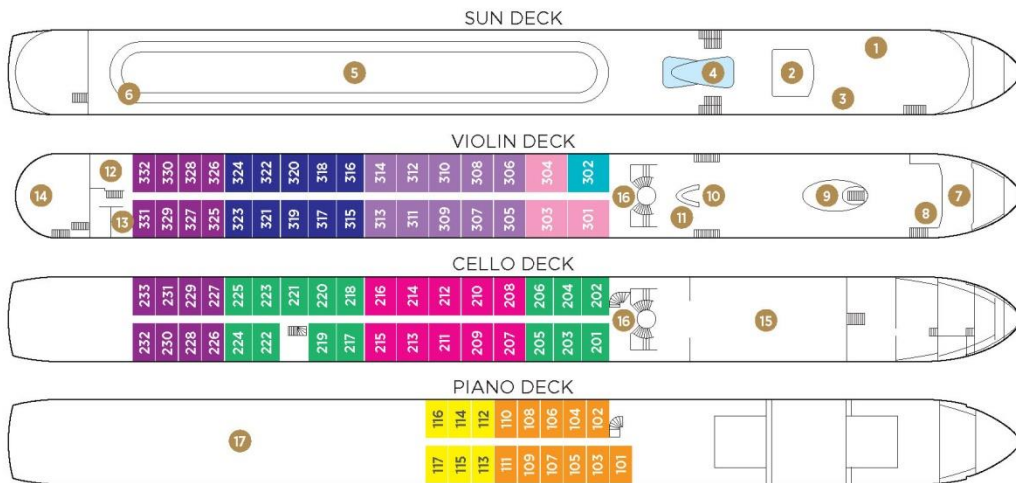

- 1 Lower Sun Deck
- 2 Navigation Bridge
- 3 Bicycles
- 4 Heated Pool
- 5 Sun Deck
- 6 Walking Track
- 7 Al Fresco Dining Terrace
- 8 Observation Lounge
- 9 Main Lounge & Bar
- 10 Gift Shop
- 11 Reception
- 12 Fitness Room
- 13 Massage & Hair Salon
- 14 The Chef's Table Restaurant
- 15 Main Restaurant
- 16 Elevator
- 17 Crew Cabins

Elevator reaches Main Restaurant, Lobby/Main Lounge and staterooms on Violin and Cello Deck.

Suite	Violin Deck / French & Outside Balcony - 300 sq. ft.	Cat. BB	Cello Deck / French & Outside Balcony - 210 sq. ft.
Cat. AA+	Violin Deck / French & Outside Balcony - 290 sq. ft.	Cat. C	Violin & Cello Deck / French Balcony - 170 sq. ft.
Cat. AA	Violin Deck / French & Outside Balcony - 235 sq. ft.	Cat. D	Piano Deck / Fixed Windows - 160 sq. ft.
Cat. AB	Cello Deck / French & Outside Balcony - 235 sq. ft.	Cat. E	Piano Deck / Fixed Windows - 160 sq. ft.
Cat. BA	Violin Deck / French & Outside Balcony - 210 sq. ft.		

Cat. AA+ slightly modified (i.e. no bathrub); refer to website for floorplan

Fares listed are cruise-only, per person based on double occupancy and do not include port charges of \$210 per person.