



Special Rates when you book by February 28, 2021

RIVER CRUISE FOR WINE LOVERS

Peterson Winery

Aboard AmaSiena • 7 Nights • April 7 to 14, 2022

Basel • Breisach • Strasbourg • Ludwigshafen • Rudesheim • Lahnstein • Cologne • Amsterdam

Note: Stateroom layouts shown below are not to scale.



Suite *Violin Deck*

French Balcony & Outside Balcony, 350 sq. ft.

Brochure Fare ~~\$6,798~~ pp

Your rate **\$6,048** pp

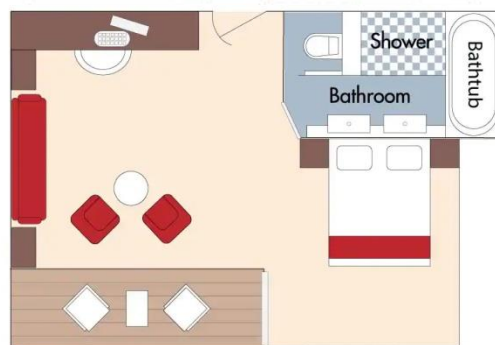

Outside Balcony Large Window French Balcony



Category AA *Violin Deck*

French Balcony & Outside Balcony, 235 sq. ft.

Brochure Fare ~~\$5,498~~ pp

Your rate **\$4,748** pp



Outside Balcony Large Window French Balcony

Fares listed are cruise-only, per person based on double occupancy and do not include port charges of \$210 per person.



Category AB *Cello Deck*

French Balcony & Outside Balcony, 235 sq. ft.

Brochure Fare ~~\$5,298~~ pp

Your rate **\$4,548** pp

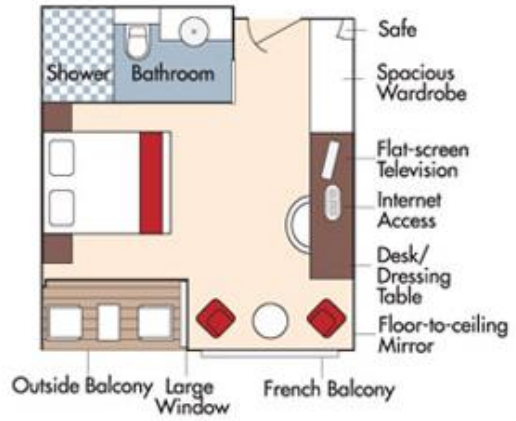

Category BA *Violin Deck*

French Balcony & Outside Balcony, 210 sq. ft.

Brochure Fare ~~\$5,098~~ pp

Your rate **\$4,348** pp

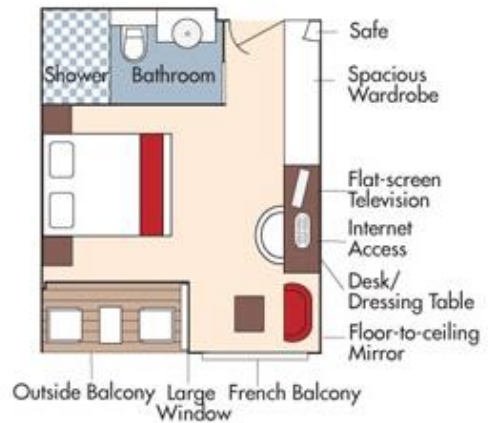



Category BB *Cello Deck*

French Balcony & Outside Balcony, 210 sq. ft.

Brochure Fare ~~\$4,898~~ pp

Your rate **\$4,148** pp

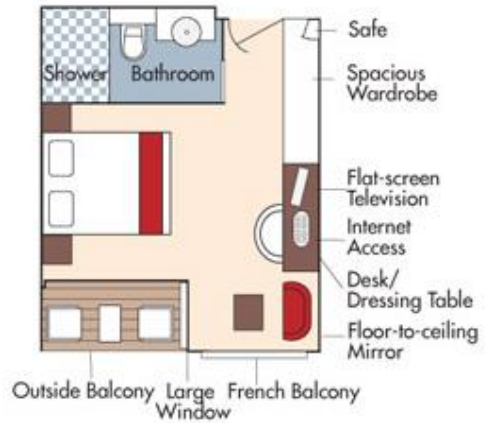

Category CA *Violin & Cello Deck*

French Balcony, 170 sq. ft.

Category CA

Brochure Fare ~~\$4,298~~ pp

Your rate **\$3,548** pp

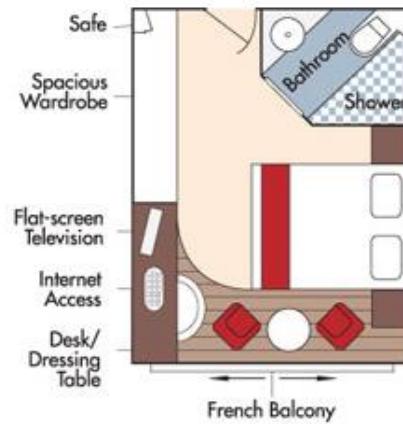

Category CB *Violin Deck*

French Balcony, 155 sq. ft.

Category CB

Brochure Fare ~~\$3,998~~ pp

Your rate **\$3,248** pp

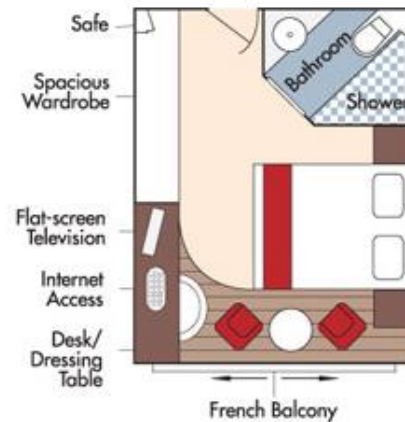

Fares listed are cruise-only, per person based on double occupancy and do not include port charges of \$210 per person.

Category D *Piano Deck*
Fixed Windows, 160 sq. ft.



Brochure Fare **\$3,498 pp**
Your rate **\$2,748 pp**

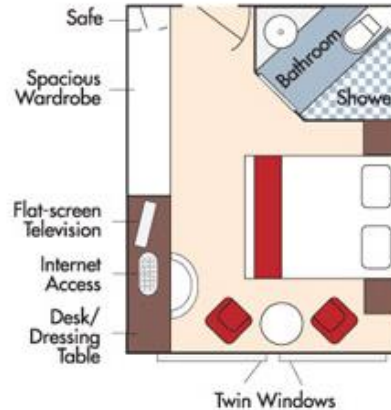

Category E *Piano Deck*
Fixed Windows, 160 sq. ft.

Brochure Fare **\$3,199 pp**
Your rate **\$2,449 pp**

AmaSiena
DECK PLAN

- 1 Lower Sun Deck
- 2 Navigation Bridge
- 3 Bicycles
- 4 Heated Pool
- 5 Sun Deck
- 6 Walking Track
- 7 AI Fresco Terrace
- 8 Observation Lounge
- 9 Main Lounge & Bar
- 10 Gift Shop
- 11 Reception
- 12 The Chef's Table Restaurant
- 13 Main Restaurant
- 14 Elevator
- 15 Massage & Hair Salon
- 16 Fitness Room
- 17 Crew Cabins

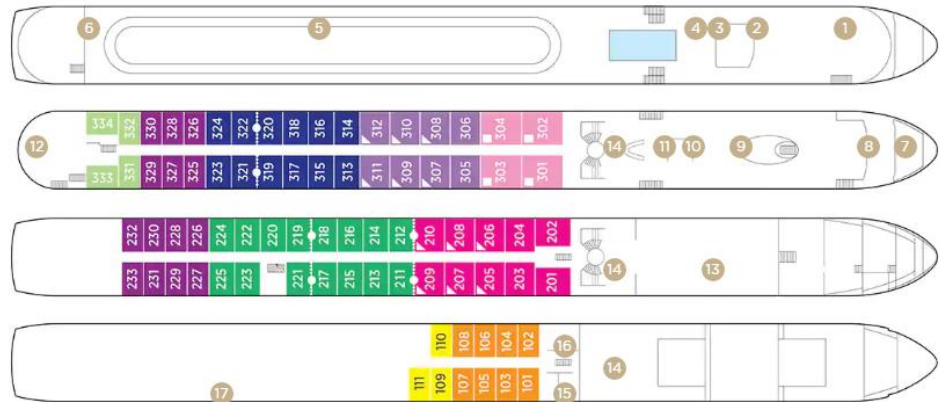

Note: Elevator reaches the Violin, Cello and Piano Deck (does not reach the Sun Deck).

..... Staterooms can become adjoining by request.

▲ Up to triple occupancy

Stateroom Categories



Fares listed are cruise-only, per person based on double occupancy and do not include port charges of \$210 per person.