



# RIVER CRUISE FOR WINE LOVERS

## Abacela Vineyards & Winery

Aboard AmaDouro • 7 Nights • August 7 to 14, 2021

Note: Stateroom layouts shown below are not to scale.

### Suite Porto Deck Balcony, 323 sq. ft.

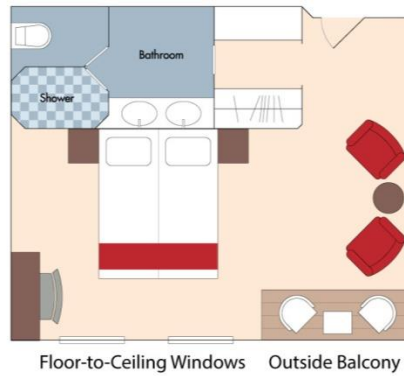

Your Rate: \$7,598 pp

### Category A Porto Deck Balcony, 215 sq. ft.

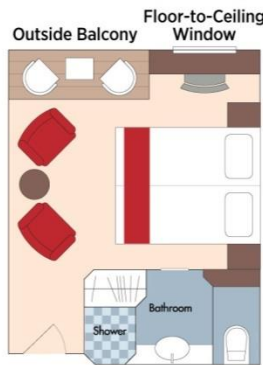

Your Rate: \$5,898 pp

### Category B Lisbon Deck Balcony, 215 sq. ft.

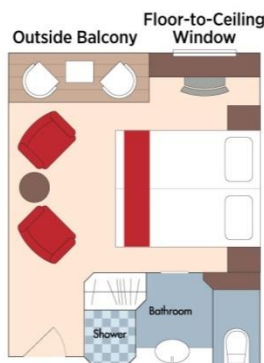

Your Rate: \$5,598 pp

Fares listed are cruise-only, per person based on double occupancy and do not include port charges of \$196 per person.

**Category C *Porto Deck*** French Balcony, 161 sq. ft.



French Balcony

Your Rate: \$4,998 pp

**Category D *Douro Deck*** Panoramic Window, 161 sq. ft.

**Category E *Douro Deck*** Panoramic Window, 161 sq. ft.



Category D

Your Rate: \$4,298 pp

Category E

Your Rate: \$3,999 pp

*AmaDouro*  
**DECK PLAN**

- 1 Main Lounge
- 2 Reception
- 3 Elevator
- 4 Main Restaurant
- 5 Fitness Room
- 6 Spa

Sun Deck

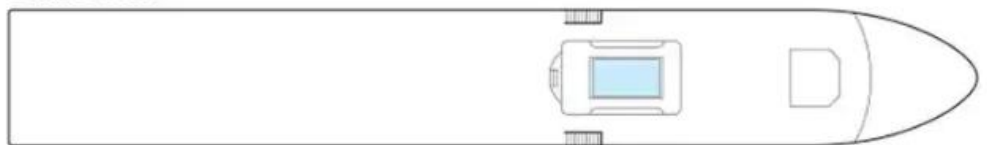

Porto Deck

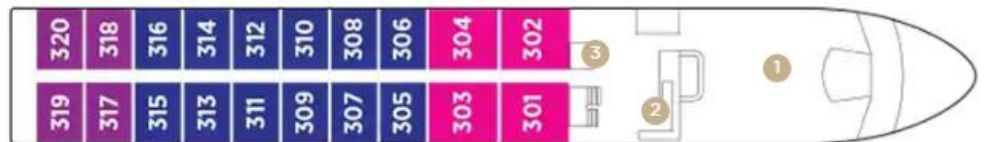

Lisbon Deck



Douro Deck



Stateroom Categories



Fares listed are cruise-only, per person based on double occupancy and do not include port charges of \$196 per person.