

DISCOVER THE GEMS OF SOUTHEAST EUROPE WITH CAST WINES AND COLLIER FALLS WINERY!

ABOARD AMAMAGNA • 7 NIGHTS • JUNE 26 TO JULY 3, 2022

Budapest, Hungary to Giurgiu, Romania

**Special Rates When You
Book By May 30, 2021**

Note: Stateroom layouts shown below are not to scale.

Category OS *Upper Deck*

Outside Balcony, 710 sq. ft.



Brochure Fare \$14,198 per person

Your Rate \$13,948 per person

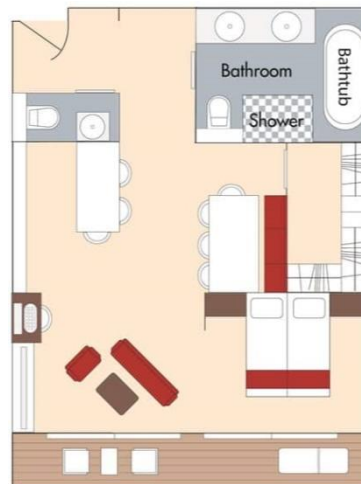

Outside Balcony

- In-room temperature control
- Spacious bathrooms with multi-jet showerheads
- Large wardrobe, full-length mirror, hair dryer, safe and direct-dial telephone
- Flat-screen TV that also works as a computer
- Entertainment on Demand system providing complimentary TV, movies and music library
- Complimentary bottled water replenished daily
- Complimentary internet and Wi-Fi
- Desk and chair

Category GS *Upper Deck*

Outside Balcony, 474 sq. ft.



Brochure Fare \$11,198 per person

Your Rate \$10,948 per person

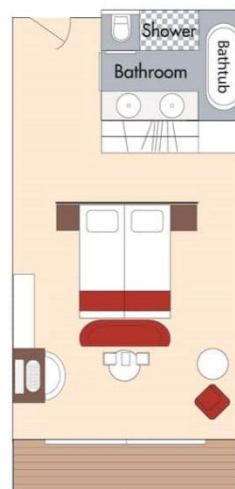

Outside Balcony

- In-room temperature control
- Spacious bathrooms with multi-jet showerheads
- Large wardrobe, full-length mirror, hair dryer, safe and direct-dial telephone
- Flat-screen TV that also works as a computer
- Entertainment on Demand system providing complimentary TV, movies and music library
- Complimentary bottled water replenished daily
- Complimentary internet and Wi-Fi
- Desk and chair

Category SA *Upper Deck*

Outside Balcony, 355 sq. ft.



Brochure Fare \$7,498 per person

Your Rate \$7,248 per person

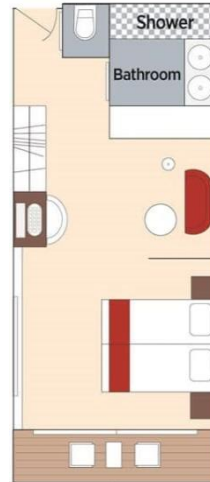

Outside Balcony

- In-room temperature control
- Spacious bathrooms with multi-jet showerheads
- Large wardrobe, full-length mirror, hair dryer, safe and direct-dial telephone
- Flat-screen TV that also works as a computer
- Entertainment on Demand system providing complimentary TV, movies and music library
- Complimentary bottled water replenished daily
- Complimentary internet and Wi-Fi
- Desk and chair

Category SB *Main Deck*

Outside Balcony, 355 sq. ft.



Brochure Fare \$6,898 per person

Your Rate \$6,648 per person

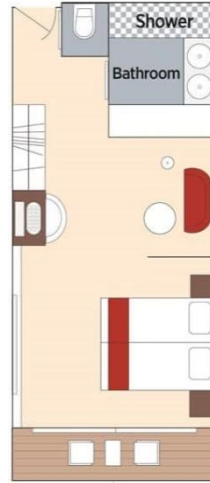

Outside Balcony

- In-room temperature control
- Spacious bathrooms with multi-jet showerheads
- Large wardrobe, full-length mirror, hair dryer, safe and direct-dial telephone
- Flat-screen TV that also works as a computer
- Entertainment on Demand system providing complimentary TV, movies and music library
- Complimentary bottled water replenished daily
- Complimentary internet and Wi-Fi
- Desk and chair

Category AA *Upper Deck*

Outside Balcony, 252 sq. ft.



Brochure Fare \$6,498 per person

Your Rate \$6,248 per person

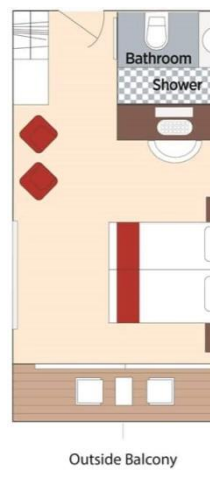

Outside Balcony

- In-room temperature control
- Spacious bathrooms with multi-jet showerheads
- Large wardrobe, full-length mirror, hair dryer, safe and direct-dial telephone
- Flat-screen TV that also works as a computer
- Entertainment on Demand system providing complimentary TV, movies and music library
- Complimentary bottled water replenished daily
- Complimentary internet and Wi-Fi
- Desk and chair

Category AB *Main Deck*

Outside Balcony, 252 sq. ft.



Brochure Fare \$6,298 per person

Your Rate \$6,048 per person

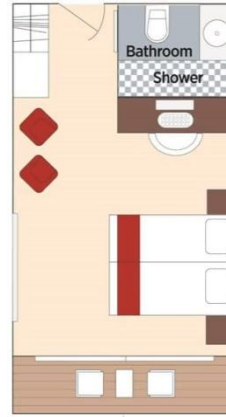

Outside Balcony

- In-room temperature control
- Spacious bathrooms with multi-jet showerheads
- Large wardrobe, full-length mirror, hair dryer, safe and direct-dial telephone
- Flat-screen TV that also works as a computer
- Entertainment on Demand system providing complimentary TV, movies and music library
- Complimentary bottled water replenished daily
- Complimentary internet and Wi-Fi
- Desk and chair

Category D *Lower Deck*

Fixed Window, 205 sq. ft.



Brochure Fare \$4,798 per person

Your Rate \$4,548 per person

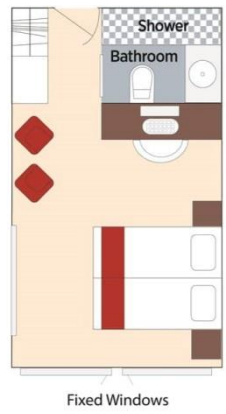

Fixed Windows

- In-room temperature control
- Spacious bathrooms with multi-jet showerheads
- Large wardrobe, full-length mirror, hair dryer, safe and direct-dial telephone
- Flat-screen TV that also works as a computer
- Entertainment on Demand system providing complimentary TV, movies and music library
- Complimentary bottled water replenished daily
- Complimentary internet and Wi-Fi
- Desk and chair

Category E *Lower Deck*

Fixed Window, 205 sq. ft.



Brochure Fare \$4,199 per person

Your Rate \$3,949 per person

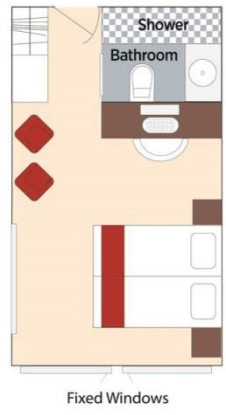

Fixed Windows

- In-room temperature control
- Spacious bathrooms with multi-jet showerheads
- Large wardrobe, full-length mirror, hair dryer, safe and direct-dial telephone
- Flat-screen TV that also works as a computer
- Entertainment on Demand system providing complimentary TV, movies and music library
- Complimentary bottled water replenished daily
- Complimentary internet and Wi-Fi
- Desk and chair

AmaMagna DECK PLAN

| | |
|----|---------------------------------|
| 1 | Pop-Up Sky Bar |
| 2 | Pool / Whirlpool |
| 3 | Walking Track |
| 4 | The <i>Al Fresco</i> Restaurant |
| 5 | Lower Lounge |
| 6 | Main Lounge |
| 7 | Elevator |
| 8 | Zen Wellness Studio |
| 9 | Massage Rooms |
| 10 | Main Restaurant |
| 11 | Reception |
| 12 | Water Sports Platform |
| 13 | Jimmy's Restaurant |
| 14 | The Chef's Table Restaurant |



Note: Elevator reaches the Violin, Cello and Piano Deck; pop-up lift available for Sun Deck access.

.....●.....
Staterooms can become adjoining by request.

▲
Up to triple and quad occupancy

Stateroom Categories

