



Special Rates when you book by June 30, 2021

# RIVER CRUISE FOR WINE LOVERS

## Davis Bynum

Aboard AmaPrima • 7 Nights • July 5 to 12, 2022

Luxembourg to Nuremberg

Note: Stateroom layouts shown below are not to scale.



Suite, Violin Deck  
French Balcony & Outside Balcony, 300 sq. ft.

Brochure Fare \$7,498 pp  
Your rate \$6,998 pp

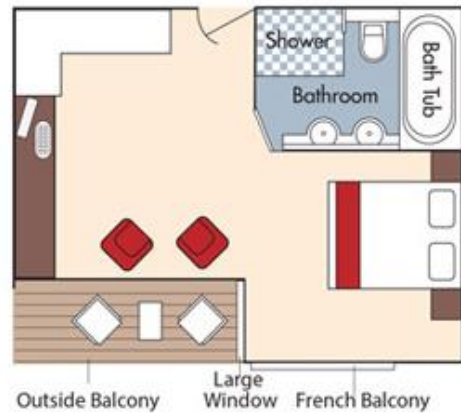

CAT. AA, Violin Deck  
French Balcony & Outside Balcony, 235 sq. ft.

Brochure Fare \$6,198 pp  
Your rate \$5,698 pp

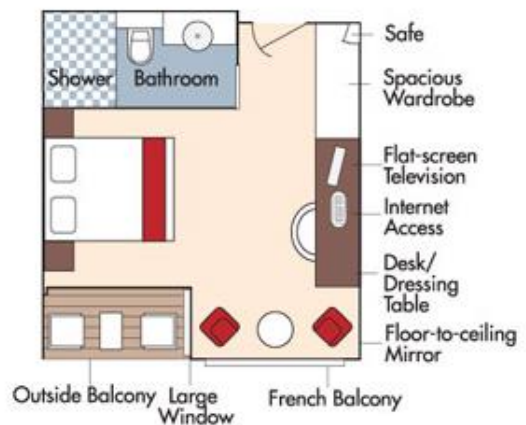

Fares listed are cruise-only, per person based on double occupancy and do not include port charges of \$210 per person.



**CAT. AB, Cello Deck**  
**French Balcony & Outside Balcony, 235 sq. ft.**

**Brochure Fare \$5,998 pp**  
**Your rate \$5,498 pp**

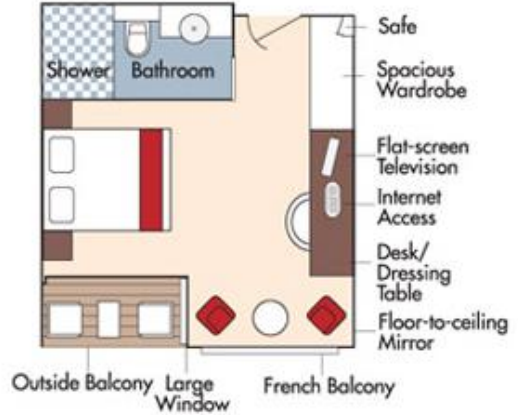

**CAT. BA, Violin Deck**  
**French Balcony & Outside Balcony, 210 sq. ft.**

**Brochure Fare \$5,798 pp**  
**Your rate \$5,298 pp**

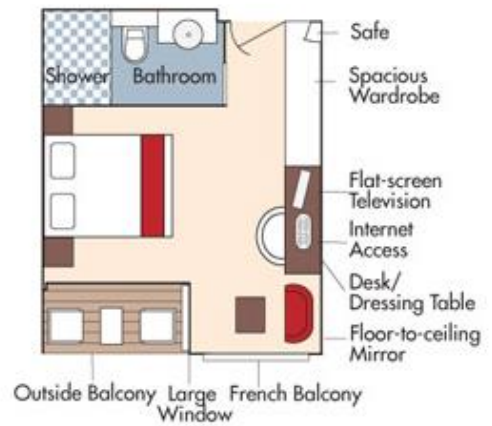



**CAT. BB, Cello Deck**  
**French Balcony & Outside Balcony, 210 sq. ft.**

**Brochure Fare \$5,598 pp**  
**Your rate \$5,098 pp**

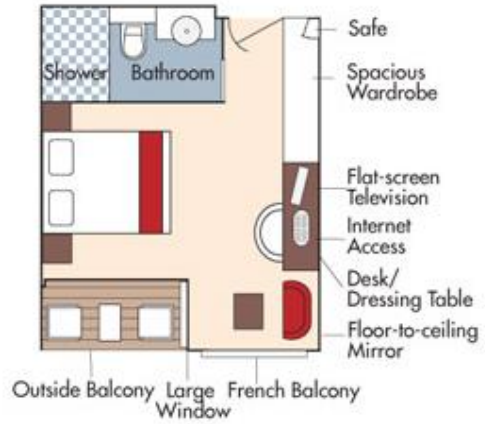

**CAT. C, Violin & Cello Deck**  
**French Balcony, 170 sq. ft.**

**Category C**  
**Brochure Fare \$4,998 pp**  
**Your rate \$4,498 pp**

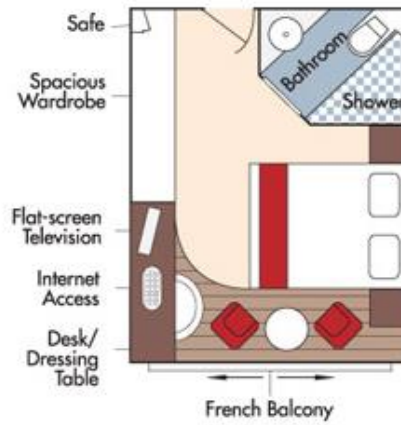



**CAT. D, Piano Deck**  
Fixed Windows, 160 sq. ft.

Brochure Fare **\$4,198 pp**  
Your rate **\$3,698 pp**

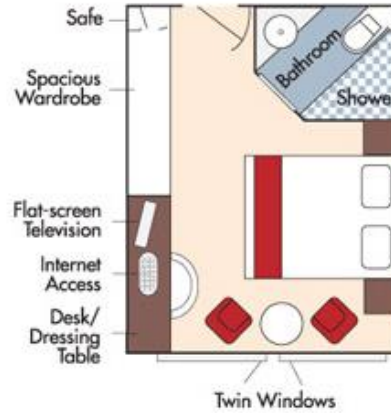

**CAT. E, Piano Deck**  
Fixed Windows, 160 sq. ft.

Brochure Fare **\$3,899 pp**  
Your rate **\$3,399 pp**

## AmaPrima DECK PLAN

1	Lower Sun Deck
2	Navigation Bridge
3	Bicycles
4	Heated Pool
5	Sun Deck
6	Walking Track
7	Al Fresco Dining Terrace
8	Observation Lounge
9	Main Lounge & Bar
10	Gift Shop
11	Reception
12	Fitness Room
13	Massage & Hair Salon
14	The Chef's Table Restaurant
15	Main Restaurant
16	Elevator
17	Crew Cabins

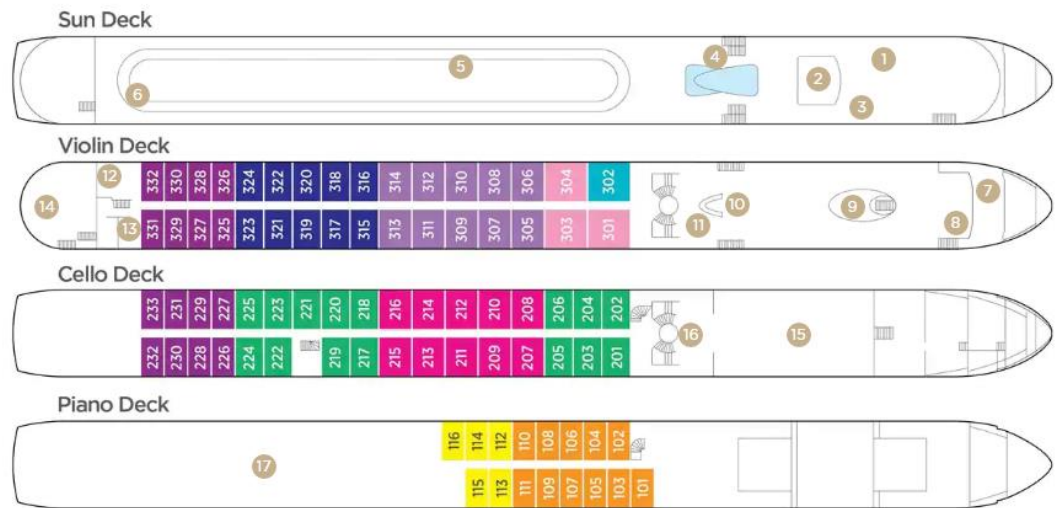

Note: Elevator reaches the Violin and Cello Deck (does not reach Piano Deck or Sun Deck).

### Stateroom Categories

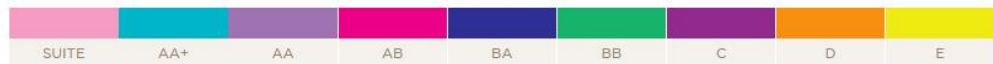

Fares listed are cruise-only, per person based on double occupancy and do not include port charges of \$210 per person.