



Special Rates when you book by June 30, 2021!

RIVER CRUISE FOR WINE LOVERS

Sonoma-Cutrer Vineyards

Aboard AmaBella • 7 Nights • April 4 to 11, 2022

Vilshofen • Passau • Linz • Weissenkirchen • Krems • Vienna • Esztergom • Budapest

Note: Stateroom layouts shown below are not to scale.



Suite, Violin Deck
French Balcony & Outside Balcony, 350 sq. ft.

Brochure Fare ~~\$6,798~~ pp
Your rate **\$6,298** pp

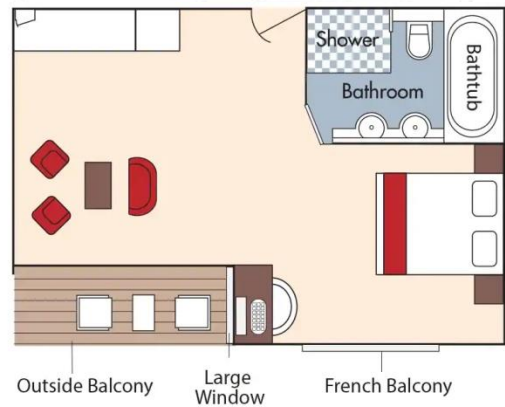

CAT. AA, Violin Deck
French Balcony & Outside Balcony, 235 sq. ft.

Brochure Fare ~~\$5,498~~ pp
Your rate **\$4,998** pp



Fares listed are cruise-only, per person based on double occupancy and do not include port charges of \$210 per person.



CAT. AB, Cello Deck
French Balcony & Outside Balcony, 235 sq. ft.

Brochure Fare \$5,298 pp
Your rate \$4,798 pp



CAT. BA, Violin Deck
French Balcony & Outside Balcony, 210 sq. ft.

Brochure Fare ~~\$5,098~~ pp
Your rate \$4,598 pp

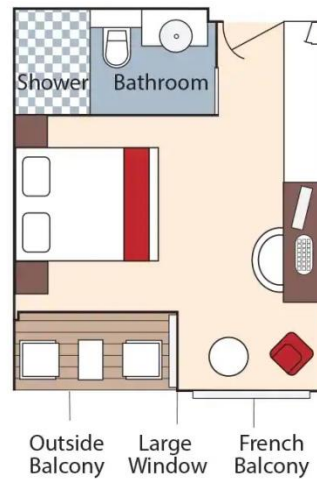



CAT. BB, Cello Deck
French Balcony & Outside Balcony, 210 sq. ft.

Brochure Fare \$4,898 pp
Your rate \$4,398 pp

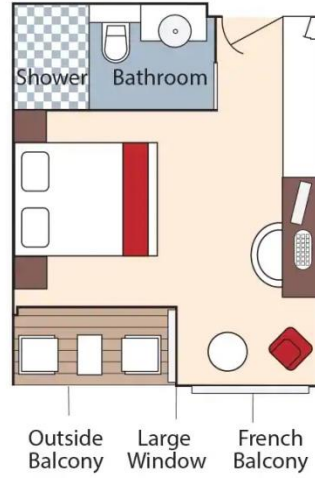

CAT. C, Violin & Cello Deck
French Balcony, 170 sq. ft.

Category C
Brochure Fare \$4,298 pp
Your rate \$3,798 pp

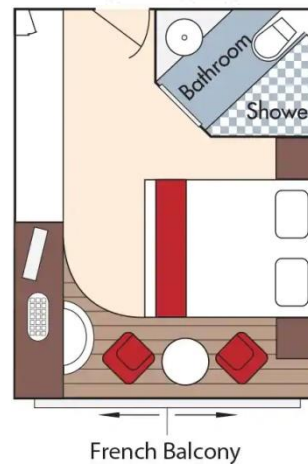



CAT. D, Piano Deck
Fixed Windows, 170 sq. ft.

Brochure Fare ~~\$3,498~~ pp
Your rate **\$2,998** pp

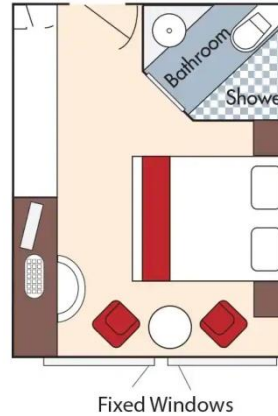

CAT. E, Piano Deck
Fixed Windows, 170 sq. ft.

Brochure Fare ~~\$3,199~~ pp
Your rate **\$2,699** pp

AmaBella DECK PLAN

1	Lower Sun Deck
2	Navigation Bridge
3	Bicycles
4	Heated Pool
5	Sun Deck
6	Walking Track
7	Putting Green
8	Bow Seating Area
9	Observation Lounge
10	Main Lounge & Bar
11	Gift Shop
12	Reception
13	Massage & Hair Salon
14	Fitness Room
15	The Chef's Table Restaurant
16	Main Restaurant
17	Elevator
18	Crew Cabins

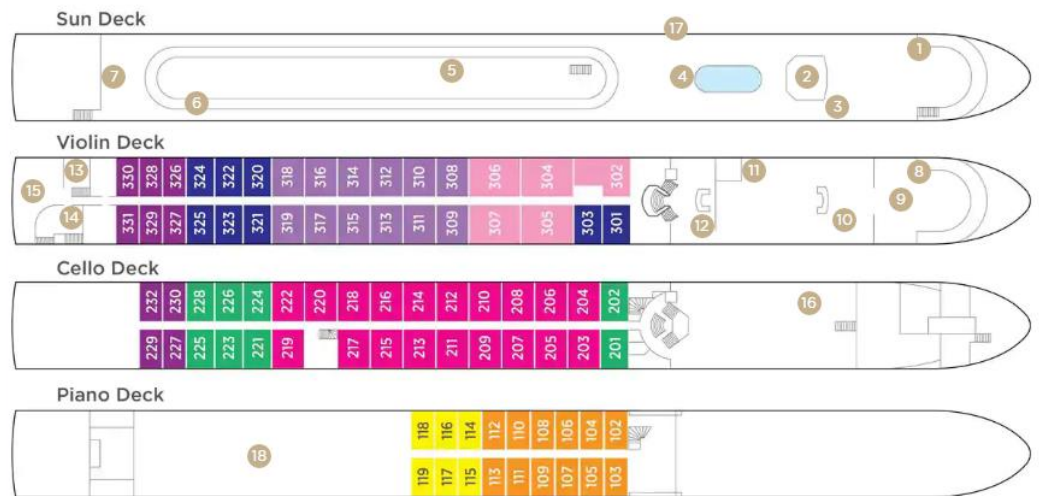

Stateroom Categories

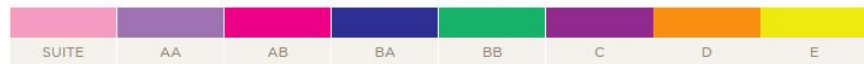

Fares listed are cruise-only, per person based on double occupancy and do not include port charges of \$210 per person.