



Special Rates when you book by October 31, 2021

RIVER CRUISE FOR WINE LOVERS

Davis Bynum

Aboard AmaPrima • 7 Nights • July 5 to 12, 2022

Luxembourg to Nuremberg

Note: Stateroom layouts shown below are not to scale.



Suite, Violin Deck
French Balcony & Outside Balcony, 300 sq. ft.

Brochure Fare \$7,498 pp
Your rate \$6,998 pp

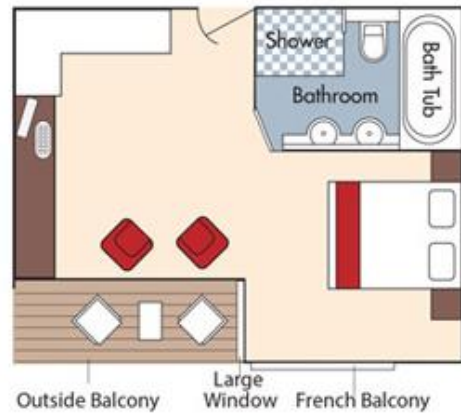

CAT. AA, Violin Deck
French Balcony & Outside Balcony, 235 sq. ft.

Brochure Fare \$6,198 pp
Your rate \$5,698 pp

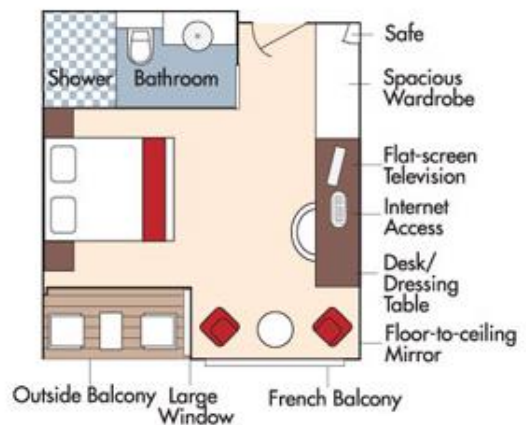

Fares listed are cruise-only, per person based on double occupancy and do not include port charges of \$210 per person.



CAT. AB, Cello Deck
French Balcony & Outside Balcony, 235 sq. ft.

Brochure Fare \$5,998 pp
Your rate \$5,498 pp

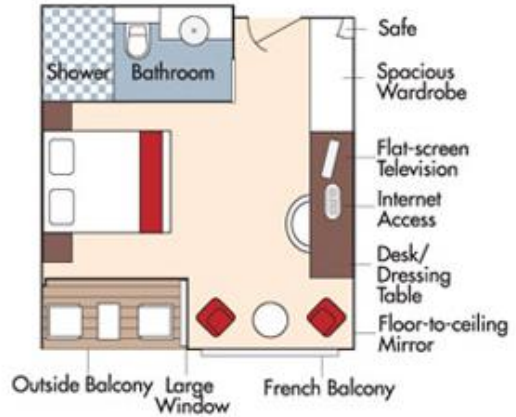

CAT. BA, Violin Deck
French Balcony & Outside Balcony, 210 sq. ft.

Brochure Fare \$5,798 pp
Your rate \$5,298 pp

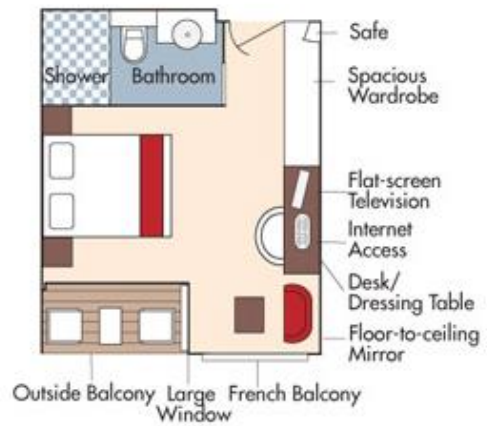



CAT. BB, Cello Deck
French Balcony & Outside Balcony, 210 sq. ft.

Brochure Fare \$5,598 pp
Your rate \$5,098 pp

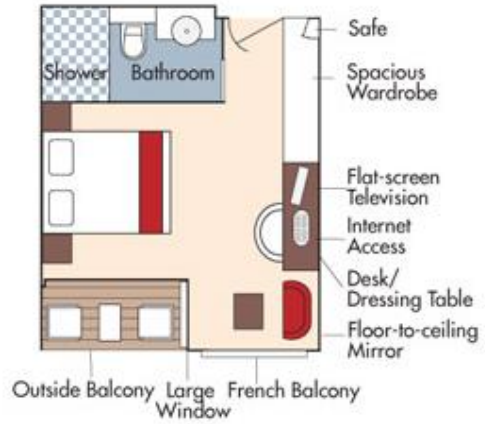

CAT. C, Violin & Cello Deck
French Balcony, 170 sq. ft.

Category C
Brochure Fare \$4,998 pp
Your rate \$4,498 pp

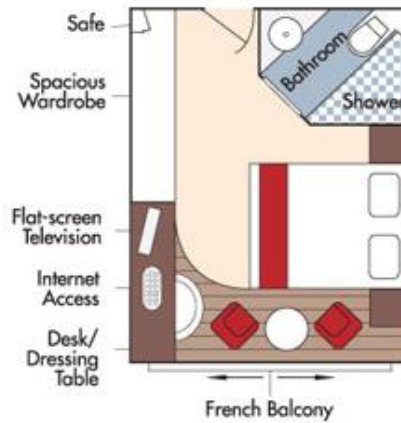



CAT. D, Piano Deck
Fixed Windows, 160 sq. ft.

Brochure Fare **\$4,198 pp**
Your rate **\$3,698 pp**

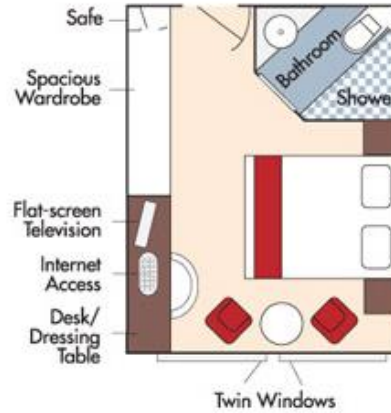

CAT. E, Piano Deck
Fixed Windows, 160 sq. ft.

Brochure Fare **\$3,899 pp**
Your rate **\$3,399 pp**

AmaPrima DECK PLAN

1	Lower Sun Deck
2	Navigation Bridge
3	Bicycles
4	Heated Pool
5	Sun Deck
6	Walking Track
7	Al Fresco Dining Terrace
8	Observation Lounge
9	Main Lounge & Bar
10	Gift Shop
11	Reception
12	Fitness Room
13	Massage & Hair Salon
14	The Chef's Table Restaurant
15	Main Restaurant
16	Elevator
17	Crew Cabins

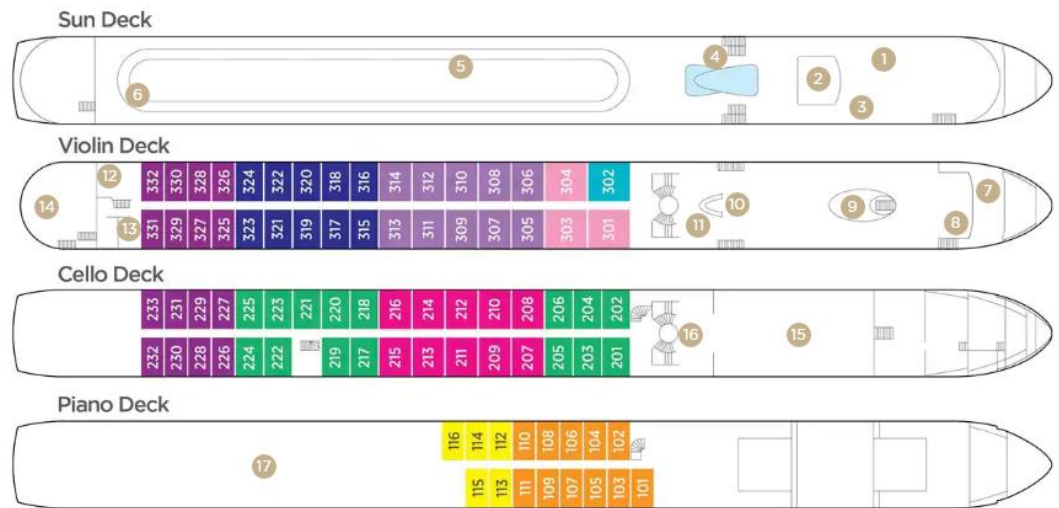

Note: Elevator reaches the Violin and Cello Deck (does not reach Piano Deck or Sun Deck).

Stateroom Categories

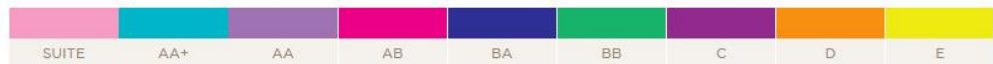

Fares listed are cruise-only, per person based on double occupancy and do not include port charges of \$210 per person.