

# SHARE A JOURNEY THROUGH SOUTHERN FRANCE WITH ST. FRANCIS, SEQUOIA GROVE AND RÉSONANCE WINERIES

Aboard AmaKristina • 7 Nights • July 14 to 21, 2022

Avignon • Tarascon • Viviers • Tournon • Vienne • Villefranche • Lyon

**Special Rates when you  
book by October 31, 2021**

*Note: Stateroom layouts shown below  
are not to scale.*

## Suite *Violin Deck*

French Balcony & Outside Balcony, 350 sq. ft.

Brochure Fare: \$7,798

**Your rate: \$7,548 pp**

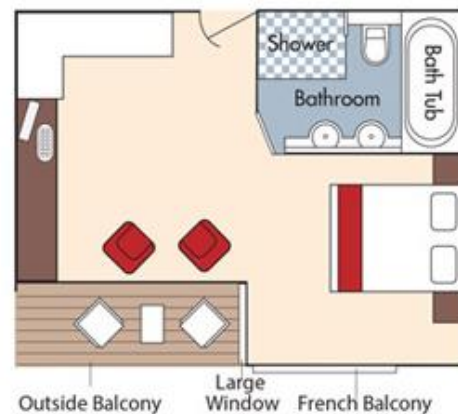

## Category AA *Violin Deck*

French Balcony & Outside Balcony, 235 sq. ft.

Brochure Fare: \$6,498

**Your rate: \$6,248 pp**

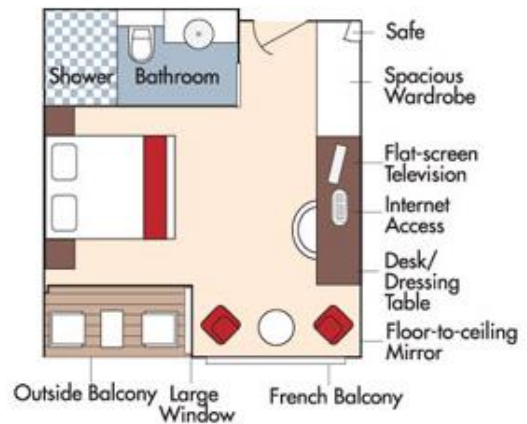

*Fares listed are cruise-only, per person based on double occupancy and include the exclusive wine package. Port charges of \$210 per person are additional.*



### Category AB *Cello Deck*

French Balcony & Outside Balcony, 235 sq. ft.

Brochure Fare: \$6,298

Your rate: \$6,048 pp

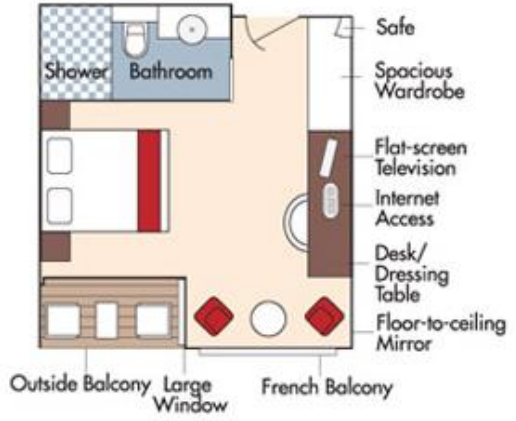

### Category BA *Violin Deck*

French Balcony & Outside Balcony, 210 sq. ft.

Brochure Fare: \$6,098

Your rate: \$5,848 pp

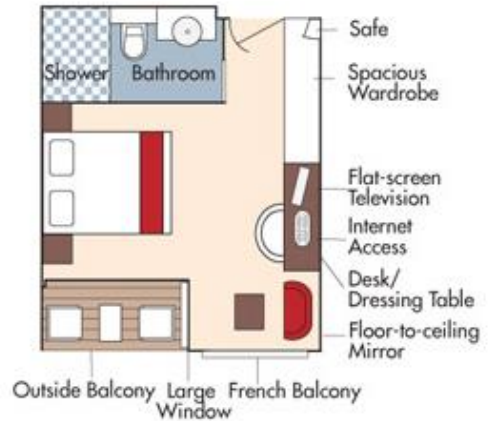



### Category BB *Cello Deck*

French Balcony & Outside Balcony, 210 sq. ft.

Brochure Fare: \$5,898

Your rate: \$5,648 pp

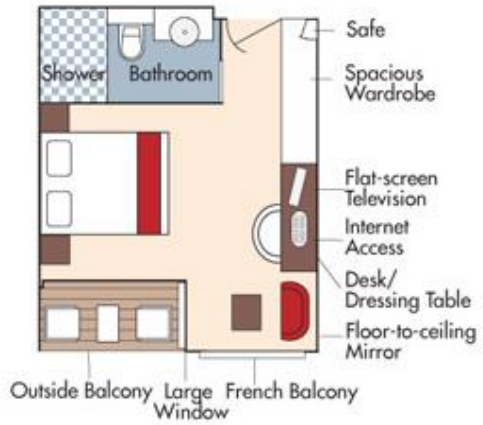

### Category CA *Violin & Cello Deck*

French Balcony, 170 sq. ft.

### Category CA

Brochure Fare: \$5,298

Your rate: \$5,048 pp

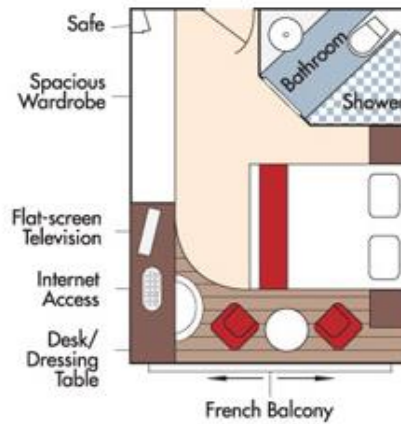

### Category CB *Violin Deck*

French Balcony, 155 sq. ft.

### Category CB

Brochure Fare: \$4,998

Your rate: \$4,748 pp

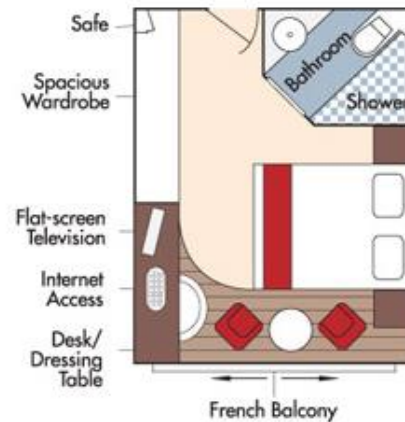

Fares listed are cruise-only, per person based on double occupancy and include the exclusive wine package. Port charges of \$210 per person are additional.



### Category D *Piano Deck*

Fixed Windows, 160 sq. ft.

Brochure Fare: \$4,498

Your rate: \$4,248 pp

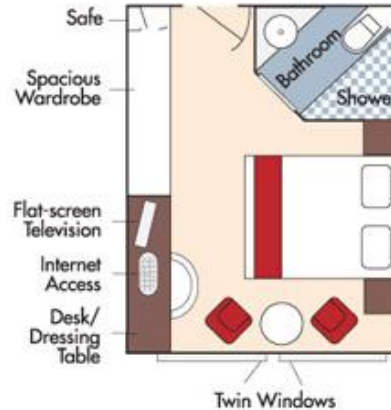

### Category E *Piano Deck*

Fixed Windows, 160 sq. ft.

Brochure Fare: 4,199

Your rate: \$3,949 pp

## AmaKristina DECK PLAN

1	Lower Sun Deck
2	Navigation Bridge
3	Bicycles
4	Heated Pool
5	Sun Deck
6	Walking Track
7	Al Fresco Terrace
8	Observation Lounge
9	Main Lounge & Bar
10	Gift Shop
11	Reception
12	The Chef's Table Restaurant
13	Main Restaurant
14	Elevator
15	Massage & Hair Salon
16	Fitness Room
17	Crew Cabins

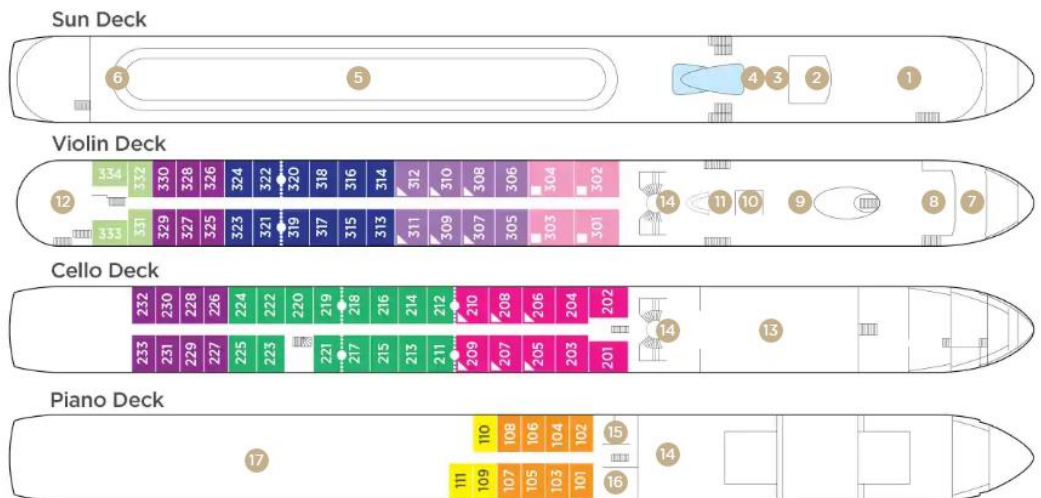

Note: Elevator reaches the Violin, Cello and Piano Deck (does not reach the Sun Deck).

Staterooms can become adjoining by request.

Up to triple occupancy

Stateroom Categories



Fares listed are cruise-only, per person based on double occupancy and include the exclusive wine package. Port charges of \$210 per person are additional.