

# WINE CRUISE THROUGH SOUTHERN FRANCE WITH COLLIER FALLS WINERY

Aboard AmaKristina • 7 Nights • June 22 to 29, 2023  
Lyon • Villefranche-sur-Saone • Vienne • Tournon • Tarascon • Avignon

*Note: Stateroom layouts shown below are not to scale.*

**Suite** *Violin Deck*  
French Balcony & Outside Balcony, 350 sq. ft.

**Wine Cruise Rate \$7,798 pp**

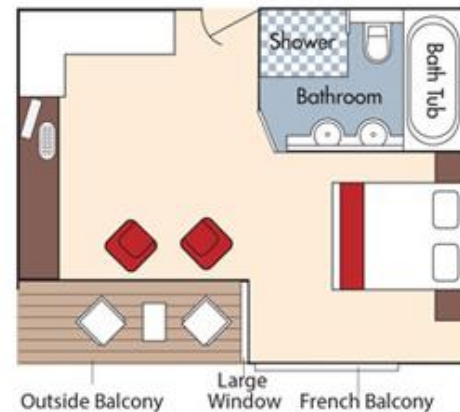

**Category AA** *Violin Deck*  
French Balcony & Outside Balcony, 235 sq. ft.

**Wine Cruise Rate \$6,498 pp**

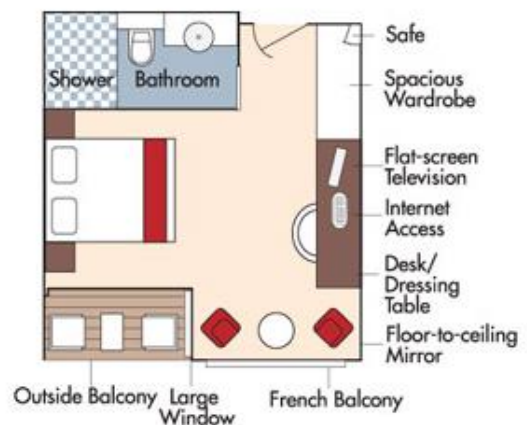

*Fares listed are cruise-only, per person based on double occupancy and do not include port charges of \$210 per person.*



### Category AB *Cello Deck*

French Balcony & Outside Balcony, 235 sq. ft.

Wine Cruise Rate \$6,298 pp

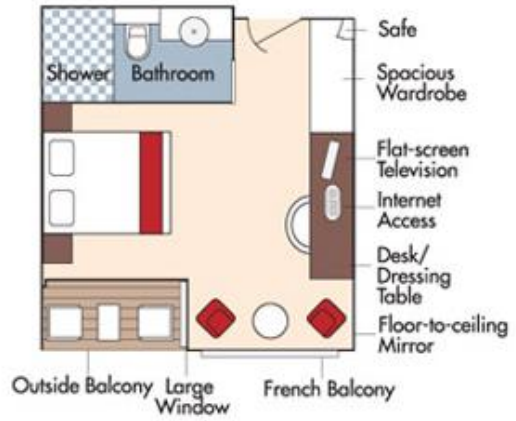

### Category BA *Violin Deck*

French Balcony & Outside Balcony, 210 sq. ft.

Wine Cruise Rate \$6,098 pp

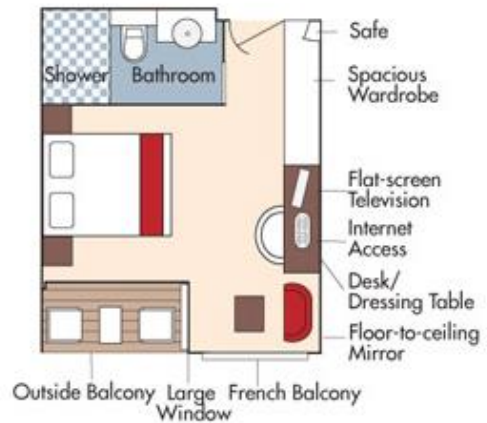



## Category BB *Cello Deck*

French Balcony & Outside Balcony, 210 sq. ft.

Wine Cruise Rate \$5,898 pp

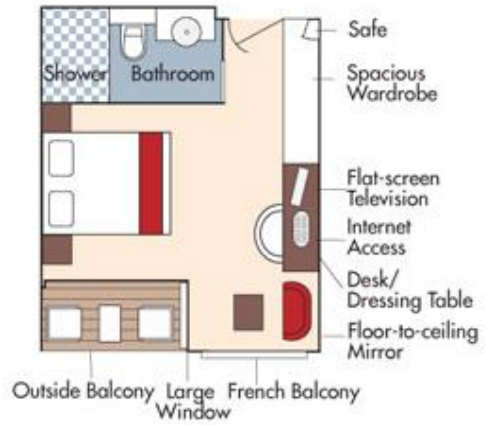

## Category CA *Violin & Cello Deck*

French Balcony, 170 sq. ft.

## Category CA

Wine Cruise Rate \$5,298 pp

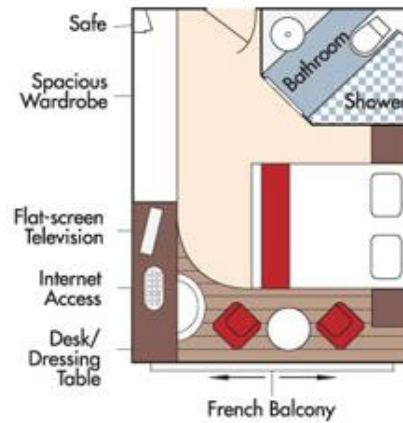

## Category CB *Violin Deck*

French Balcony, 155 sq. ft.

## Category CB

Wine Cruise Rate \$4,998 pp

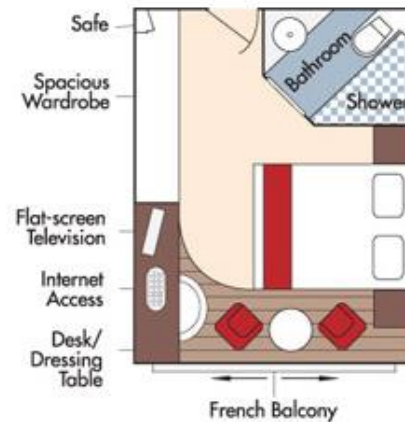

Fares listed are cruise-only, per person based on double occupancy and do not include port charges of \$210 per person.



### Category D *Piano Deck*

Fixed Windows, 160 sq. ft.

Wine Cruise Rate \$4,498 pp

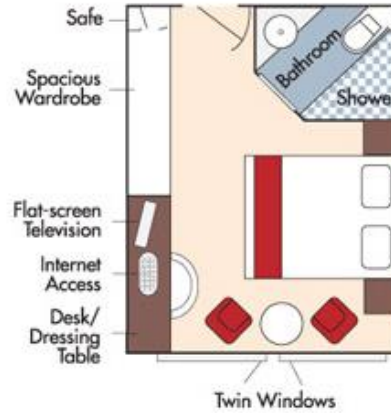

### Category E *Piano Deck*

Fixed Windows, 160 sq. ft.

Wine Cruise Rate \$4,199 pp

## AmaKristina DECK PLAN

- 1 Lower Sun Deck
- 2 Navigation Bridge
- 3 Bicycles
- 4 Heated Pool
- 5 Sun Deck
- 6 Walking Track
- 7 Al Fresco Terrace
- 8 Observation Lounge
- 9 Main Lounge & Bar
- 10 Gift Shop
- 11 Reception
- 12 The Chef's Table Restaurant
- 13 Main Restaurant
- 14 Elevator
- 15 Massage & Hair Salon
- 16 Fitness Room
- 17 Crew Cabins

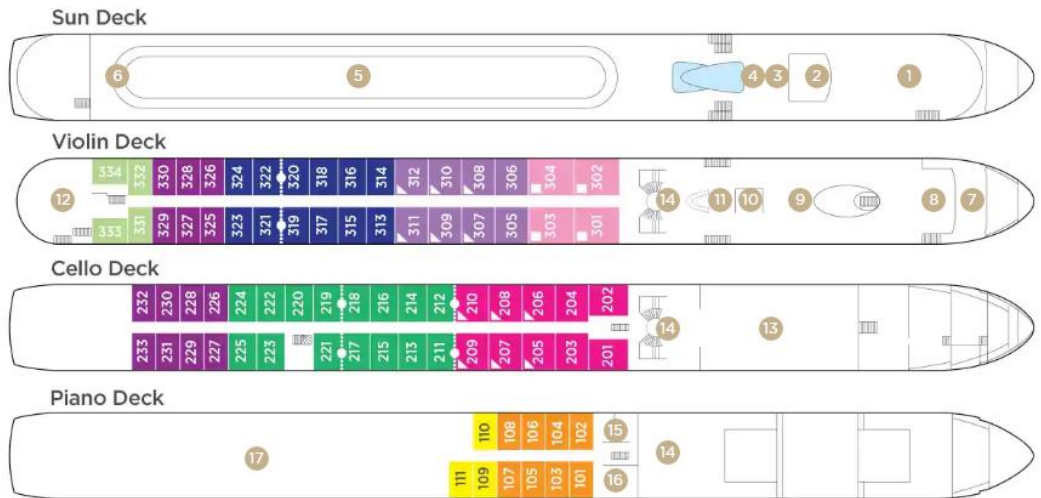

Note: Elevator reaches the Violin, Cello and Piano Deck (does not reach the Sun Deck).

Staterooms can become adjoining by request.

Up to triple occupancy

#### Stateroom Categories



Fares listed are cruise-only, per person based on double occupancy and do not include port charges of \$210 per person.