



RIVER CRUISE FOR WINE LOVERS

Abacela Vineyards & Winery

Aboard AmaVerde • 7 Nights • August 8 to 15, 2022

Budapest, Hungary to Giurgiu, Romania

Note: Stateroom layouts shown below are not to scale.



Suite, Violin Deck
French Balcony & Outside Balcony, 350 sq. ft.

Wine Cruise Rate \$7,498 pp

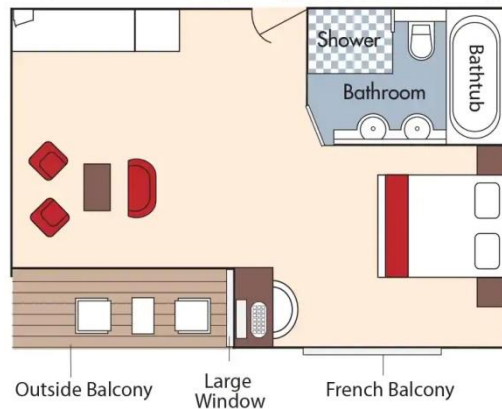

CAT. AA, Violin Deck
French Balcony & Outside Balcony, 235 sq. ft.

Wine Cruise Rate \$6,198 pp

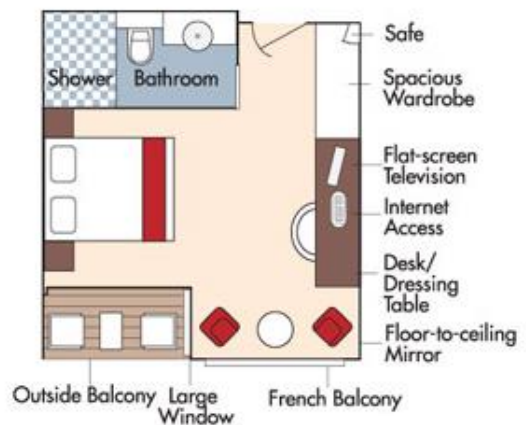

Fares listed are cruise-only, per person based on double occupancy and do not include port charges of \$210 per person.



CAT. AB, Cello Deck
French Balcony & Outside Balcony, 235 sq. ft.

Wine Cruise Rate \$5,998 pp

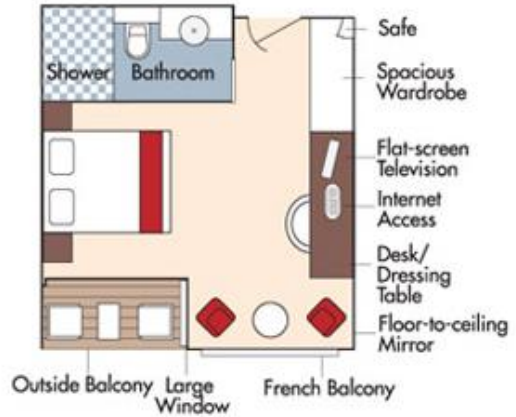

CAT. BA, Violin Deck
French Balcony & Outside Balcony, 210 sq. ft.

Wine Cruise Rate \$5,798 pp

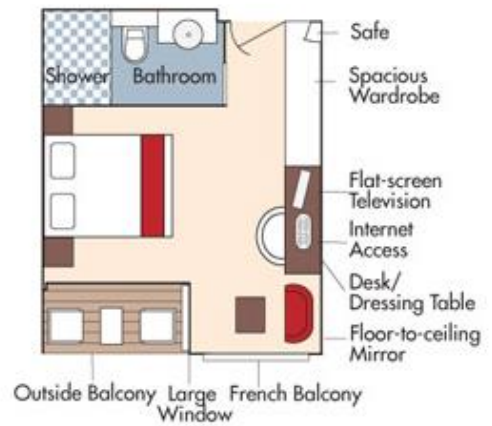



CAT. BB, Cello Deck
French Balcony & Outside Balcony, 210 sq. ft.

Wine Cruise Rate \$5,598 pp

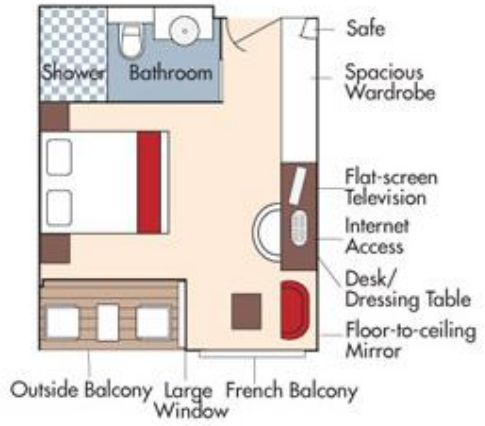

CAT. C, Violin & Cello Deck
French Balcony, 170 sq. ft.

Wine Cruise Rate \$4,998 pp

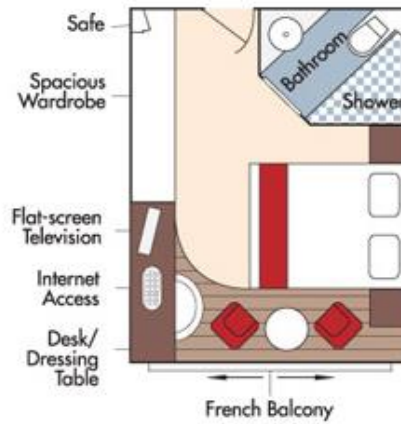



CAT. D, Piano Deck
Fixed Windows, 170 sq. ft.

Wine Cruise Rate \$4,198 pp

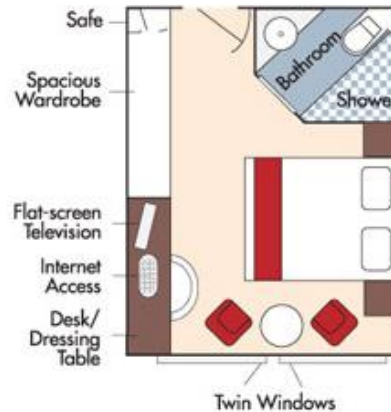

CAT. E, Piano Deck
Fixed Windows, 170 sq. ft.

Wine Cruise Rate \$3,899 pp

AmaVerde DECK PLAN

- 1 Lower Sun Deck
- 2 Navigation Bridge
- 3 Bicycles
- 4 Heated Pool
- 5 Sun Deck
- 6 Walking Track
- 7 Putting Green
- 8 Bow Seating Area
- 9 Observation Lounge
- 10 Main Lounge & Bar
- 11 Gift Shop
- 12 Reception
- 13 Massage & Hair Salon
- 14 Fitness Room
- 15 The Chef's Table Restaurant
- 16 Main Restaurant
- 17 Elevator
- 18 Crew Cabins

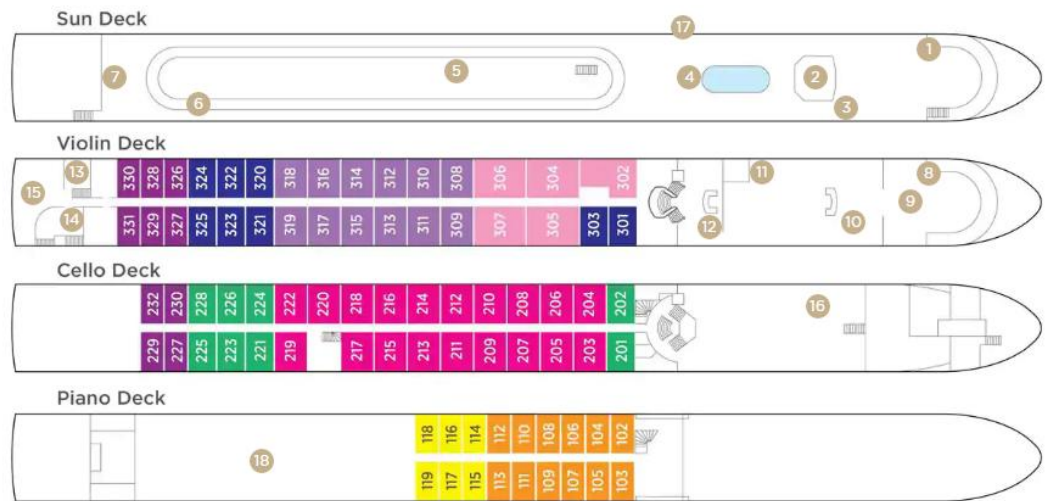

Stateroom Categories

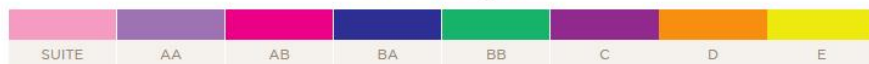

Fares listed are cruise-only, per person based on double occupancy and do not include port charges of \$210 per person.