

SHARE A JOURNEY THROUGH SOUTHERN FRANCE WITH ST. FRANCIS, SEQUOIA GROVE AND RÉSONANCE WINERIES

Aboard AmaKristina • 7 Nights • July 14 to 21, 2022

Avignon • Tarascon • Viviers • Tournon • Vienne • Villefranche • Lyon

Note: Stateroom layouts shown below are not to scale.



Suite *Violin Deck*

French Balcony & Outside Balcony, 350 sq. ft.

Wine Cruise Rate: \$7,798 pp

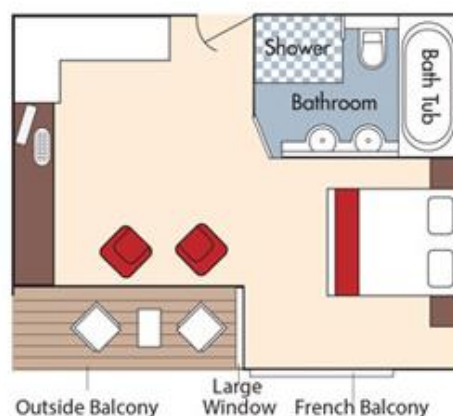

Category AA *Violin Deck*

French Balcony & Outside Balcony, 235 sq. ft.

Wine Cruise Rate: \$6,498 pp

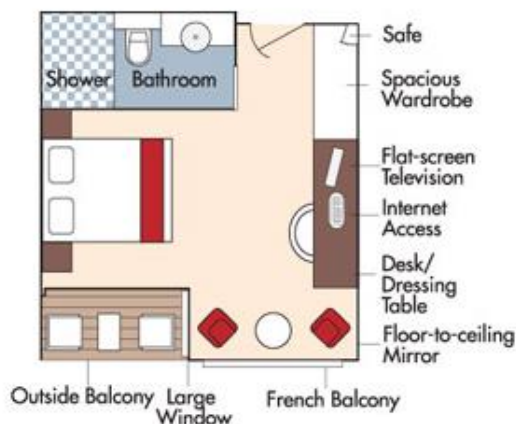

Fares listed are cruise-only, per person based on double occupancy and include the exclusive wine package. Port charges of \$210 per person are additional.



Category AB *Cello Deck*

French Balcony & Outside Balcony, 235 sq. ft.

Wine Cruise Rate: \$6,298 pp

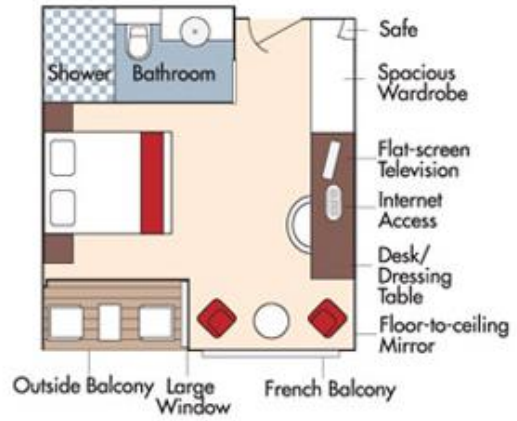

Category BA *Violin Deck*

French Balcony & Outside Balcony, 210 sq. ft.

Wine Cruise Rate: \$6,098 pp

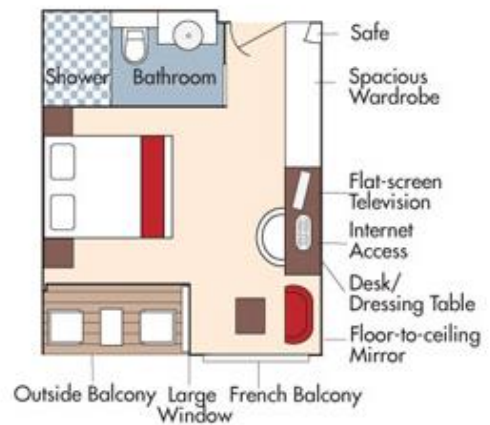



Category BB *Cello Deck*

French Balcony & Outside Balcony, 210 sq. ft.

Wine Cruise Rate: \$5,898 pp

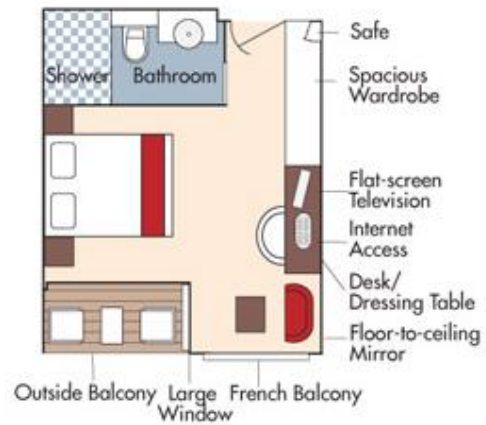

Category CA *Violin & Cello Deck*

French Balcony, 170 sq. ft.

Category CA

Wine Cruise Rate: \$5,298 pp

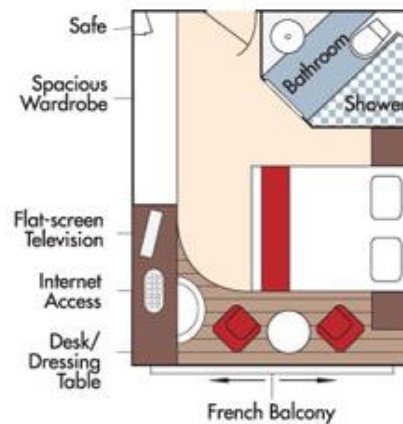

Category CB *Violin Deck*

French Balcony, 155 sq. ft.

Category CB

Wine Cruise Rate: \$4,998 pp

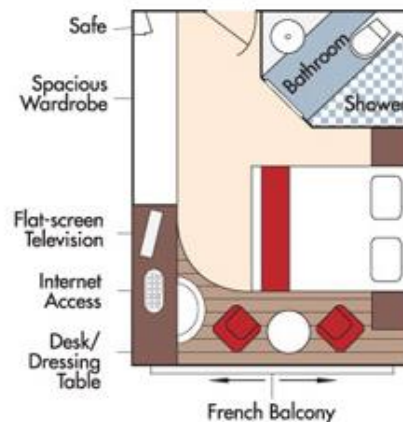

Fares listed are cruise-only, per person based on double occupancy and include the exclusive wine package. Port charges of \$210 per person are additional.

Category D *Piano Deck*

Fixed Windows, 160 sq. ft.

Wine Cruise Rate: \$4,498 pp

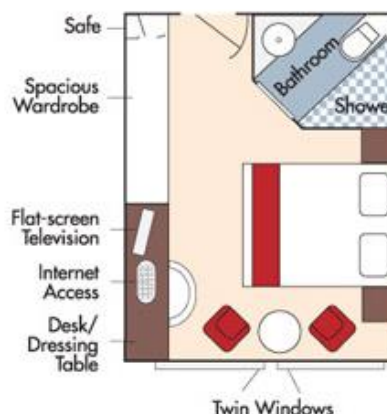

Category E *Piano Deck*

Fixed Windows, 160 sq. ft.

Wine Cruise Rate: \$4,199 pp

AmaKristina DECK PLAN

1	Lower Sun Deck
2	Navigation Bridge
3	Bicycles
4	Heated Pool
5	Sun Deck
6	Walking Track
7	Al Fresco Terrace
8	Observation Lounge
9	Main Lounge & Bar
10	Gift Shop
11	Reception
12	The Chef's Table Restaurant
13	Main Restaurant
14	Elevator
15	Massage & Hair Salon
16	Fitness Room
17	Crew Cabins



Note: Elevator reaches the Violin, Cello and Piano Deck (does not reach the Sun Deck).

Staterooms can become adjoining by request.

Up to triple occupancy

Stateroom Categories

SUITE	AA	AB	BA	BB	CA	CB	D	E
-------	----	----	----	----	----	----	---	---

Fares listed are cruise-only, per person based on double occupancy and include the exclusive wine package. Port charges of \$210 per person are additional.