

# EXPLORE EUROPE'S RIVERS AND CASTLES WITH PAUL WAGNER AND DR. KONSTANTIN FRANK WINERY

## American Wine Society

Aboard AmaPrima • 7 Nights • April 11 to 18, 2023

Nuremberg to Luxembourg



**Special Rates when you  
book by June 30, 2022!**

*Note: Stateroom layouts shown below are not to scale.*



**Suite, Violin Deck**  
French Balcony & Outside Balcony, 300 sq. ft.

Brochure Fare \$6,898 pp  
Your rate \$6,648 pp

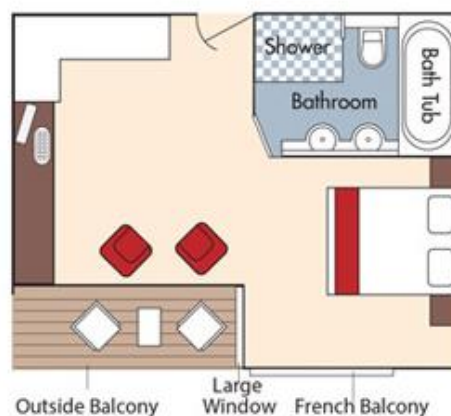

**CAT. AA, Violin Deck**  
French Balcony & Outside Balcony, 235 sq. ft.

Brochure Fare \$5,598 pp  
Your rate \$5,348 pp

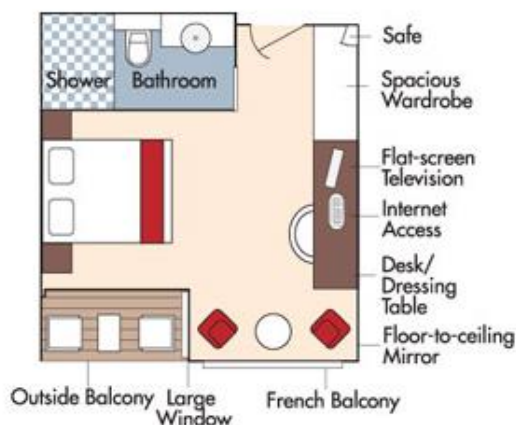

*Fares listed are cruise-only, per person based on double occupancy and do not include port charges of \$210 per person.*



**CAT. AB, Cello Deck**  
**French Balcony & Outside Balcony, 235 sq. ft.**

Brochure Fare \$5,398 pp  
 Your rate \$5,148 pp

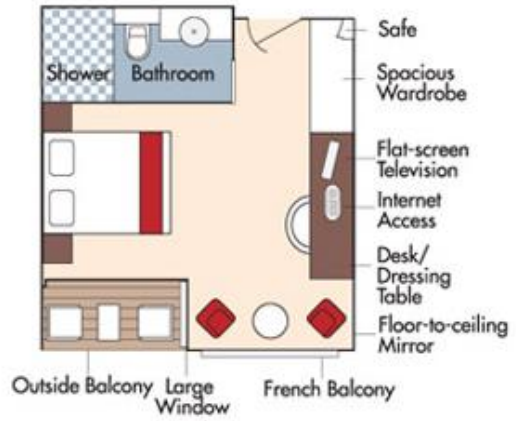

**CAT. BA, Violin Deck**  
**French Balcony & Outside Balcony, 210 sq. ft.**

Brochure Fare \$5,198 pp  
 Your rate \$4,948 pp

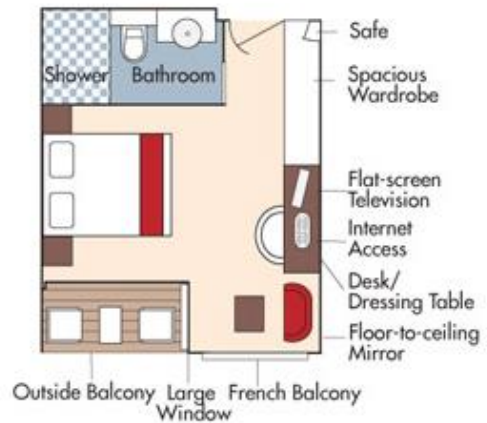



**CAT. BB, Cello Deck**  
**French Balcony & Outside Balcony, 210 sq. ft.**

Brochure Fare ~~\$4,998~~ pp  
 Your rate \$4,748 pp

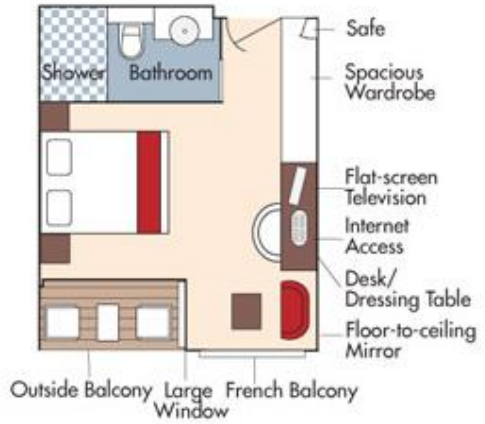

**CAT. C, Violin & Cello Deck**  
**French Balcony, 170 sq. ft.**

Category C  
 Brochure Fare ~~\$4,398~~ pp  
 Your rate \$4,148 pp

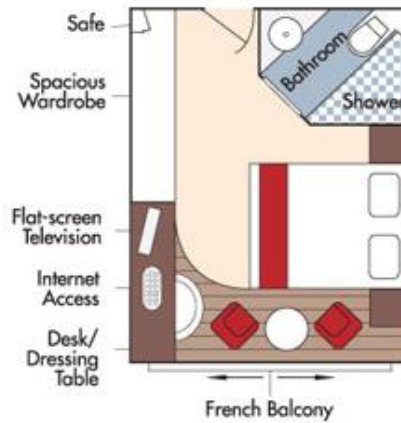



**CAT. D, Piano Deck**  
Fixed Windows, 160 sq. ft.

Brochure Fare ~~\$3,598~~ pp  
Your rate **\$3,348** pp

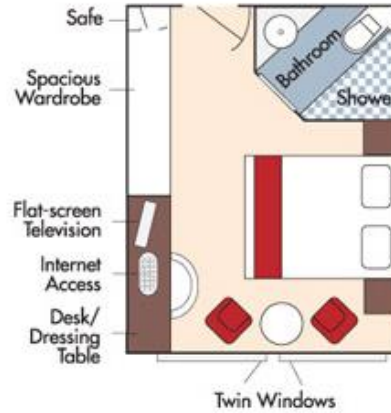

**CAT. E, Piano Deck**  
Fixed Windows, 160 sq. ft.

Brochure Fare ~~\$3,299~~ pp  
Your rate **\$3,049** pp

## AmaPrima DECK PLAN

1	Lower Sun Deck
2	Navigation Bridge
3	Bicycles
4	Heated Pool
5	Sun Deck
6	Walking Track
7	Al Fresco Dining Terrace
8	Observation Lounge
9	Main Lounge & Bar
10	Gift Shop
11	Reception
12	Fitness Room
13	Massage & Hair Salon
14	The Chef's Table Restaurant
15	Main Restaurant
16	Elevator
17	Crew Cabins

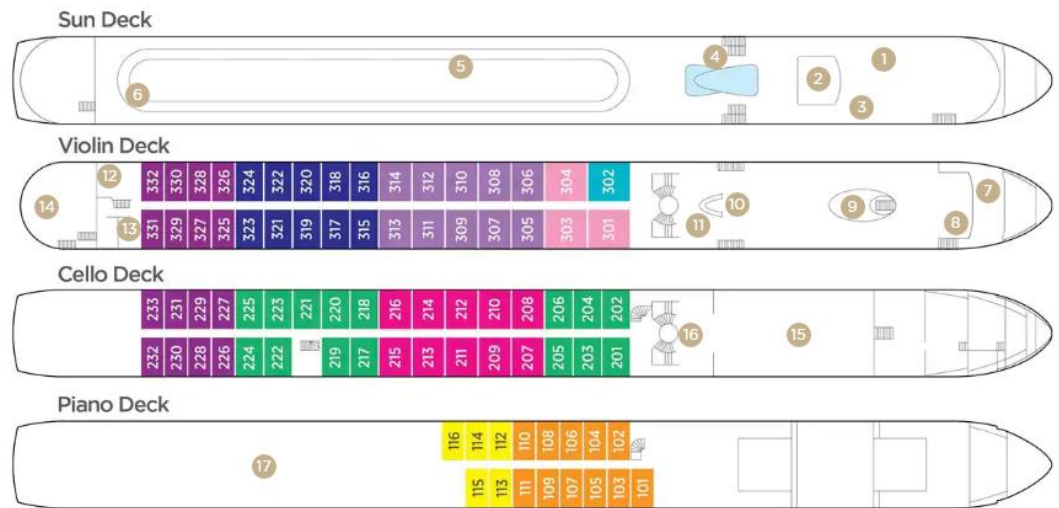

Note: Elevator reaches the Violin and Cello Deck (does not reach Piano Deck or Sun Deck).

### Stateroom Categories

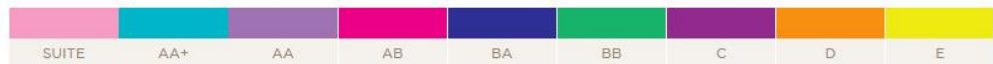

Fares listed are cruise-only, per person based on double occupancy and do not include port charges of \$210 per person.