

Grand France Wine Cruise

14-Night Segment

**Special Rates when you
book by July 31, 2022!**

Suite, Violin Deck
French Balcony, 255 sq. ft.

Note: Stateroom layouts shown below are not to scale.

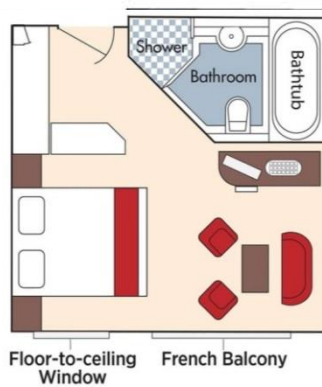

Brochure Fare: ~~\$15,596~~ pp
Your Rate: **\$15,096** pp

CAT. A+, Violin Deck
French Balcony, 225 sq. ft.

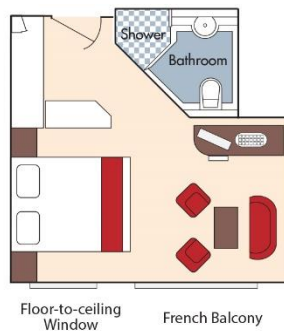

Brochure Fare: ~~\$15,296~~ pp
Your Rate: **\$14,796** pp

CAT. A, Violin Deck
French Balcony, 170 sq. ft.

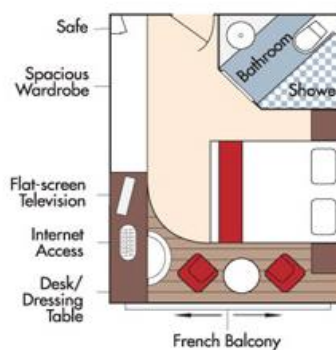

Brochure Fare: ~~\$12,996~~ pp
Your Rate: **\$12,496** pp

Fares listed are cruise-only, per person based on double occupancy and do not include port charges of \$420 per person. Stateroom photos above show typical décor for each stateroom category; actual décor may vary between ships.

CAT. B, Violin & Cello Deck
French Balcony, 170 sq. ft.

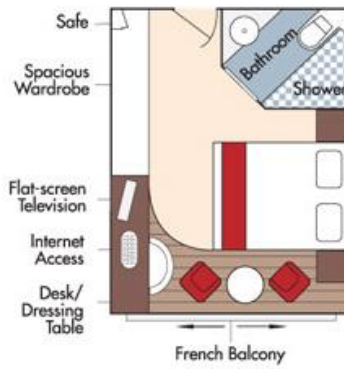

Brochure Fare: ~~\$12,796~~ pp
Your Rate: \$12,296 pp

CAT. C, Violin & Cello Deck
French Balcony, 170 sq. ft.

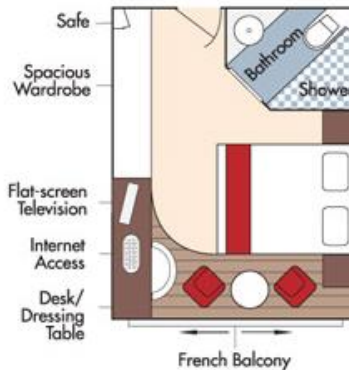

Brochure Fare: ~~\$12,196~~ pp
Your Rate: \$11,696 pp

CAT. E, Piano Deck
Fixed Windows, 170 sq. ft.

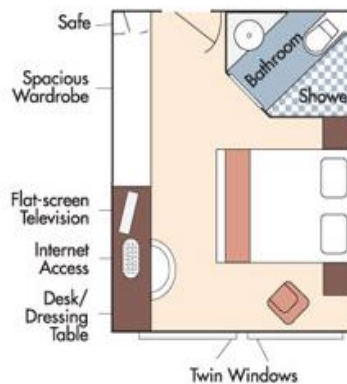

Category D
Brochure Fare: ~~\$10,096~~ pp
Your Rate: \$9,596 pp

Category E
Brochure Fare: ~~\$9,498~~ pp
Your Rate: \$8,998 pp

Typical Deck Plan: AmaDolce, AmaLyra, AmaCello



Stateroom Categories



Fares listed are cruise-only, per person based on double occupancy and do not include port charges of \$420 per person. Stateroom photos above show typical décor for each stateroom category; actual décor may vary between ships.