

Grand France Wine Cruise

21-Night Segment

**Special Rates when you
book by July 31, 2022!**

Suite, Violin Deck
French Balcony, 255 sq. ft.

Note: Stateroom layouts shown below are not to scale.

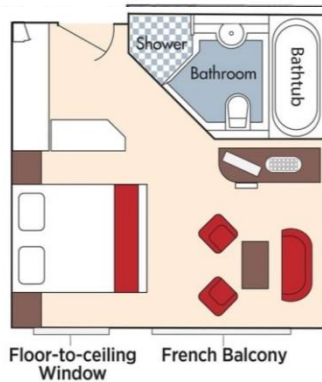

Brochure Fare: ~~\$23,394~~ pp
Your Rate: **\$22,644 pp**

CAT. A+, Violin Deck
French Balcony, 225 sq. ft.

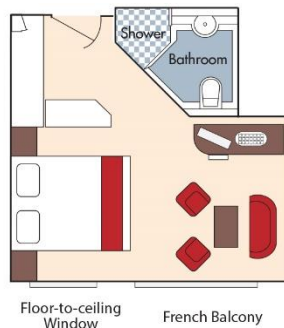

Brochure Fare: ~~\$22,944~~ pp
Your Rate: **\$22,194 pp**

CAT. A, Violin Deck
French Balcony, 170 sq. ft.

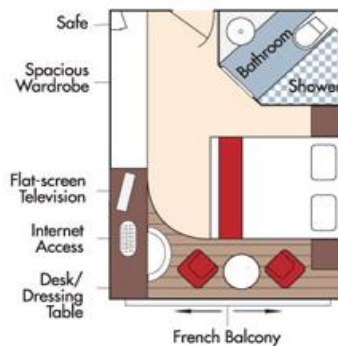

Brochure Fare: ~~\$19,494~~ pp
Your Rate: **\$18,744 pp**

Fares listed are cruise-only, per person based on double occupancy and do not include port charges of \$630 per person. Stateroom photos above show typical décor for each stateroom category; actual décor may vary between ships.

CAT. B, Violin & Cello Deck
French Balcony, 170 sq. ft.

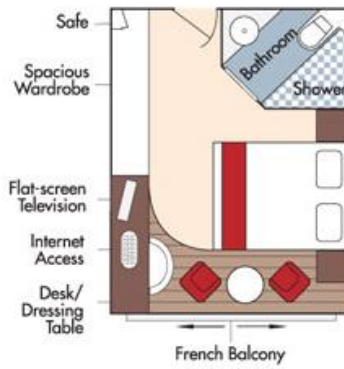

Brochure Fare: ~~\$19,194~~ pp
Your Rate: \$18,444 pp

CAT. C, Violin & Cello Deck
French Balcony, 170 sq. ft.

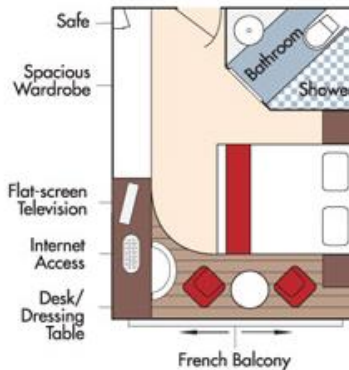

Brochure Fare: ~~\$18,294~~ pp
Your Rate: \$17,544 pp

CAT. E, Piano Deck
Fixed Windows, 170 sq. ft.

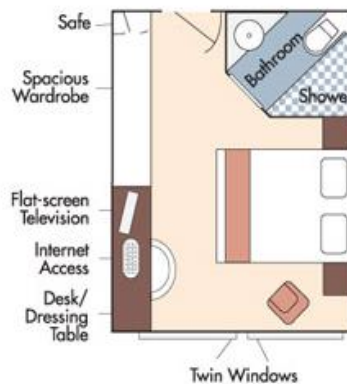

Category D
Brochure Fare: ~~\$15,144~~ pp
Your Rate: \$14,394 pp

Category E
Brochure Fare: ~~\$14,247~~ pp
Your Rate: \$13,497 pp

Typical Deck Plan: AmaDolce, AmaLyra, AmaCello



Stateroom Categories



Fares listed are cruise-only, per person based on double occupancy and do not include port charges of \$630 per person. Stateroom photos above show typical décor for each stateroom category; actual décor may vary between ships.