

Grand France Wine Cruise

28 Nights • Departing April 20, 2023

**Special Rates when you
book by July 31, 2022!**

Suite, Violin Deck
French Balcony, 255 sq. ft.

Note: Stateroom layouts shown below are not to scale.

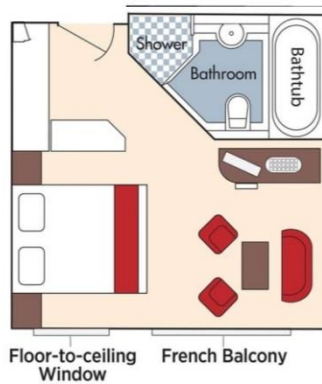

Brochure Fare: ~~\$31,192~~ pp
Your Rate: **\$30,192 pp**

CAT. A+, Violin Deck
French Balcony, 225 sq. ft.

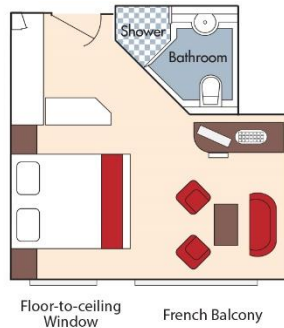

Brochure Fare: ~~\$30,592~~ pp
Your Rate: **\$29,592 pp**

CAT. A, Violin Deck
French Balcony, 170 sq. ft.

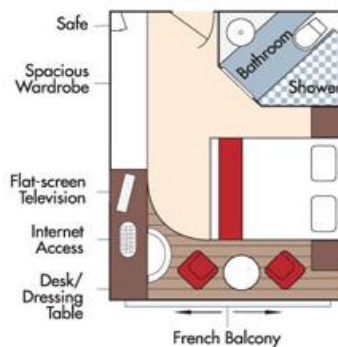

Brochure Fare: ~~\$25,992~~ pp
Your Rate: **\$24,992 pp**

Fares listed are cruise-only, per person based on double occupancy and do not include port charges of \$840 per person. Stateroom photos above show typical décor for each stateroom category; actual décor may vary between ships.

CAT. B, Violin & Cello Deck
French Balcony, 170 sq. ft.

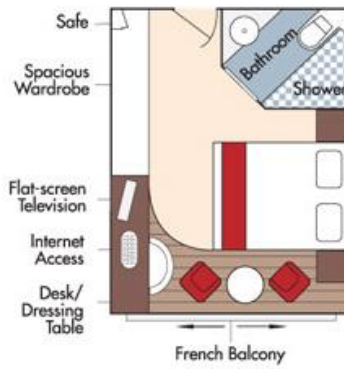

Brochure Fare: ~~\$25,592~~ pp
Your Rate: \$24,592 pp

CAT. C, Violin & Cello Deck
French Balcony, 170 sq. ft.

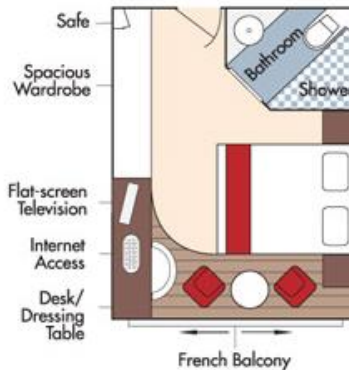

Brochure Fare: ~~\$24,392~~ pp
Your Rate: \$23,392 pp

CAT. E, Piano Deck
Fixed Windows, 170 sq. ft.

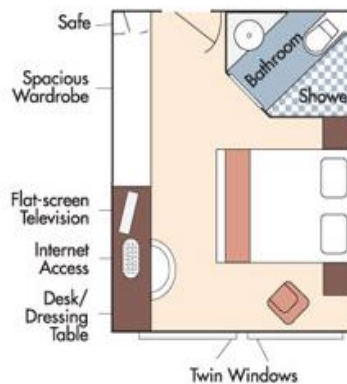

CAT. D, Piano Deck
Fixed Windows, 170 sq. ft.

Category D
Brochure Fare: ~~\$20,192~~ pp
Your Rate: \$19,192 pp

Category E
Brochure Fare: ~~\$18,996~~ pp
Your Rate: \$17,996 pp

Typical Deck Plan: AmaDolce, AmaLyra, AmaCello



Stateroom Categories



Fares listed are cruise-only, per person based on double occupancy and do not include port charges of \$840 per person. Stateroom photos above show typical décor for each stateroom category; actual décor may vary between ships.