

Grand France Wine Cruise

7-Night Segment

Special Rates when you
book by July 31, 2022!

Suite, Violin Deck
French Balcony, 255 sq. ft.

Note: Stateroom layouts shown below are not to scale.



Brochure Fare: ~~\$7,798~~ pp
Your Rate: \$7,548 pp

CAT. A+, Violin Deck
French Balcony, 225 sq. ft.

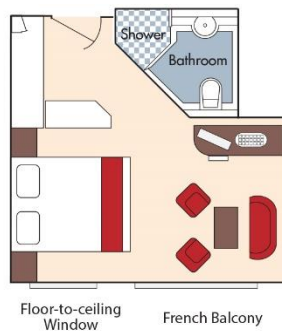

Brochure Fare: ~~\$7,648~~ pp
Your Rate: \$7,398 pp

CAT. A, Violin Deck
French Balcony, 170 sq. ft.

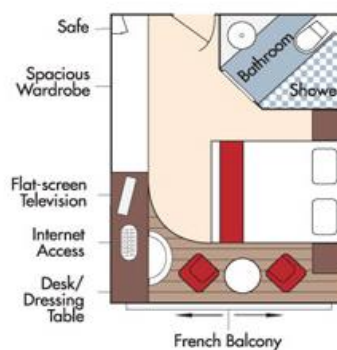

Brochure Fare: ~~\$6,498~~ pp
Your Rate: \$6,248 pp

Fares listed are cruise-only, per person based on double occupancy and do not include port charges of \$210 per person. Stateroom photos above show typical décor for each stateroom category; actual décor may vary between ships.

CAT. B, Violin & Cello Deck
French Balcony, 170 sq. ft.

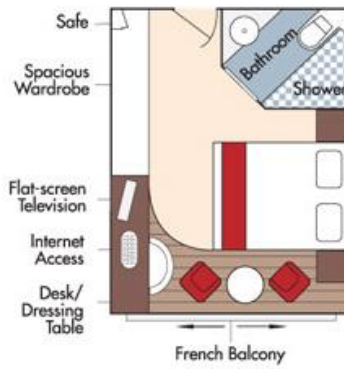

Brochure Fare: ~~\$6,398~~ pp
Your Rate: \$6,148 pp

CAT. C, Violin & Cello Deck
French Balcony, 170 sq. ft.

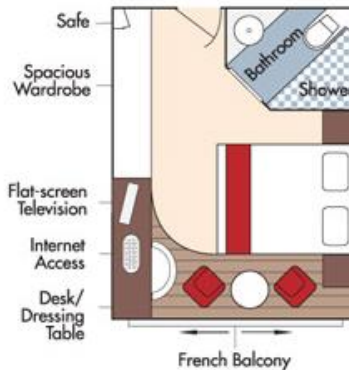

Brochure Fare: ~~\$6,098~~ pp
Your Rate: \$5,848 pp

CAT. E, Piano Deck
Fixed Windows, 170 sq. ft.

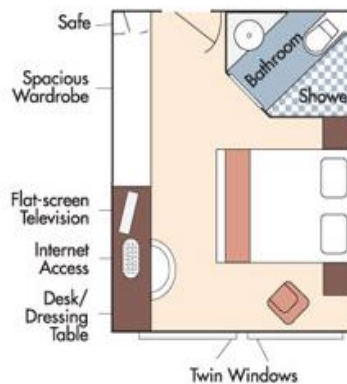

CAT. D, Piano Deck
Fixed Windows, 170 sq. ft.

Category D
Brochure Fare: ~~\$5,048~~ pp
Your Rate: \$4,798 pp

Category E
Brochure Fare: ~~\$4,749~~ pp
Your Rate: \$4,499 pp

Typical Deck Plan: AmaDolce, AmaLyra, AmaCello



Stateroom Categories



Fares listed are cruise-only, per person based on double occupancy and do not include port charges of \$210 per person. Stateroom photos above show typical décor for each stateroom category; actual décor may vary between ships.