

# EXCLUSIVE 7-DAY BORDEAUX WINE CRUISE!

AMADOLCE APRIL 20-27, 2023

**Special Rates when you  
book by July 31, 2022!**

**Suite, Violin Deck**  
French Balcony, 255 sq. ft.

*Note: Stateroom layouts shown below are not to scale.*

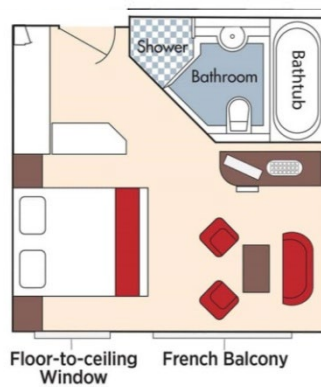

Brochure Fare: ~~\$7,798~~ pp  
Your Rate: \$7,548 pp

**CAT. A+, Violin Deck**  
French Balcony, 225 sq. ft.

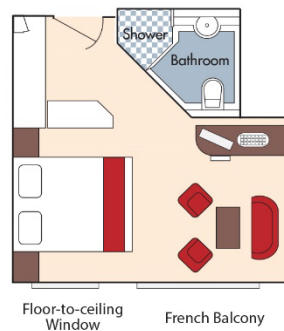

Brochure Fare: ~~\$7,648~~ pp  
Your Rate: \$7,398 pp

**CAT. A, Violin Deck**  
French Balcony, 170 sq. ft.

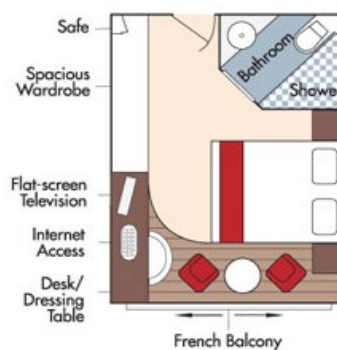

Brochure Fare: ~~\$6,498~~ pp  
Your Rate: \$6,248 pp

*Fares listed are cruise-only, per person based on double occupancy and do not include port charges of \$210 per person. Stateroom photos above show typical décor for each stateroom category; actual décor may vary.*

**CAT. B, Violin & Cello Deck**  
French Balcony, 170 sq. ft.

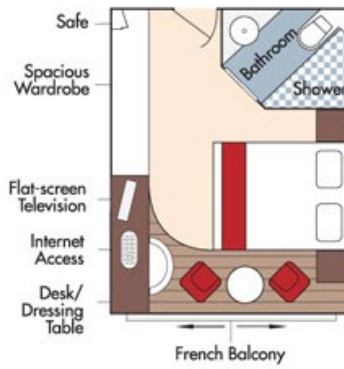

Brochure Fare: ~~\$6,398~~ pp  
Your Rate: **\$6,148 pp**

**CAT. C, Violin & Cello Deck**  
French Balcony, 170 sq. ft.

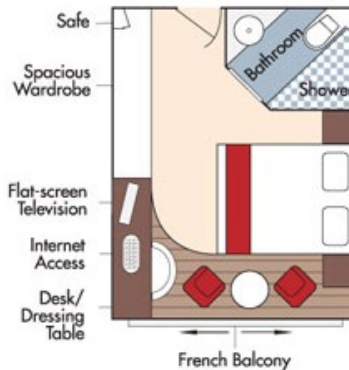

Brochure Fare: ~~\$6,098~~ pp  
Your Rate: **\$5,848 pp**

**CAT. E, Piano Deck**  
Fixed Windows, 170 sq. ft.



**CAT. D, Piano Deck**  
Fixed Windows, 170 sq. ft.

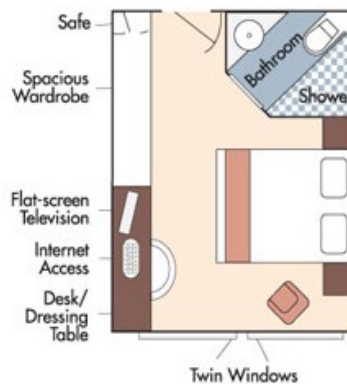

Category D  
Brochure Fare: ~~\$5,048~~ pp  
Your Rate: **\$4,798 pp**

Category E  
Brochure Fare: ~~\$4,749~~ pp  
Your Rate: **\$4,499 pp**

## AmaDolce Deck Plan

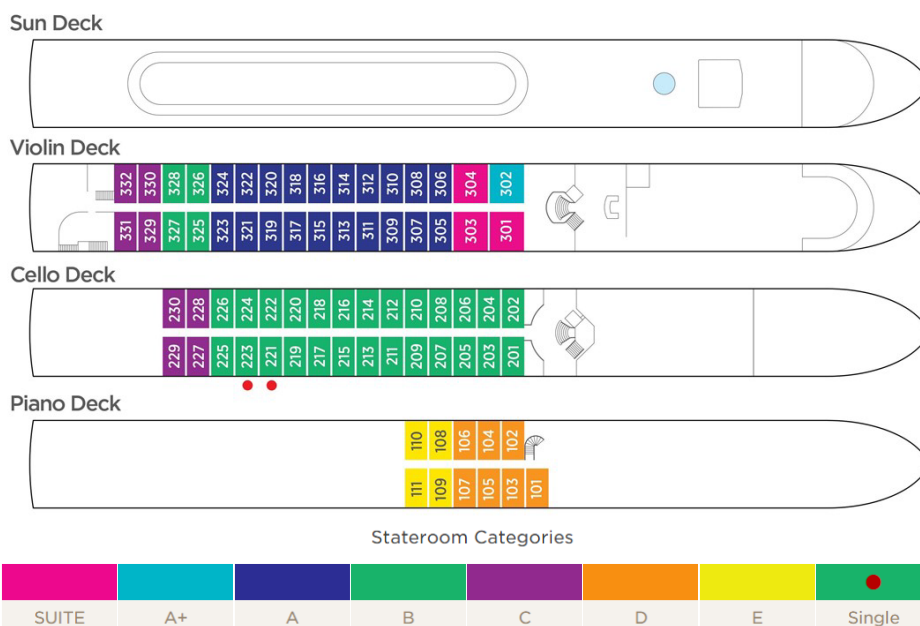

Fares listed are cruise-only, per person based on double occupancy and do not include port charges of \$210 per person. Stateroom photos above show typical décor for each stateroom category; actual décor may vary.