

EXPLORE EUROPE'S RIVERS AND CASTLES WITH PAUL WAGNER AND DR. KONSTANTIN FRANK WINERY

American Wine Society

Aboard AmaPrima • 7 Nights • April 11 to 18, 2023

Nuremberg to Luxembourg



Note: Stateroom layouts shown below are not to scale.



Suite, Violin Deck
French Balcony & Outside Balcony, 300 sq. ft.

Wine Cruise Rate: \$6,898 pp

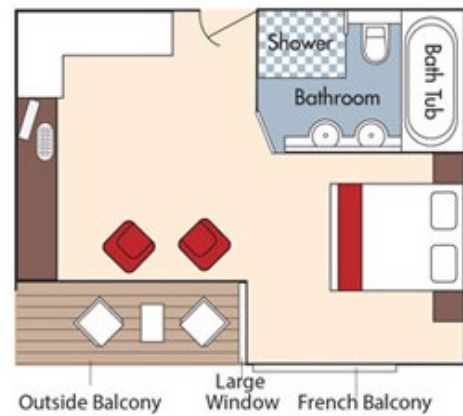

CAT. AA, Violin Deck
French Balcony & Outside Balcony, 235 sq. ft.

Wine Cruise Rate: \$5,598 pp

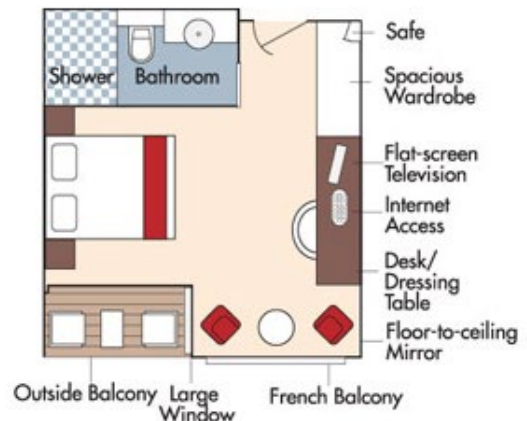

Fares listed are cruise-only, per person based on double occupancy and do not include port charges of \$210 per person.



CAT. AB, Cello Deck
French Balcony & Outside Balcony, 235 sq. ft.

Wine Cruise Rate: \$5,398 pp

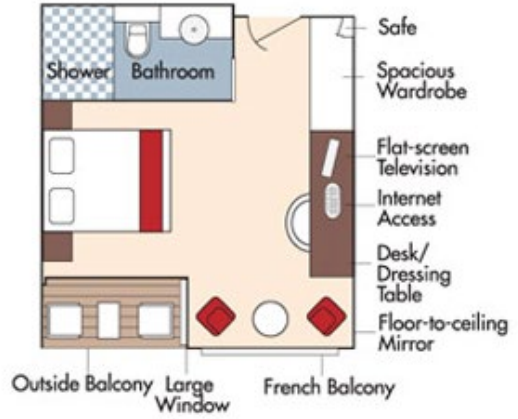

CAT. BA, Violin Deck
French Balcony & Outside Balcony, 210 sq. ft.

Wine Cruise Rate: \$5,198 pp

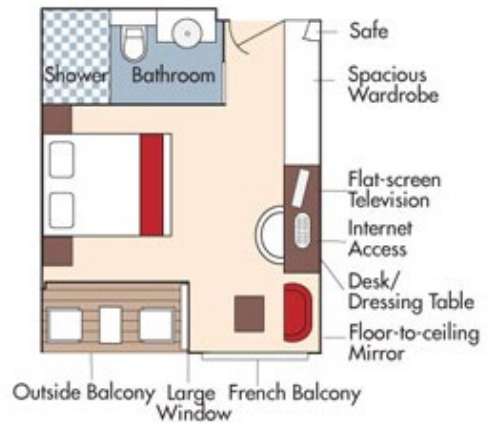



CAT. BB, Cello Deck
French Balcony & Outside Balcony, 210 sq. ft.

Wine Cruise Rate: \$4,998 pp

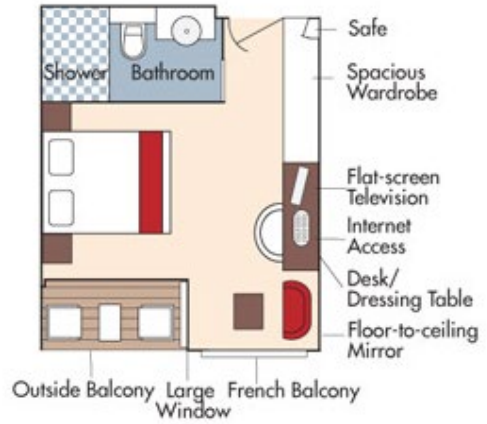

CAT. C, Violin & Cello Deck
French Balcony, 170 sq. ft.

Wine Cruise Rate: \$4,398 pp

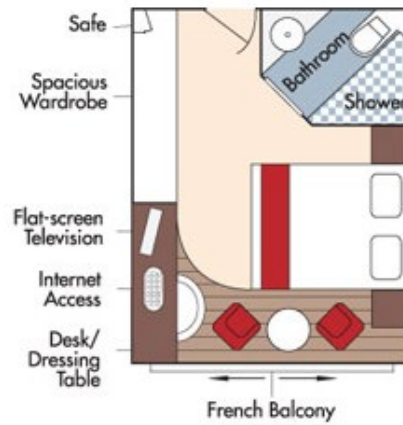



CAT. D, Piano Deck
Fixed Windows, 160 sq. ft.

Wine Cruise Rate: \$3,598 pp

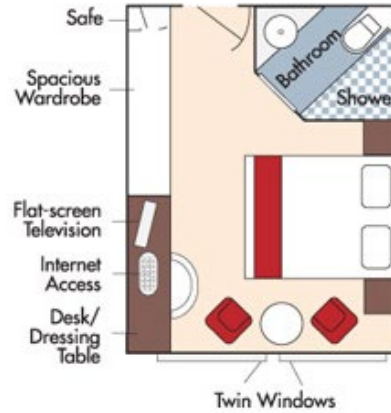

CAT. E, Piano Deck
Fixed Windows, 160 sq. ft.

Wine Cruise Rate: \$3,299 pp

AmaPrima DECK PLAN

- 1 Lower Sun Deck
- 2 Navigation Bridge
- 3 Bicycles
- 4 Heated Pool
- 5 Sun Deck
- 6 Walking Track
- 7 Al Fresco Dining Terrace
- 8 Observation Lounge
- 9 Main Lounge & Bar
- 10 Gift Shop
- 11 Reception
- 12 Fitness Room
- 13 Massage & Hair Salon
- 14 The Chef's Table Restaurant
- 15 Main Restaurant
- 16 Elevator
- 17 Crew Cabins

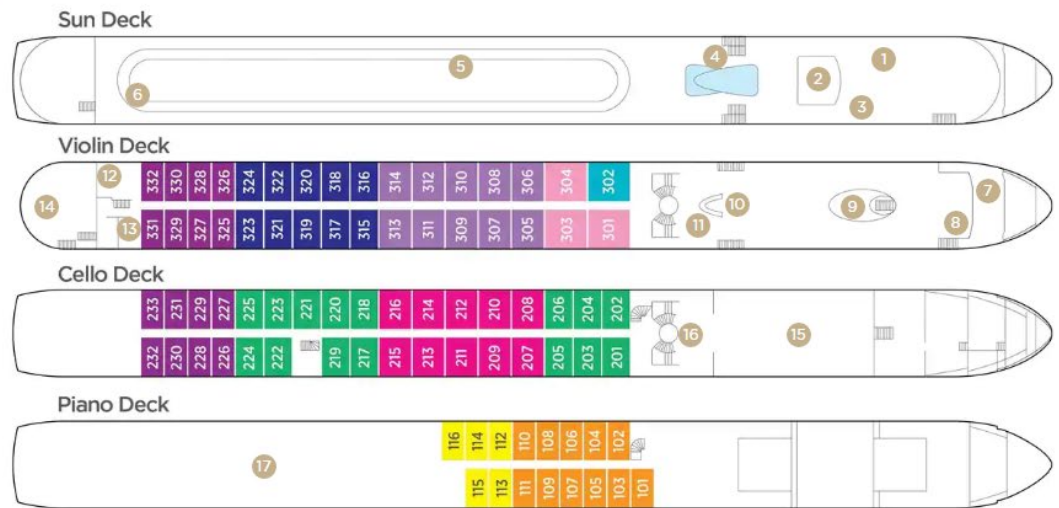

Note: Elevator reaches the Violin and Cello Deck (does not reach Piano Deck or Sun Deck).

Stateroom Categories

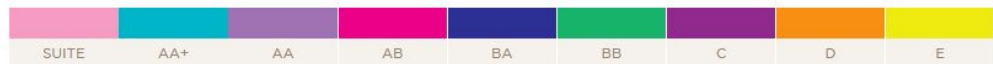

Fares listed are cruise-only, per person based on double occupancy and do not include port charges of \$210 per person.