

Grand France Wine Cruise

28 Nights • Departing April 20, 2023

Suite, Violin Deck
French Balcony, 255 sq. ft.

Note: Stateroom layouts shown below are not to scale.

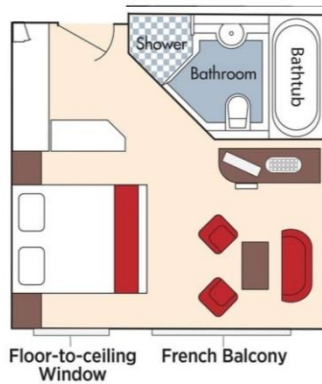

Wine Cruise Fare: \$31,192 pp

CAT. A+, Violin Deck
French Balcony, 225 sq. ft.

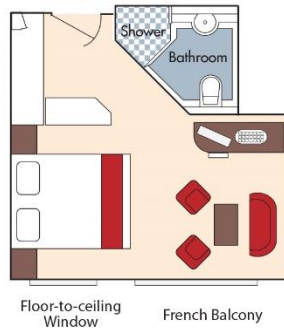

Wine Cruise Fare: \$30,592 pp

CAT. A, Violin Deck
French Balcony, 170 sq. ft.

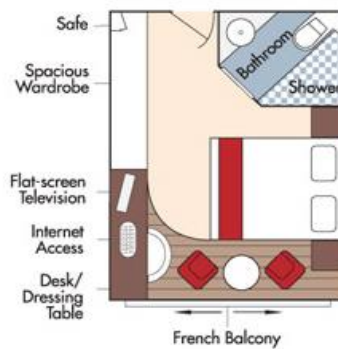

Wine Cruise Fare: \$25,992 pp

Fares listed are cruise-only, per person based on double occupancy and do not include port charges of \$840 per person. Stateroom photos above show typical décor for each stateroom category; actual décor may vary between ships.

CAT. B, Violin & Cello Deck
French Balcony, 170 sq. ft.

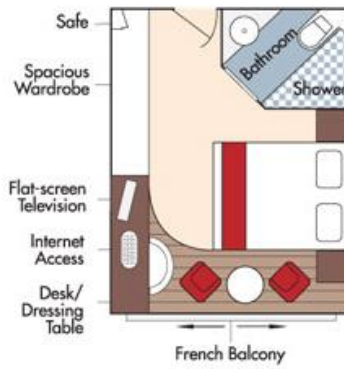

Wine Cruise Fare: \$25,592 pp

CAT. C, Violin & Cello Deck
French Balcony, 170 sq. ft.

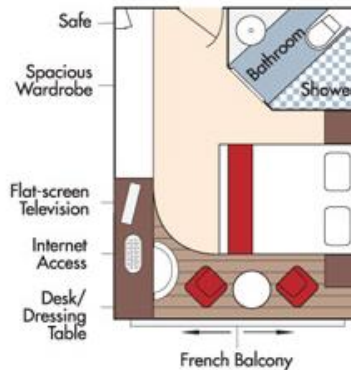

Wine Cruise Fare: \$24,392 pp

CAT. E, Piano Deck
Fixed Windows, 170 sq. ft.



CAT. D, Piano Deck
Fixed Windows, 170 sq. ft.

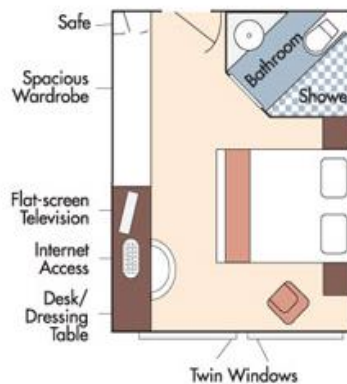

Category D
Wine Cruise Fare: \$20,192 pp

Category E
Wine Cruise Fare: \$18,996 pp

Typical Deck Plan: AmaDolce, AmaLyra, AmaCello



Stateroom Categories



Fares listed are cruise-only, per person based on double occupancy and do not include port charges of \$840 per person. Stateroom photos above show typical décor for each stateroom category; actual décor may vary between ships.