



Special Rates when you *book by*
January 31, 2023

RIVER CRUISE FOR WINE LOVERS

Sbragia Winery

Aboard AmaSiena • 7 Nights • March 30 to April 6, 2023

Amsterdam to Basel

Note: Stateroom layouts shown below are not to scale.

Suite *Violin Deck*

French Balcony & Outside Balcony, 350 sq. ft.

Brochure Fare \$6,698 pp

Your rate \$6,448 pp

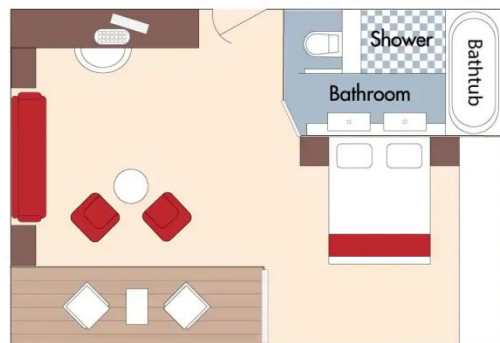

Outside Balcony Large Window French Balcony

Category AA *Violin Deck*

French Balcony & Outside Balcony, 235 sq. ft.

Brochure Fare \$5,398 pp

Your rate \$5,148 pp

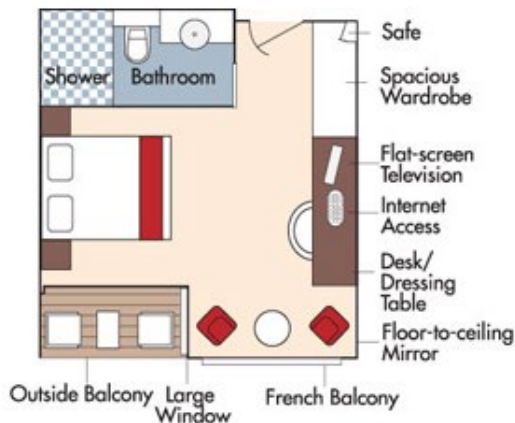

Outside Balcony Large Window French Balcony

Fares listed are cruise-only, per person based on double occupancy and do not include port charges of \$210 per person.



Category AB *Cello Deck*

French Balcony & Outside Balcony, 235 sq. ft.

Brochure Fare \$5,198 pp

Your rate \$4,948 pp

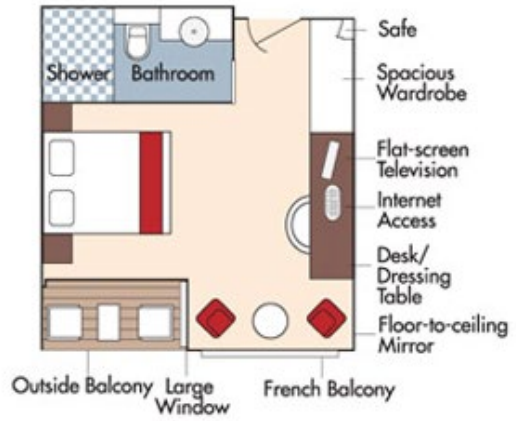

Category BA *Violin Deck*

French Balcony & Outside Balcony, 210 sq. ft.

Brochure Fare \$4,998 pp

Your rate \$4,748 pp

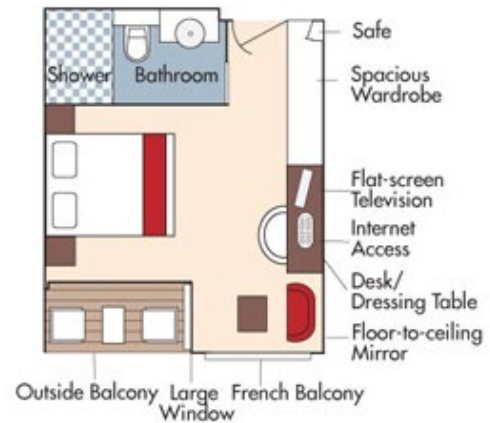



Category BB *Cello Deck*

French Balcony & Outside Balcony, 210 sq. ft.

Brochure Fare \$4,798 pp

Your rate \$4,548 pp

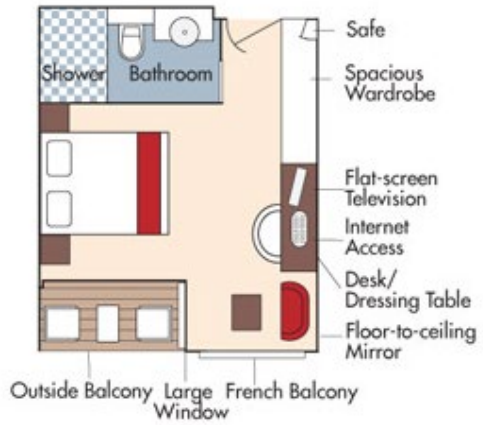

Category CA *Violin & Cello Deck*

French Balcony, 170 sq. ft.

Category CA

Brochure Fare \$4,198 pp

Your rate \$3,948 pp

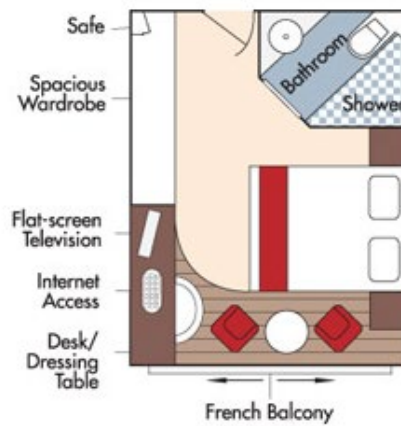

Category CB *Violin Deck*

French Balcony, 155 sq. ft.

Category CB

Brochure Fare \$3,898 pp

Your rate \$3,648 pp

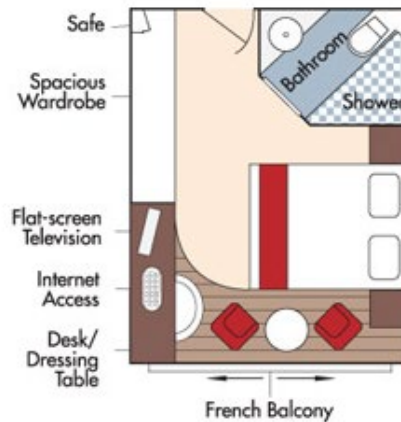

Fares listed are cruise-only, per person based on double occupancy and do not include port charges of \$210 per person.

Category D *Piano Deck*
Fixed Windows, 160 sq. ft.



Brochure Fare ~~\$3,398~~ pp
Your rate \$3,148 pp

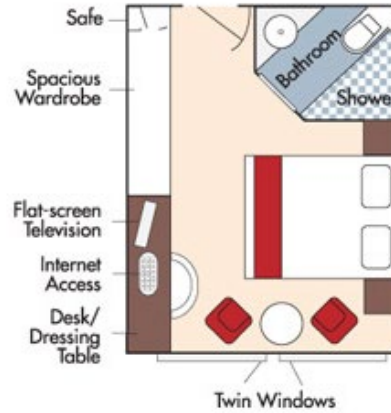

Category E *Piano Deck*
Fixed Windows, 160 sq. ft.

Brochure Fare ~~\$3,099~~ pp
Your rate \$2,849 pp

AmaSiena
DECK PLAN

- 1 Lower Sun Deck
- 2 Navigation Bridge
- 3 Bicycles
- 4 Heated Pool
- 5 Sun Deck
- 6 Walking Track
- 7 AI Fresco Terrace
- 8 Observation Lounge
- 9 Main Lounge & Bar
- 10 Gift Shop
- 11 Reception
- 12 The Chef's Table Restaurant
- 13 Main Restaurant
- 14 Elevator
- 15 Massage & Hair Salon
- 16 Fitness Room
- 17 Crew Cabins

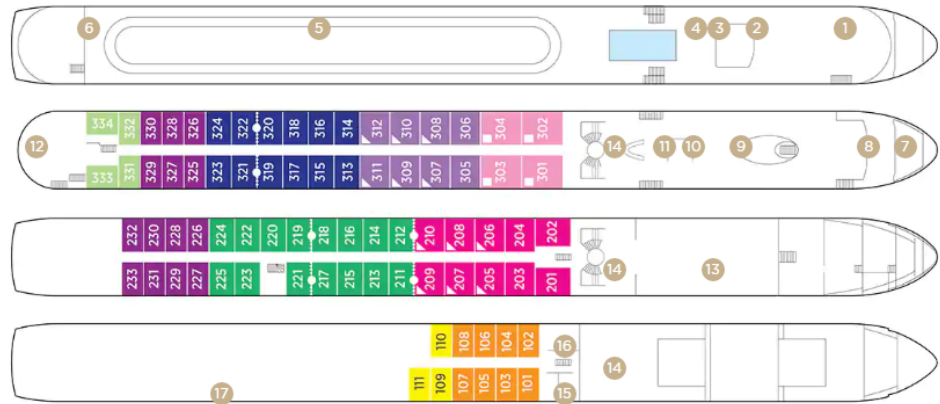

Note: Elevator reaches the Violin, Cello and Piano Deck (does not reach the Sun Deck).

.....
Staterooms can become adjoining by request.

▲
Up to triple occupancy

Stateroom Categories

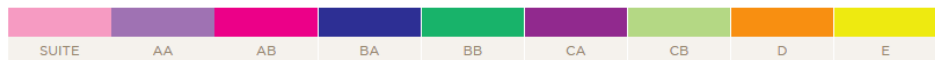

Fares listed are cruise-only, per person based on double occupancy and do not include port charges of \$210 per person.