



**Special Rates when you book  
by March 31, 2023**

# RIVER CRUISE FOR WINE LOVERS

## Gary Farrell Vineyards & Winery

Aboard AmaViola • 7 Nights • April 1 to 8, 2023

Budapest to Vilshofen

*Note: Stateroom layouts shown below are not to scale.*



**Suite, Violin Deck**  
French Balcony & Outside Balcony, 350 sq. ft.

Brochure Fare \$6,798 pp  
Your rate \$6,548 pp

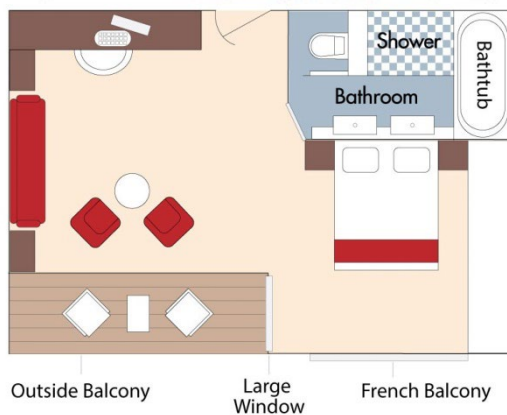

**CAT. AA, Violin Deck**  
French Balcony & Outside Balcony, 235 sq. ft.

Brochure Fare \$5,498 pp  
Your rate \$5,248 pp

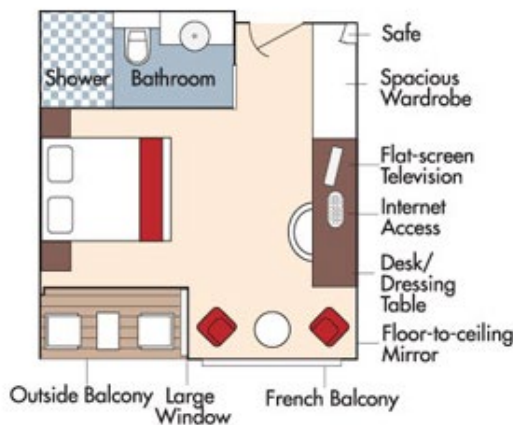

Fares listed are cruise-only, per person based on double occupancy and do not include port charges of \$210 per person.



**CAT. AB, Cello Deck**  
**French Balcony & Outside Balcony, 235 sq. ft.**

Brochure Fare \$5,298 pp  
 Your rate \$5,048 pp

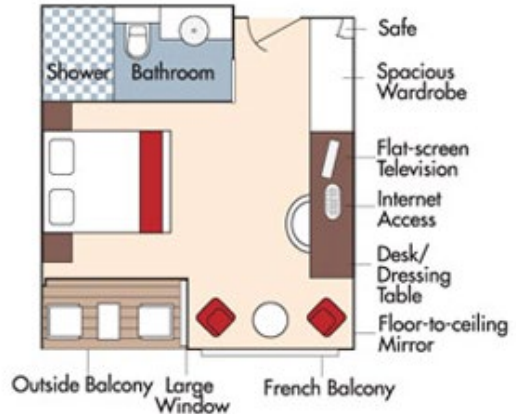

**CAT. BA, Violin Deck**  
**French Balcony & Outside Balcony, 210 sq. ft.**

Brochure Fare \$5,098 pp  
 Your rate \$4,848 pp

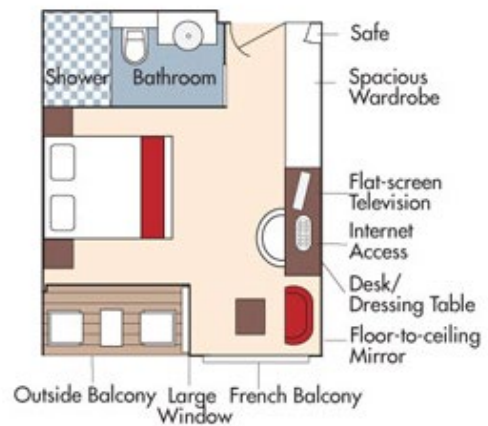



**CAT. BB, Cello Deck**  
**French Balcony & Outside Balcony, 210 sq. ft.**

Brochure Fare ~~\$4,898~~ pp  
 Your rate **\$4,648** pp

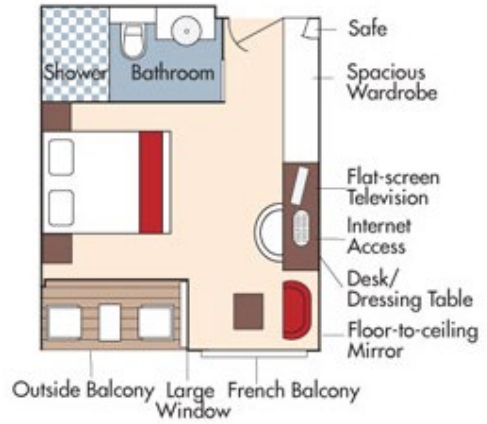

**CAT. C, Violin & Cello Deck**  
**French Balcony, 170 sq. ft.**

Category CA  
 Brochure Fare ~~\$4,298~~ pp  
 Your rate **\$4,048** pp

Category CB  
 Brochure Fare ~~\$3,998~~ pp  
 Your rate **\$3,748** pp

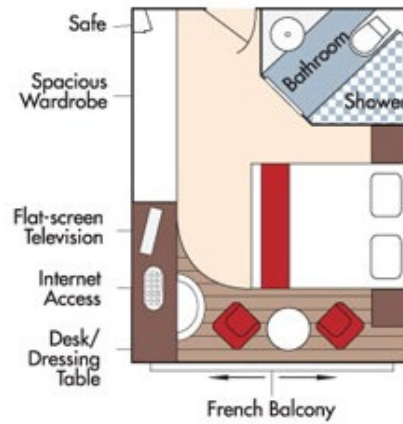





**CAT. D, Piano Deck**  
Fixed Windows, 160 sq. ft.

Brochure Fare \$3,498 pp  
Your rate \$3,248 pp

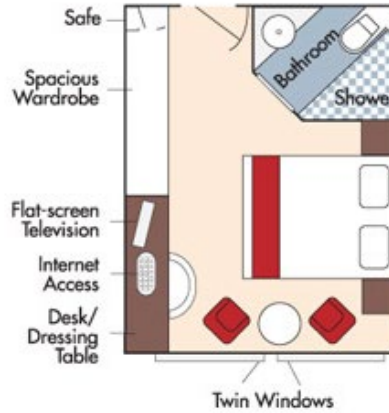

**CAT. E, Piano Deck**  
Fixed Windows, 160 sq. ft.

Brochure Fare \$3,199 pp  
Your rate \$2,949 pp

### AmaViola Deck Plan

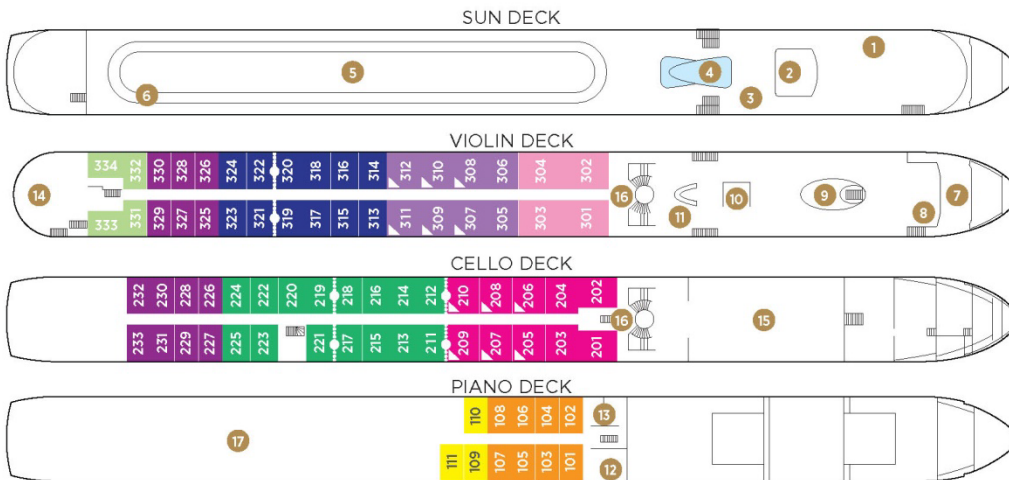

- 1 Lower Sun Deck
- 2 Navigation Bridge
- 3 Bicycles
- 4 Heated Pool
- 5 Sun Deck
- 6 Walking Track
- 7 AI Fresco Dining Terrace
- 8 Observation Lounge
- 9 Main Lounge & Bar
- 10 Gift Shop
- 11 Reception
- 12 Fitness Room
- 13 Massage & Hair Salon
- 14 The Chef's Table Restaurant
- 15 Main Restaurant
- 16 Elevator
- 17 Crew Cabins

Elevator on AmaLea and AmaKristina reaches Main Restaurant, Lobby/Main Lounge and staterooms on Violin, Cello and Piano Deck.  
Elevator on AmaStella and AmaViola reaches Main Restaurant, Lobby/Main Lounge and staterooms on Violin and Cello Deck.

Suite	Violin Deck / French & Outside Balcony - 350 sq. ft.	Cat. CA	Violin & Cello Deck / French Balcony - 170 sq. ft.
Cat. AA	Violin Deck / French & Outside Balcony - 235 sq. ft.	Cat. CB	Violin Deck / French Balcony - 155 sq. ft.
Cat. AB	Cello Deck / French & Outside Balcony - 235 sq. ft.	Cat. D	Piano Deck / Fixed Windows - 160 sq. ft.
Cat. BA	Violin Deck / French & Outside Balcony - 210 sq. ft.	Cat. E	Piano Deck / Fixed Windows - 160 sq. ft.
Cat. BB	Cello Deck / French & Outside Balcony - 210 sq. ft.		

..... Staterooms can become adjoining by request.    ▲ Up to triple occupancy.

Fares listed are cruise-only, per person based on double occupancy and do not include port charges of \$210 per person.